

IEM-945GSE

ETX 3.0 CPU Module with Intel® Atom™ processor, VGA/LVDS, LAN, SATA, USB and Audio

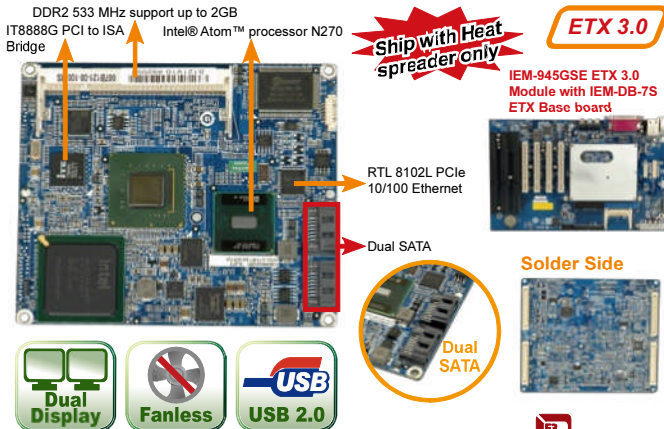

Features

1. ETX 3.0 CPU module with on-board dual SATA-150 ports
2. Support four PCI, one ISA slot for expansion
3. Support dual display for VGA + LVDS
4. Support four USB 2.0, two SATA, one IDE interface
5. IEI One Key Recovery solution allows you to create rapid OS backup and recovery

Specifications

- ◆ CPU: Intel® Atom™ Processor N270 1.6 GHz with 533 MHz FSB
- ◆ System Chipset: Intel® 945GSE + Intel® 82801GBM/ICH7M
- ◆ BIOS: AMI
- ◆ System Memory: One 200-pin 533/400MHz DDR2 SO-DIMM supported (system max. 2GB)
- ◆ Ethernet: One 10/100Mbps Realtek RTL8102E Ethernet chipset (PCIe interface)
- ◆ Super I/O: ITE IT8718
- ◆ I/O Interface:
 - 4 x USB 2.0 (to Base Board)
 - 2 x SATA (on CPU module)
 - 1 x IDE (to base board)
 - 1 x LPT (to base board)
 - 2 x RS-232 (to base board)
 - 1 x PS2 KB/MS (to base board)
- ◆ Expansions: 4 x PCI, 32 bit / 33 MHz PCI bus to base board ISA support by ITE IT8888G
- ◆ Display Interface: VGA/TV-Out Integrated in Intel® 945GSE signal (to base board)
- ◆ Watchdog Timer: Software programmable supports 1 ~255 sec. system reset
- ◆ Power Supply: AT / ATX supported
- ◆ Power Consumption: 5V@2.9A (Intel® Atom™ Processor N270 with 1GB DDR2)
- ◆ Temperature:
 - Operation: 0°C ~ 60°C (IEM-945GSE-N270-R10)
 - Operation: -40°C ~ 85°C (IEM-945GSE-N270W2-R10)
 - Operation: -20°C ~ 70°C (IEM-945GSE-N270W-R10)
- ◆ Humidity:
 - Operation: 5% ~95% non-condensing
 - Dimensions: 95 mm x 114 mm
 - Weight: GW: 600g / NW 250g

Dimensions (mm)

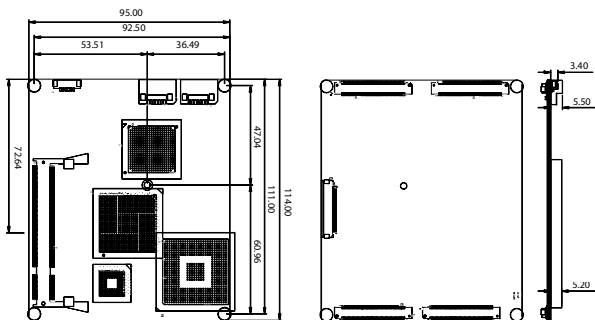

Packing List

1 x IEM-945GSE single board computer	1 x Heatspreader
1 x Utility CD	1 x QIG

Ordering Information

Part No.	Description
IEM-945GSE-N270-R10	ETX 3.0 module with Intel® Atom™ Processor N270 1.6G, VGA/LVDS, LAN, USB, SATA and audio
IEM-945GSE-N270W2-R10	ETX 3.0 module with Intel® Atom™ Processor N270 1.6G, VGA/LVDS, LAN, USB, SATA and audio, -40~85°C
IEM-945GSE-N270W-R10	ETX 3.0 module with Intel® Atom™ Processor N270 1.6G, VGA/LVDS, LAN, USB, SATA and audio, -20~70°C
IEM-DB-7S-RS-R30	ATX size 7 slots ETX baseboard
34000-000180-RS	Heatsink for ETX 3.0 module

IEM-9452

ETX CPU Module with Intel® Core™2 Duo L7400 or Celeron® M 423, VGA, LVDS, PCIe GbE, USB 2.0 and SATA

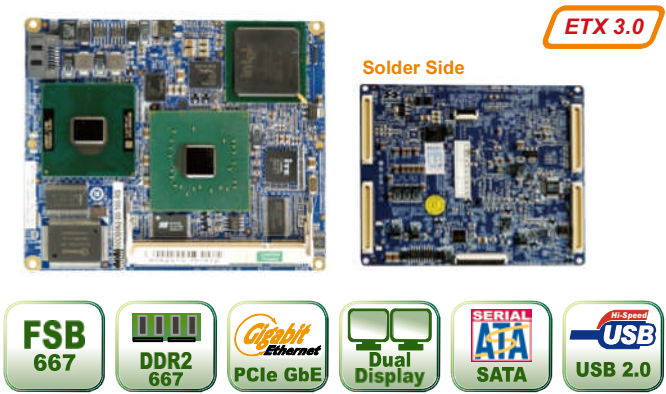

Features

1. Intel® Core™2 Duo CPU with 667 MHz FSB
2. Single channel DDR2 400/533/667 MHz up to 2GB
3. Support VGA, 18/24-bit dual-channel LVDS with dual display support
4. Two RS-232, four USB 2.0 and one SATA
5. IEI One Key Recovery solution allows you to create rapid OS backup and recovery

Specifications

- ◆ CPU: On board Intel® Core™2 Duo L7400 1.5GHz 4MB L2 cache processor with 667 MHz FSB
- ◆ System Chipset: Intel® 945GME + ICH7-M
- ◆ BIOS: AMI Flash BIOS
- ◆ System Memory: One 200-pin 667/533/400 MHz DDR2 SDRAM SO-DIMM supported (system max. 2GB)
- ◆ Ethernet: 10/100Mbps Intel® 82562ET Ethernet chipset
- ◆ I/O Interface:
 - 2 x RS-232
 - 4 x USB 2.0
 - 1 x IDE
 - 1 x LPT/FDD
 - 1 x KB/MS above I/O via IEM-DB-7S
 - 1 x SATA connector on board
- ◆ Expansions: 4 x PCI, 1 x ISA
- ◆ Digital I/O: 8-bit digital I/O, 4-bit input/ 4-bit output
- ◆ Infrared Interface: 1 x Infrared interface by pin header
- ◆ Super I/O: W83627HG
- ◆ Display Interface: VGA output Integrated in Intel® 945GME 18/24-bit Dual-channel LVDS
- ◆ Audio: Realtek ALC655 with AC'97 codec
- ◆ SSD: CF Type II
- ◆ Watchdog Timer: Software programmable supports 1 ~255 sec. system reset
- ◆ Power Supply: 5V only, AT/ATX Power
- ◆ Power Consumption: 5V@3.81A, 12V@2.42A (Intel® Core™2 Duo L7400 1.5GHz/667 MHz CPU with 512 MB DDR2 667 MHz)
- ◆ Temperature: Operating: 0°C ~ 60°C (32°F ~ 140°F)
- ◆ Humidity: Operating: 5% ~95% non-condensing
- ◆ Dimensions: 95 mm x 114 mm
- ◆ Weight: GW: 850 g / NW: 290 g

Dimensions (mm)

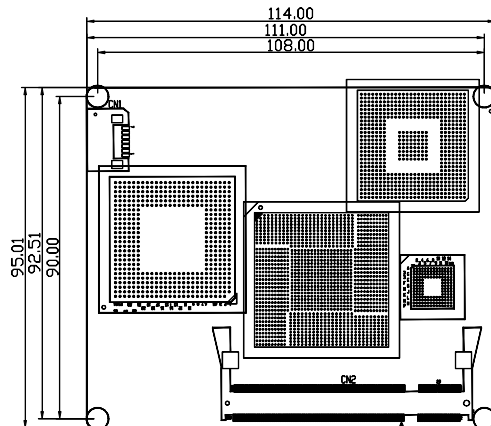

Packing List

1 x IEM-9452 single board computer	1 x Utility CD
1 x Heatspreader (P/N: 34000-000183-RS)	1 x QIG
1 x Cooler (P/N: 19100-000074-RS)	

Ordering Information

Part No.	Description
IEM-9452-L7400-R10	ETX CPU module with Intel® Core™2 Duo L7400, VGA, LVDS PCIe GbE, USB 2.0 and SATA

1 Industrial Computing Solutions

2 Video Capture Solutions

3 Embedded Computing Solutions

4 Industrial Data Collector and Controller

5 Panel Solutions Introduction

6 ORing Network Communication

7 Power Supply/ Peripherals