

Tension-Clamp Ultra-Slim Signal Conditioners M6S Series

BLANK FILLER MODULE

Functions & Features

- Used to fill blank slots on an installation base

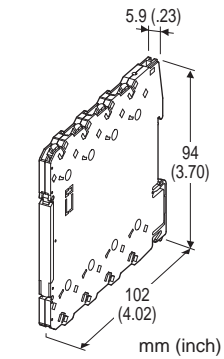

MODEL: M6SDM

ORDERING INFORMATION

- Code number: M6SDM

INSTALLATION

Mounting: Installation Base (model: M6SBS)

Weight: 60 g (2.1 oz)

DIMENSIONS unit: mm (inch)

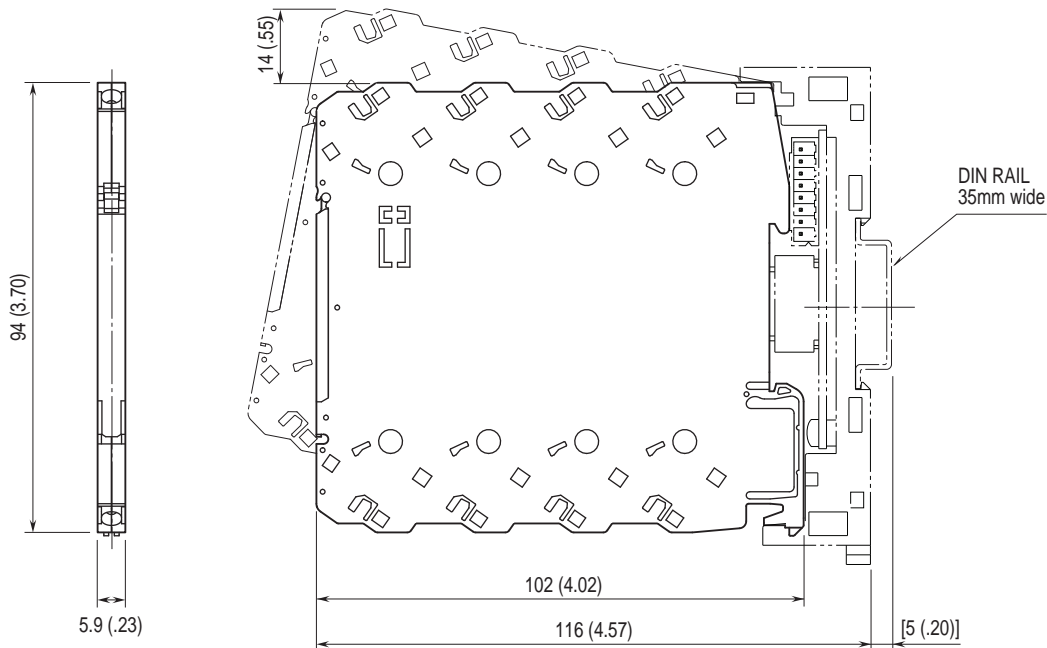

The terminals are Not to be used as relaying boards.



Specifications are subject to change without notice.