

9 Amps

AEH09R48N

High Efficiency Half Brick

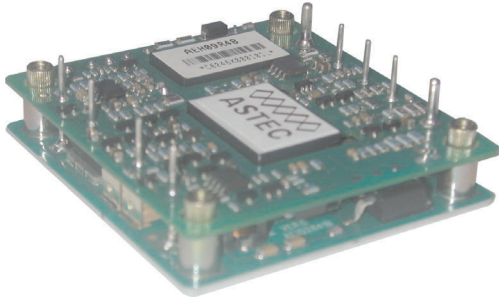

Total Power: 250W
Input Voltages: 48V
No. of Outputs: Single

Electrical Specs

Input

Input Range 36 to 75 VDC
 Input Surge 100V /100ms
 Efficiency 91%@28V Typ

Output

Output Regulation (Line, load, temp) <0.5%
 Ripple 200mV pp max
 Noise 240mV pp max

Remote sense +/-10% of Vo
 Transient Response 25% I_{nom} step from 50%I_{nom}.
 3%Vo max, 500μs (di/dt =0.1A/μs)

Overvoltage Protection 32.2V to 39.2V (Latch)
 Current Limit 9.9A to 12.6A (Auto-recovery)
 Overtemperature Protection Auto-recovery
 Switching Frequency 250kHz

Control

Voltage Adjust 80 to 110%
 Enable Positive & negative enable options

Thermal Derating

The module can deliver up to full power at 50°C ambient, Vin: 48V, with 0.5m/sec forced air.

Special Features

- High efficiency (91% Typical)
- Industry standard package 2.4" x 2.28" x 0.5"
- Remote sense compensation
- Basic insulation
- No load requirement

Environmental

Operating Ambient Temp: -40°C to +70°C
 Overtemperature protection
 MTBF: 2 million hours

Safety

UL, CSA, TUV

AMERICA

5810 Van Allen Way
Carlsbad, CA 92008
Telephone: 760-930-4600
Facsimile: 760-930-0698

EUROPE

Astec House, Waterfront Business Park
Merry Hill, Dudley
West Midlands, DY5 1LX, UK
Telephone: 44 (1384) 842-211
Facsimile: 44 (1384) 843-355

ASIA

Units 2111-2116, Level 21
Tower 1, Metroplaza
223, Hing Fong Road
Fwai Fong, New Territories
Hong Kong
Telephone: 852-2437-9662
Facsimile: 852-2402-4426



AEH09R48N

Ordering Information

Input Voltage	Output Voltage	Output Current	Efficiency	Model Number
48V	28V	9A	91% Typ	AEH09R48N

NOTES: "N" = Negative logic enable (without "N" = Positive logic enable)

Pin Assignments

Single Output

1. +Vin
2. CNT
3. Case
4. -Vin
5. +Vo
6. + Sense
7. Trim
8. - Sense
9. -Vo

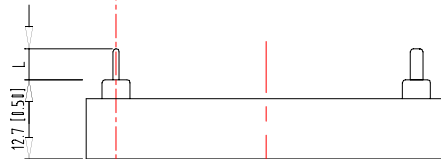
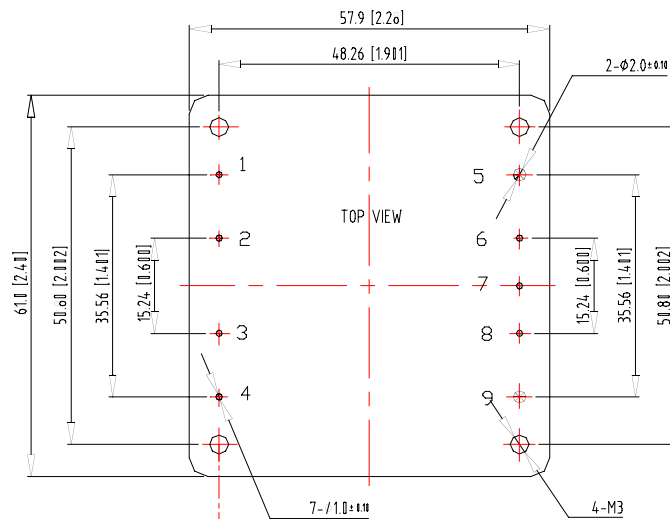

L: Pin length optional, dependent on the device code suffix. 6: 3.8mm, 8: 2.8mm, 7: 5.8mm. Default: 5mm.

TOLERANCES : X.Xmm=+/-0.5mm
X.XXmm=+/-0.25mm

Notes:

1. All specifications subject to change without notice. Mechanical drawings are for reference only.
2. Technical Reference Notes should be consulted for detailed information when available.

Mouser Electronics

Authorized Distributor

Click to View Pricing, Inventory, Delivery & Lifecycle Information:

[Emerson Network Power:](#)

[AEH09R48](#)