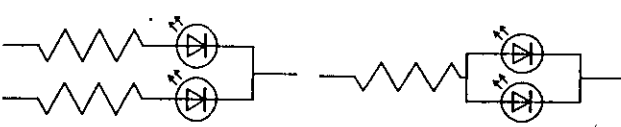
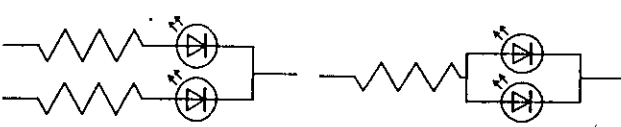

Approved	Checked	Designed	DEVELOPMENT SPECIFICATION					
		<i>T. Takata</i>	P/N: LNJ816C87RA				TEMPORARY	
T Y P E			Soft Orange Light Emitting Diode					
A P P L I C A T I O N			Indicators					
M A T E R I A L			InGaAlP					
O U T L I N E			Attached					
A B S O L U T E M A X I M U M R A T I N G S			P	#1 I <sub>FP</sub>	I <sub>FDC</sub>	V <sub>R</sub>	Topr	Tstg
			55	60	20	4	-30~+85	-40~+100
			mW	mA	mA	V	°C	°C
C O N D I T I O N			T <sub>a</sub> = 25 ± 3°C					
Test Specification								
I t e m	Symbol	C o n d i t i o n	Typ	Limit		Unit		
				Min	Max			
Forward Voltage	V <sub>F</sub>	I <sub>F</sub> = 10 mA	1.95		2.5	V		
Reverse Leakage Current	I <sub>R</sub>	V <sub>R</sub> = 4 V			100	μA		
Luminous Intensity #2	I <sub>O</sub>	I <sub>F</sub> = 10 mA DC	30	16		mcd		
Peak Emission Wavelength	λ <sub>P</sub>	I <sub>F</sub> = 10 mA DC	615			nm		
Spectral Line Half Width	Δλ	I <sub>F</sub> = 10 mA DC	20			nm		
#1. The Condition of I <sub>FP</sub> is duty 10%, Pulse width 1 ms #2. Tolerance of luminous intensity: ±20%.								
NOTE								
★1. Please contact the Panasonic local office if you design at low current (below 1mA DC) or pulse current operation and have any questions.								
★2. Soldering conditions... Refer to Handling note.								
★3. Compositions of the lead ... Cu/Ni/Au plating								
★4. Beware of destruction by static electricity in handling the LED.								
★5. Circuit to operate LED.								
						(A) Recommended circuit.		
						(B) The difference of brightness between the LED could be found due to the V <sub>F</sub> characteristics of each LED.		
Oct. 20. 2001								

Approved	Checked	Designed
		T. Tabata

DEVELOPMENT SPECIFICATION

P/N: LNJ816C87RA

TEMPORARY

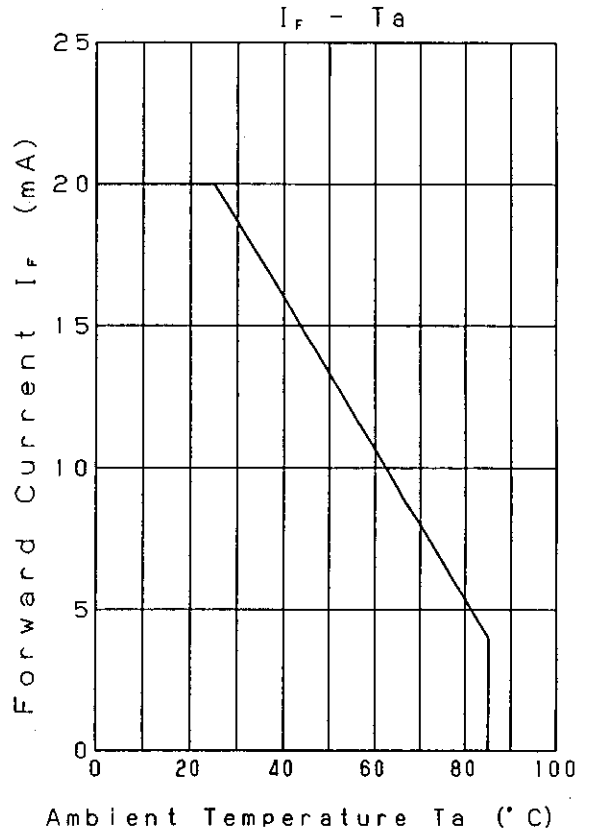
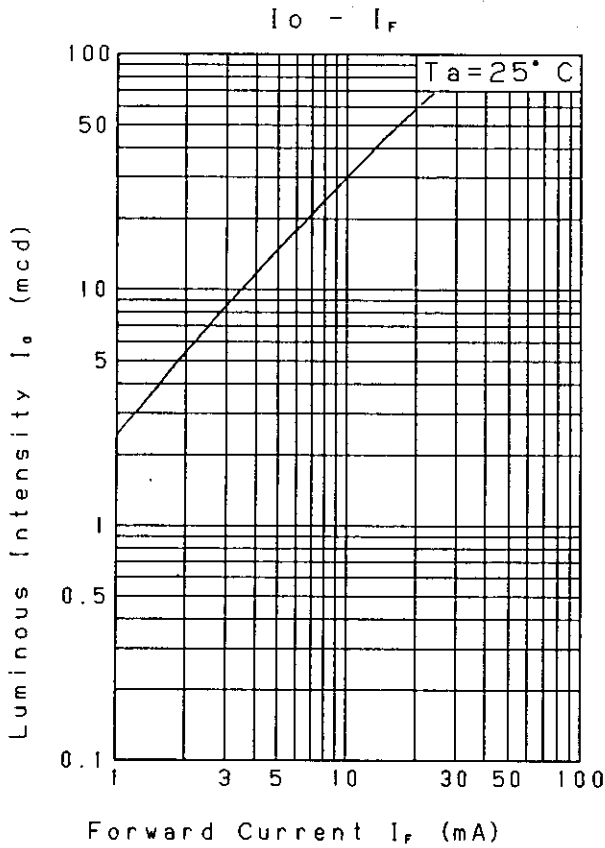
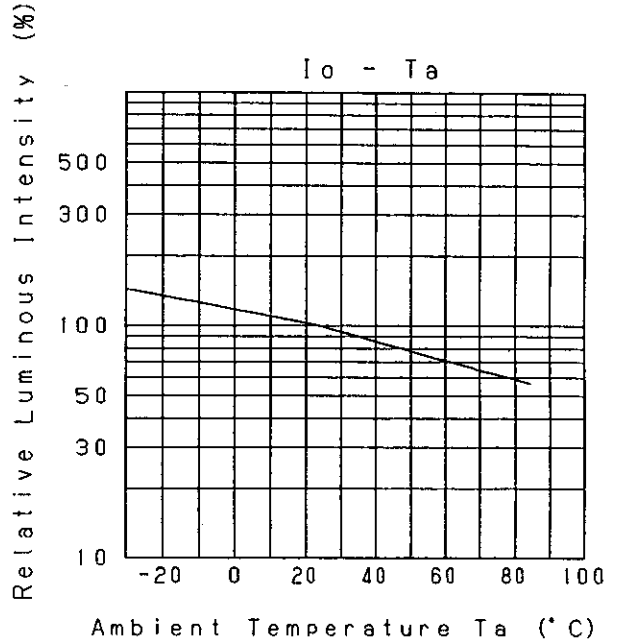
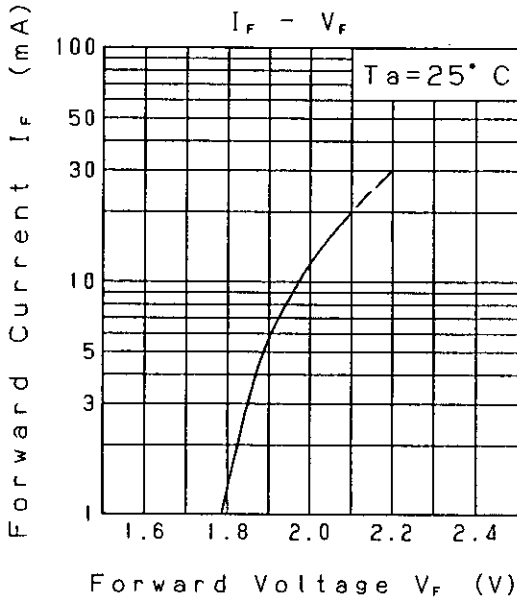

Nov. 7, 2001

Approved	Checked	Designed
		T. Tabata

DEVELOPMENT SPECIFICATION

P/N: LNJ816C87RA

TEMPORARY

Relative Luminous Intensity  
Wavelength Characteristics

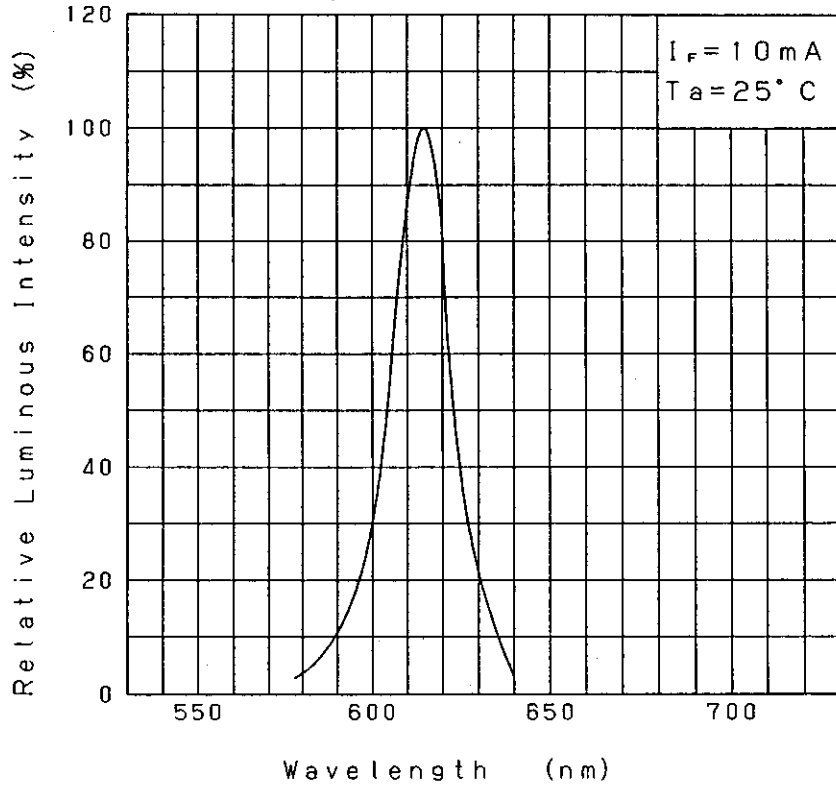

Directive Characteristics

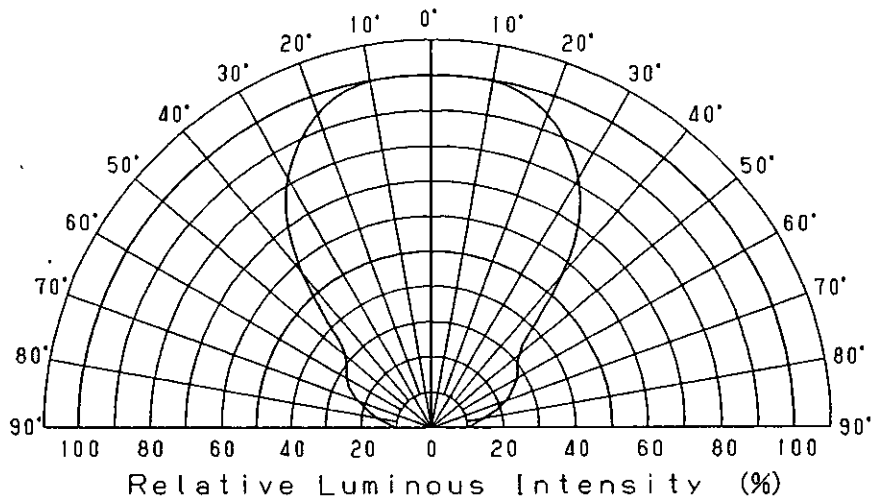

Nov. 7, 2001

Approved <i>T. Akeda</i>	Checked <i>M. Ni</i>	Designed <i>T. Taketa</i>	DEVELOPMENT SPECIFICATION (OUTLINE) P/N:	

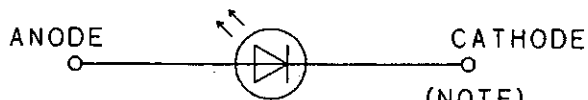
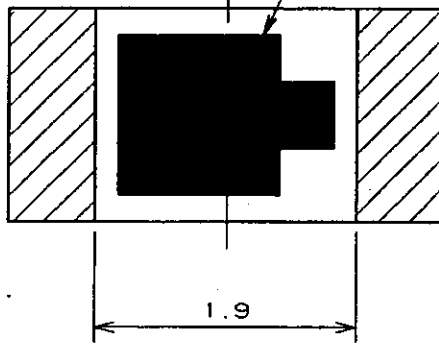
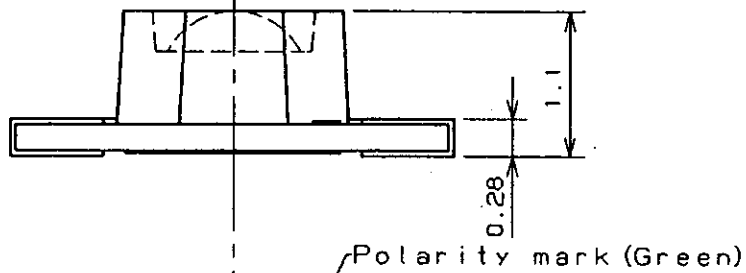
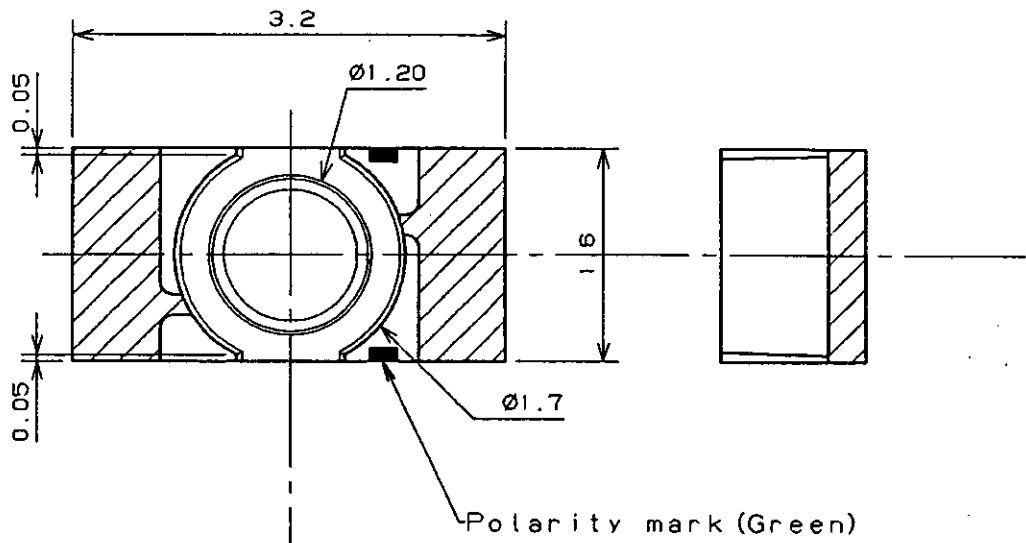

(NOTE)  
 1. Unit: mm  
 2. Tolerance unless specified is  $\pm 0.15$ .  
 3. indicate Au terminal.

Jan. 31. 2000			
---------------	--	--	--