

# PORT REDUCERS

Mounting onto a port frame, a Port Reducer reduces the clear aperture of the port frame.

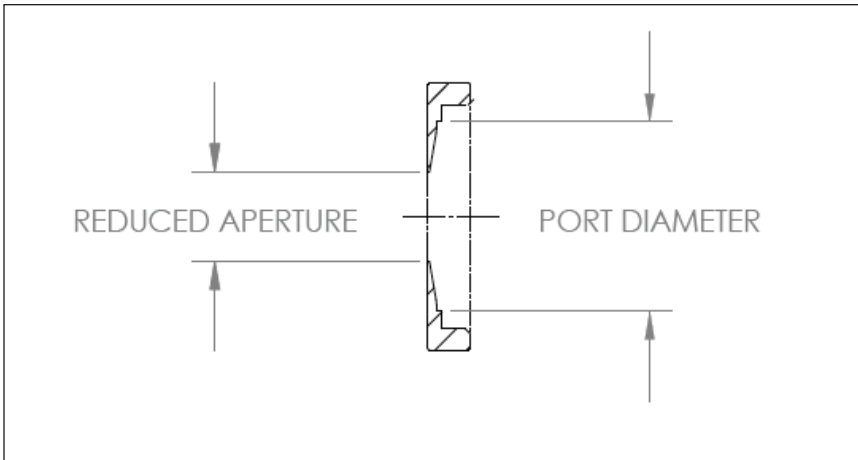

Model Number	Order Number	Port Diameter	Aperture	Reflectance Material
PR-100-0500-SF	AS-02401-004	1"	0.500"	Spectrafect
PR-100-0750-SF	AS-02401-006	1"	0.750"	Spectrafect
PR-150-0500-SF	AS-02402-004	1.5"	0.50"	Spectrafect
PR-150-1000-SF	AS-02402-008	1.5"	1.00"	Spectrafect
PR-250-0500-SF	AS-02404-004	2.5"	0.50"	Spectrafect
PR-250-0750-SF	AS-02404-006	2.5"	0.75"	Spectrafect
PR-250-1000-SF	AS-02404-008	2.5"	1.00"	Spectrafect
PR-250-1500-SF	AS-02404-012	2.5"	1.50"	Spectrafect
PR-250-2000-SF	AS-02404-016	2.5"	2.00"	Spectrafect
PR-400-1000-SF	AS-02415-008	4"	1"	Spectrafect
PR-400-2000-SF	AS-02415-016	4"	2"	Spectrafect
PR-400-3000-SF	AS-02415-024	4"	3"	Spectrafect
PR-100-0125-FB	AS-02411-001	1"	0.125"	Flat Black
PR-100-0250-FB	AS-02411-002	1"	0.25"	Flat Black
PR-100-0500-FB	AS-02411-003	1"	0.50"	Flat Black
PR-100-075-FB	AS-02411-006	1"	0.75"	Flat Black
PR-050-0500-IG	AS-02420-004	0.5"	0.500"	Infragold
PR-050-0750-IG	AS-02420-006	0.5"	0.750"	Infragold
PR-100-0250-IG	AS-02421-002	1"	0.25"	Infragold

## PR-XXX-YYYY-SL, SF, IG, FB

XXX = Diameter of the sphere port

SL = Spectrafect Coating

IG = Infragold

FB = Flat Black