



Gold Box UNREGULATED

AC-DC single output & wide adjust output

- Shipped Within 3 Days
- U.L. Recognized
- Five Year Warranty



Don't forget these facts about Acopian....

1. We ship within 3 Days (see our 3 Day Shipping Promise below).
2. Acopian power supplies last a *very long time*.
3. The Voltage Finder is the quickest way to find a power supply with the specs you need.
4. The Online System builder (www.acopian.com/SystemBuilder) is a convenient way to get your own custom Power System (and they ship within 9 Days).
5. You always talk to a real person when you call Acopian.
6. You can order your Acopian power supplies factory direct.
7. You can order your Acopian power supplies online.
8. All Acopian products are made in the USA.



Acopian Technical Company • Easton, PA
 1-800-523-9478 • www.acopian.com
 Order Factory Direct   
 Made in USA 



Gold Box UNREGULATED

AC-DC
single output & wide adjust output

- Shipped Within 3 Days
- U.L. Recognized
- Five Year Warranty



Models in case size YA have output voltage adjustment on rear panel.

Low-cost DC power suitable for driving loads such as lamps, relays, and small motors is provided by these unregulated power supplies. All components are generously derated, insuring a long and trouble-free life; built-in fusing prevents damage due to prolonged

overloading or short circuits. Mechanically similar to the regulated supplies shown on pages 46 and 47, they are housed in extruded aluminum cases which can be mounted in any position. Many models are U.L. Recognized.

STANDARD FEATURES

- Capacitive filtering
- Fused input
- May be used in series or parallel
- No derating or heat sinking required
- Completely serviceable

SPECIFICATIONS

Input Voltage: 0-125 VAC, 50-400 Hz, single phase.

Output Voltage Adjustment: Adjustable voltage models are provided with a built-in continuously adjustable autotransformer.

Load Regulation: The nominal output voltages of single output models, and the maximum rated output voltages for models with wide adjust outputs, are based on 115 VAC input with approximately one-half load. At no load, they will increase by approximately 10%. At full load, they will be reduced by approximately 10%.

Line Regulation: Output voltage change due to line change directly proportional to input change.

Polarity: Output is floating; either positive or negative terminal may be grounded or floated up to 300 volts above ground.

Ambient Operating Temperature: -10 to +65°C.
No derating required.

Storage Temperature: -55 to +85°C.

OPTIONS

Terminal Strip Cover: Clips on. To order, add suffix "M" to model number and \$5.00 to price.

230 Volt Input: Provision for inputs of 0-250 VAC, 50-400 Hz, replacing the standard 0-125 VAC input voltage range, is available on single output models. To order, add suffix "-230" to model number and \$25.00 to price (for models in case size YH11 add \$40.00). The "-230" option requires two additional days.

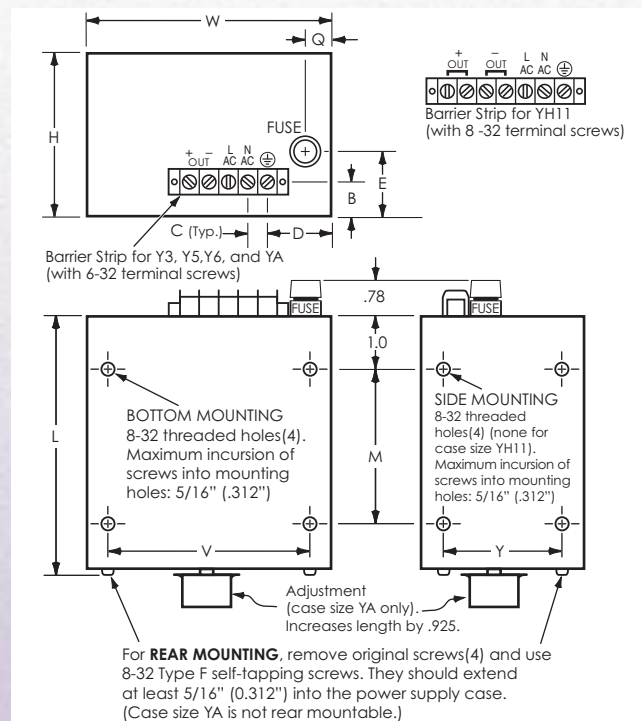

Case Size	L	W	H	M	V	Y	Q	E	B	D	C	Approx. Weight
Y3	3.71	5.12	3.44	1.62	4.5	3.0	.56	1.37	.75	1.44	.375	2 lb. 8 oz.
Y5	5.09	5.12	3.44	3.0	4.5	3.0	.56	1.37	.75	1.44	.375	4 lb. 8 oz.
Y6	6.59	5.12	3.44	4.0	4.5	3.0	.56	1.37	.75	1.44	.375	7 lb. 8 oz.
YH11	11.25	7.37	5.12	8.0	6.75	4.56	1.10	2.64	1.25	2.25	.562	18 to 23 lb.
YA	6.59	5.12	3.44	4.0	4.5	3.0	.56	1.37	.75	1.44	.375	4 to 5 lb.

Mounting: Threaded mounting holes permit mounting to a chassis, cabinet wall or bracket, or they may be used on a test bench or tabletop. To mount from the power supply side of the mounting surface or for DIN rail mounting, see accessory Mounting Kits on page 91.

SINGLE OUTPUT

Nominal Output Voltage	Output Current Amps.	Output Voltage N/L-F/L	Ripple Volts RMS	(\$) Price	Model	Case Size
4	.200	4.4 to 3.6	.2	\$110	U4Y20	Y3
5	10.0 (@ 5.0)	6.7 to 3.6 (5.0)	1.8 (1.3)	\$165	U5Y1000	Y6
6	2.0	7.7 to 4.8	2.0	\$110	U6Y200	Y3
6	5.0	7.5 to 5.0	1.8	\$165	U6Y500	Y5
7	8.0	8.0 to 5.4	1.5	\$165	U7Y800	Y6
9	10.0 (@ 5.0)	11.5 to 7.5 (9.0)	2.3 (1.3)	\$165	U9Y1000	Y6
10	10.0 (@ 5.0)	12.4 to 8.0 (9.8)	2.3 (1.3)	\$165	U10Y1000	Y6
12	1.5	14.9 to 10.9	2.5	\$110	U12Y150	Y3
12	5.0	14.8 to 10.5	1.8	\$150	U12Y500	Y5
12	10.0 (@ 5.0)	14.1 to 9.8 (11.5)	2.3 (1.3)	\$170	U12Y1000	Y6
14	1.0	15.4 to 12.6	.7	\$110	U14Y100	Y3
14	10.0 (@ 5.0)	16.4 to 12.1 (14.0)	2.3 (1.3)	\$170	U14Y1000	Y6
15	10.0 (@ 5.0)	17.2 to 12.8 (14.5)	2.3 (1.3)	\$170	U15Y1000	Y6
16	1.0	17.6 to 14.4	.7	\$110	U16Y100	Y3
16	10.0 (@ 5.0)	18.8 to 14.2 (16.0)	2.3 (1.3)	\$170	U16Y1000	Y6
18	1.0	19.8 to 16.2	.7	\$110	U18Y100	Y3
18	10.0 (@ 5.0)	21.0 to 15.8 (18.0)	2.4 (1.4)	\$170	U18Y1000	Y6
20	4.0	22.0 to 17.5	2.0	\$150	U20Y400	Y5
20	10.0 (@ 5.0)	23.7 to 18.3 (20.4)	2.4 (1.4)	\$170	U20Y1000	Y6
24	1.0	26.4 to 21.6	1.7	\$110	U24Y100	Y3
24	3.5	26.0 to 21.0	2.0	\$150	U24Y350	Y5
24	5.0	26.5 to 21.0	2.5	\$170	U24Y500	Y6
24	10.0	26.8 to 21.4	2.4	\$205	U24Y1000	Y6
24	17.0	26.4 to 21.6	1.5	\$355	U24Y1700	YH11
24	23.0	27.0 to 21.0	1.5	\$385	U24Y2300	YH11
25	5.0	28.1 to 22.3	2.5	\$170	U25Y500	Y6
27	5.0	30.0 to 24.0	2.6	\$170	U27Y500	Y6
28	1.0	30.8 to 25.2	1.7	\$110	U28Y100	Y3
28	3.0	30.8 to 26.0	2.0	\$150	U28Y300	Y5
28	5.0	31.2 to 24.8	2.6	\$170	U28Y500	Y6
28	8.0	30.2 to 25.0	2.4	\$205	U28Y800	Y6
28	15.0	30.8 to 25.2	1.5	\$355	U28Y1500	YH11
28	20.0	30.4 to 24.5	1.5	\$385	U28Y2000	YH11
30	2.0	33.0 to 27.0	1.5	\$145	U30Y200	Y5
32	.400	35.2 to 28.8	.6	\$110	U32Y40	Y3
32	5.0	35.5 to 28.0	3.3	\$175	U32Y500	Y6
35	5.0	38.0 to 30.0	3.3	\$175	U35Y500	Y6
37	5.0	40.5 to 32.2	3.3	\$175	U37Y500	Y6
38	5.0	43.0 to 34.0	3.3	\$175	U38Y500	Y6
40	1.0	44.0 to 36.0	1.6	\$125	40UY100	Y3
40	2.0	44.0 to 36.0	1.5	\$150	U40Y200	Y5
40	5.0	45.0 to 37.0	3.3	\$175	U40Y500	Y6

Nominal Output Voltage	Output Current Amps.	Output Voltage N/L-F/L	Ripple Volts RMS	(\$) Price	Model	Case Size
41	.400	45.1 to 36.9	.6	\$110	U41Y40	Y3
42	5.0	48.0 to 36.0	6.5	\$175	U42Y500	Y6
44	2.0	48.4 to 39.6	1.5	\$150	U44Y200	Y5
45	1.0	49.5 to 40.5	1.6	\$135	45UY100	Y3
45	5.0	51.0 to 38.5	6.5	\$175	U45Y500	Y6
48	.400	52.8 to 43.2	.6	\$120	U48Y40	Y3
50	1.0	55 to 45	1.6	\$135	50UY100	Y3
52	.400	57.2 to 46.8	.6	\$125	U52Y40	Y3
55	.250	60.5 to 49.5	.4	\$120	U55Y25	Y3
60	1.0	65.3 to 53.0	2.8	\$145	U60Y100	Y5
62	.400	69.0 to 58.0	1.5	\$125	U62Y40	Y3
80	.300	88.0 to 72.0	1.0	\$125	U80Y30	Y3
90	.400	99.0 to 81.0	2.2	\$125	U90Y40	Y3
95	.150	105 to 85	1.1	\$125	U95Y15	Y3
100	.200	110 to 93	1.0	\$125	U100Y20	Y3
110	.200	121 to 100	1.0	\$125	U110Y20	Y3
120	.200	132 to 110	1.0	\$125	U120Y20	Y3
140	.200	154 to 126	1.7	\$135	U140Y20	Y3
150	.200	165 to 135	1.7	\$135	U150Y20	Y3
165	.200	176 to 144	1.7	\$135	U165Y20	Y3
170	.200	187 to 153	2.0	\$135	U170Y20	Y3
180	.200	190 to 162	2.0	\$135	U180Y20	Y3
200	.200	220 to 180	2.0	\$140	U200Y20	Y3
250	.200	275 to 225	4.0	\$140	250UY20	Y3
275	.100	303 to 247	3.0	\$135	U275Y10	Y3
275	.200	303 to 247	4.0	\$145	U275Y20	Y5
300	.200	330 to 270	5.0	\$145	U300Y20	Y5
325	.200	360 to 295	6.0	\$145	U325Y20	Y5
340	.100	374 to 306	3.0	\$135	U340Y10	Y3
360	.100	396 to 324	3.0	\$135	U360Y10	Y3
370	.100	407 to 333	3.0	\$135	U370Y10	Y3
400	.200	440 to 360	6.0	\$150	U400Y20	Y5
420	.100	462 to 378	6.7	\$135	U420Y10	Y3
475	.020	523 to 426	3.1	\$135	U475Y02	Y3
500	.200	550 to 450	9.1	\$165	U500Y20	Y5
550*	.100	605 to 495	4.8	\$165	U550Y10	Y5
580*	.020	638 to 522	3.1	\$135	U580Y02	Y3
600*	.100	660 to 540	10.0	\$170	U600Y10	Y5
750*	.020	825 to 675	3.1	\$135	U750Y02	Y3
800*	.100	880 to 720	13.0	\$170	U800Y10	Y5
900*	.020	990 to 810	5.0	\$140	U900Y02	Y3
900*	.100	990 to 810	13.0	\$170	U900Y10	Y5
1000*	.100	1100 to 900	13.0	\$170	U1000Y10	Y5

*Not U.L. recognized when this catalog was published.

WIDE ADJUST OUTPUT

Output Voltage Range	Output Current Amps.	Ripple Volts RMS	(\$) Price	Model	Case Size
0-8*	2.0	2	\$290	U8YA200	YA
0-15*	1.5	2.5	\$290	U15YA150	YA
0-54*	1.0	1.6	\$290	U54YA100	YA
0-95*	.300	2.2	\$290	U95YA30	YA
0-125*	.200	1.5	\$290	U125YA20	YA
0-220*	.200	2	\$290	U220YA20	YA
0-260*	.200	4	\$290	U260YA20	YA
0-370*	.100	3	\$290	U370YA10	YA
0-450*	.100	6.7	\$290	U450YA10	YA
0-800*	.020	3.1	\$290	U800YA02	YA
0-950*	.020	5	\$290	U950YA02	YA

*Not U.L. recognized when this catalog was published.

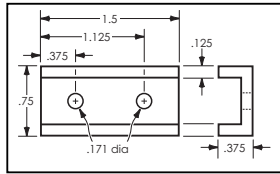

WALL MOUNTING KITS ...\$10

These kits provide a way of mounting power supplies on a wall or panel when the other side of the mounting surface is inaccessible. Each kit consists of four aluminum brackets and four machine screws for fastening them to the power supply, effectively adding mounting flanges to the power supply.

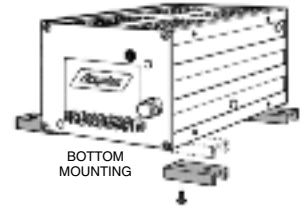

For Gold Box and modular High Voltage power supplies:

GB8 Mounting Kit (#8-32 mounting holes)

Can be used on these case sizes:

CM6, CM9, CM13, CH11, CH16, DG5, DG6, DG9, G3, G5, G5D, G6, G9, G13, GT5, GT6, GT9, GT13, H8, H11, H16, HD345, HD355, HA349, HA359, HT11, HT16, M6, M9, M13, RM6, RW6 TG5, TG6, TG9, TG13, TH11, WG7, WM6, WM9, Y3, Y5, Y6, YH11, YA

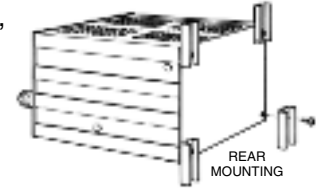

For Narrow Profile power supplies:

NP6 Mounting Kit (#6-32 mounting holes)

Can be used on these case sizes:

AMC, CN8T, DN6B, DN6A, DN8A, DN8, F6T, F8T, N8T, WL9, WN6A, WN6B, WN8, WN8A, TN6T

NP6L Mounting Kit (#6-32 mounting holes)

Model NP6L consists of two brackets 1.5" long as shown above, and two 2.5" long brackets (to extend beyond heat sink).

Can be used on these case sizes:

CN8H, N8H, TN8H

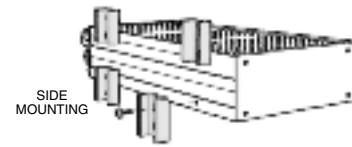

DIN RAIL MOUNTING KITS ...\$15

NPH35DIN Mounting Kit (Horizontal mounting)

Can be used on these case sizes:

CN8H	DN6A	F6T	N8H	TN6T	WN6A
CN8T	DN6B	F8T	N8T	TN8H	WN6B
	DN8				WN8
	DN8A				WN8A



GR35DIN Mounting Kit (Rear mounting)

Can be used on these case sizes:

CM6	DG5	G3	GT5	HD345	M6	RM6	TG5	Y3
CM9	DG6	G5	GT6	HD355	M9	RW6	TG6	Y5
	DG9	G5D	GT9				TG9	Y6
		G6						
		G9						

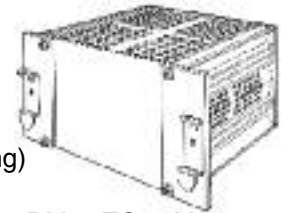

(Can be used, but not recommended on case sizes: G13, GT13, M13, TG13)

NPV35DIN Mounting Kit (Vertical mounting)

Can be used on these case sizes:

CN8H	DN6A	F6T	N8H	TN6T	WN6A
CN8T	DN6B	F8T	N8T	TN8H	WN6B
	DN8				WN8
	DN8A				WN8A



GH35DIN Mounting Kit (Horizontal mounting)

Can be used on these case sizes:

CM6	DG5	G3	GT5	M6	TG5	Y3
CM9	DG6	G5	GT6	M9	TG6	Y5
CM13	DG9	G5D	GT9	M13	TG9	Y6
		G6	GT13		TG13	
		G9				
		G13				

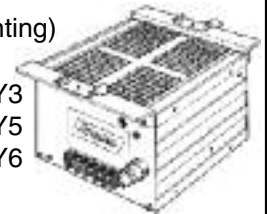

WL35DIN Mounting Kit (Vertical mounting)

Can be used on this case size: WL9

NPR35DIN Mounting Kit (Rear mounting)

Can be used on these case sizes:

CN8H	F6T	N8H	TN6T
CN8T	F8T	N8T	TN8H

CH35DIN Mounting Kit (Horizontal mounting)

Can be used on these case sizes: RM6, RW6

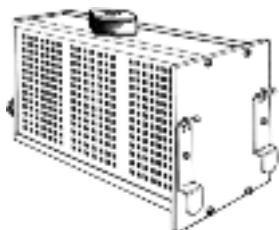

WH35DIN Mounting Kit (Horizontal mounting)

Can be used on these case sizes: WM6, WM9



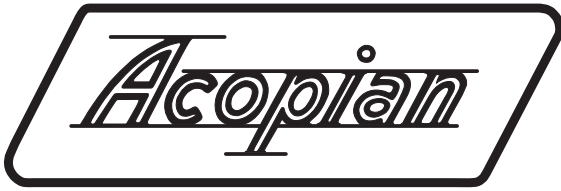

About Acopian's 3 Day Shipment Guarantee:

In 1964, Acopian initiated its "3 Day Shipping Guarantee." Since then our product offerings have expanded to include many more lines of power supplies that ship within 3 Days as well as others that ship within 6 or 9 Days. These guarantees apply to every model in the Acopian catalog.

Our unique 3-day shipping guarantee has prompted many questions. Below are some of those most often asked:

What does Acopian's 3-day shipping promise mean?

It means that power modules listed in this catalog are shipped within 3 days after we receive your order. High Voltage, Redundant, Rack Mounting, Systems and certain Switching power supplies are shipped within 9 days.

Has Acopian ever failed to meet this promise?

Never.

Do options affect shipping time?

The 230 volt input option and moisture/fungus-proofing option require two additional days. All other options do not affect shipping time.

Is the 3-day promise affected by quantity? Suppose we need 50 or 100 pieces?

The 3-day promise applies to orders for five or less modules. (Two or less for 9-day items). If requested, Acopian will ship five pieces of a larger order in 3 days and, with consideration of your requirement, schedule the balance. (Since each shipment is processed and priced as a separate order, for lowest prices request shipment in one lot.)

What if I need four or five different models? Does the 3-day promise still apply?

Yes. Guaranteed 3-day shipment applies to one model or to a combination of models.

Do I have to ask for 3-day shipment of my order?

3-day shipment is automatic. In fact, you must tell us if you want the shipment delayed.

How long after you ship will I have the power supplies?

Transportation time varies with the carrier used. Unless otherwise requested, Acopian ships small orders by UPS Ground.

You say Acopian has never failed to meet the 3-day promise. How do you do it?

Our facilities have been designed and equipped to meet our 3-day shipment promise. When your order is received, your power supplies are built specifically for you and shipped within three days. We do not ship from stock. (For this reason, we are unable to accept returns for credit.)

I've seen other power supply manufacturers advertise "same-day shipment." Isn't that better than 3-day shipment?

A typical vendor's "same-day shipment" advertisement can only be fulfilled if the power supplies you need are in stock. Otherwise, a four to six week delay is not unusual before inventory is replenished and your order is shipped.

Acopian's 3-day shipment promise applies to ALL 3 Day models (larger units ship within 9 Days) and is not dependent on the quantity in stock. We build each unit after the order for that unit is received. If an order is needed faster, often times we can ship in less than 3 days.

If you require shipment even earlier than our standard promise, just let us know, we can usually ship sooner. We welcome the opportunity to work with you.

ACOPIAN...

...answers your phone call with a live salesperson

No automated menus. The person who answers your call will courteously and promptly answer your questions, quote price and delivery, expedite your urgent requirements, and offer you immediate access to our engineers.

Call toll free 800-523-9478.

...can customize power supplies for you

If a standard power supply does not meet all of your requirements, speak with one of our engineers. We can often modify the specifications, ratings and configuration of a supply. We can also combine several power supplies into a Multiple Output Power System with the operating features you specify (such as meters and switches) and ship it within 9 Days!

...has a 5-year warranty

This is typical: One of our customers sent us an old power supply with a note indicating that the supply had been in continuous use since 1972 (33 years!), but he had recently noticed that the output voltage was low. We found that the capacitors had dried up, replaced them and returned the supply to the customer, who thanked us and said he intends to keep using it. We focus on making power supplies that will last a long time. There are power supplies that cost less than ours, or that are smaller than ours, but you won't find any that last longer than ours. All too often, low-priced supplies are densely packed, run hot, have short lifetimes and short warranties. All Acopian metal-cased power products have a 5-year warranty, but you can expect them to last a lot longer.

Purchase Acopian... 3-day shipment, long lasting power supplies, and unsurpassed customer service.

"In my business, Acopian is referred to as bulletproof. It never fails and lasts forever."

- Steve Andrews, President
Technical Options, Inc.

"If Acopian made automobiles, I'd buy one without question."

- David A. Price, Research Technologist
Georgia Tech Research Institute

ORDERING INFORMATION & Terms and Conditions

ACOPIAN SELLS FACTORY DIRECT WORLDWIDE: We do not use representatives or distributors. Contact Acopian for technical information or a quote.

WARRANTY: Acopian power supplies are warranted to be free from defects in material and workmanship for a period of five years (encapsulated devices, for one year) from date of original shipment. Acopian's obligation under this warranty is limited to repairing any power supply returned to the factory Service Department in Easton, PA and replacing any defective parts. Mini Encapsulated power supplies are not repairable. Authorization must be obtained from Acopian before a power supply may be returned for repair. Units must be well packed when shipping to Acopian; the repair of any damage incurred during shipment will be charged. Transportation charges are to be paid by the purchaser. A reinspection and handling charge will be applied to returned units found to have no defects. If a failure has been caused by misuse, operation in excess of specifications, or modification by the customer, repairs will be billed at cost; in such cases, a cost estimate will be submitted before work is started.

Acopian reserves the right to make changes or improvements in its products without incurring any obligation to install the same on products previously manufactured.

This warranty is in lieu of all other warranties, obligations, and liabilities, expressed or implied, and is the purchaser's exclusive remedy. Acopian makes no warranty, either express or implied, of merchantability, fitness for a particular purpose or otherwise. In no event shall Acopian be liable whether in contract, tort, or negligence, for special, indirect, incidental or consequential damages of any kind, including loss of business or profits, or any other losses incurred by the purchaser or any third party, the Customer's remedies being limited, at Acopian's option, to replacement, repair or credit at the price on the date of claim.

The validity, performance and construction of all terms and conditions and any sale made by Acopian shall be determined by the law of Pennsylvania, without regard to its conflict of law principles, and all parties to the transaction expressly consent to the jurisdiction of such courts and consent to the venue of the Court of Common Pleas for Northampton County, Pennsylvania.

PRICES: The prices shown are F.O.B. our factory; Easton, PA. or Melbourne, FL.. All prices and specifications are subject to change without notice. Minimum order is \$50.00.

TERMS: Net 30 days, subject to credit approval. Visa, MasterCard and American Express also accepted.

SHIPPING: Location permitting, small shipments are made by United Parcel Service, or by Parcel Post; larger shipments, by insured motor freight collect. Shipments can be made by air upon request. Risk of loss shall be F.O.B. Our Factory, even in cases where freight may be prepaid or allowed to destination by Acopian. If equipment is received in damaged condition, it is the customer's responsibility to contact the carrier and file a claim for damages.

TIME FOR DELIVERY: The time for delivery quoted by Acopian is the time required to ship from our plants. We will not be liable for delays in delivery caused by any reason beyond our control, including but not limited to acts of God, casualty, civil disturbance, labor disputes, transportation or supply difficulties, or any interruption of our facilities, and the quoted time for delivery shall be extended during the continuance of such conditions and for a reasonable time thereafter. In no event will Acopian be liable for any premium transportation, procurement, or similar costs incurred by the Customer as a result of conditions beyond Acopian's control resulting in Acopian's inability to deliver product in accordance with customer's requested delivery schedules.

QUANTITY DISCOUNTS: Discounts are available to quantity buyers and are dependent upon the order quantity and the manufacturing scheduling anticipated by the order, and apply only to the quantity and delivery ordered. Partial shipments are considered as separate orders for discounting purposes.

EXPORT ORDERS: A minimum export documentation charge of \$60.00 applies. (A minimum charge of \$25.00 applies on orders requiring customs forms for Canadian orders and for orders to certain U.S. territories.)

MOISTURE/FUNGUS PROOFING: Power supplies can be furnished with a moisture and fungus resistant varnish applied to interior surfaces. To order, add the suffix letter F to the model number. The additional cost is \$25.00 per output and requires two additional days. Not available on High Voltage, Mini Encapsulated, Rack Mounting, and Gold Box Switching models.

TAGGING: Maximum of 15 characters/spaces. Add \$10.00 to price.

TEST DATA: Cost, \$35.00 or 2% of order, whichever is greater.

SPECIAL MODELS/MODIFICATIONS: Cataloged models can be altered at the factory to meet special requirements. Contact the Applications Engineering Department to discuss your needs.

PARTS: The designs used in Acopian power supplies utilize standard components to the greatest practical extent. When replacements are required, the types originally used, or their equivalents, can usually be obtained most quickly from a local electronic components distributor.

Special components, such as transformers, are stocked at the factory warehouses. Contact the Applications Engineering Department for information on the parts required, referencing the model number of the power supply, the circuit designation of the component, and a description.

PURCHASE ORDER ACCEPTANCE: Orders are accepted subject to Acopian's Terms and Conditions. Any Terms and Conditions of any Purchaser's order, agreement, or understanding which are in addition to or inconsistent with Acopian's shall not be binding upon Acopian unless made in writing and accepted over the signature of an authorized officer of Acopian. Orders shall not be considered accepted until entered into production at our plant. Acopian reserves the right to refuse any order. All typographical and clerical errors are subject to correction by Acopian.

RETURNED GOODS: Acopian products are built on a per-order basis, and ordinarily no credit can be extended for their return. No goods will be accepted for return unless authorized in writing by Acopian.

CHANGES: The customer may, by a written notice, request changes within the general scope of the order, in the drawings, designs or specifications; method of shipment; and place of delivery. If any such change causes an increase or decrease in the cost, or the time required for the processing of any part of the order, an equitable adjustment shall be made in the price or delivery schedule, or both, and the order shall be modified in writing accordingly.

CANCELLATION: Suspension or cancellation of orders may be made only upon our written approval and on terms that will indemnify us against all loss.

OVERTIME: It is anticipated that any order will be processed during regular working hours on regular working days. If for any reason the Purchaser requests Acopian to process the order, or any portion of it, outside of such regular working hours, any overtime or other additional expense occasioned thereby shall be billed to and paid by the Purchaser as an extra cost. Acopian reserves the right to decline to process the order outside regular working hours.

CUSTOMER DELAY OF WORK: If the performance of all or any part of the work is delayed or interrupted by Customer's failure to act within the time specified (or within a reasonable time if no time is specified) and such act is not expressed or implied by the order, an adjustment shall be made in the cost of performance of the order caused by such delay or interruption and the order modified in writing accordingly. Adjustment will also be made in the delivery or performance dates and any other contractual provisions affected by such delay or interruption.

GOVERNMENT SPECIFICATIONS: Pricing is based upon industrial-grade construction, marking, packing, and packaging. Exception is taken to any MIL specifications, and to any requirements for the use of special forms, documentation other than quoted, and Government Source Inspection. Acopian must decline to quote on any other basis.

APPLICATIONS ASSISTANCE: *Questions regarding the specifications, features, and use of any Acopian product should be directed to the Applications Engineering Department. A staff of power supply specialists will be pleased to assist you.*

www.acopian.com - Online Ordering and Instant Quotes Online!



Since 1957

Acopian Technical Company

P.O. Box 638, Easton, PA 18044 • Phone: (610) 258-5441 • FAX: (610) 258-2842

Call toll free: (800) 523-9478 (International: Country Code 01)

ALL ACOPIAN
POWER SUPPLIES
MADE IN U.S.A.



PHOTO COURTESY OF THE ICECUBE PROJECT

“At Project IceCube, it’s absolutely critical to have a good power supply. The ice must be as pure and clear as possible. If the power to the ice top sensor system were to fail, we would risk the tank water freezing without being controlled, resulting in bubbles and impurities, and very much reducing the quality of ice and quality of information that we can see with our detectors. We chose Acopian power supplies to power our pumping and degassing systems because of their reputation for reliability. The people at Acopian met all of our highly demanding specifications and, despite very little time until our window to ship to the Pole, they met our schedule. We were 100% satisfied.”

Jim Baccus
Cable System Manager
Project IceCube

(the international high-energy neutrino observatory being built and installed in the ice below South Pole Station)

The world’s most demanding environments demand Acopian power systems.

Design your own Acopian power system online with the System Builder at www.acopian.com. Simply enter your requirements, and you’ll receive a quotation for fully wired multiple-output power systems, without the need for you to prepare mechanical layouts or search through a power supply catalog.

Each system will be completely wired, tested and shipped within 9 days after receipt of the order. Choose Acopian – the power supplies of choice for the world’s leading engineers.



ALL ACOPIAN POWER SUPPLIES
MADE IN U.S.A.

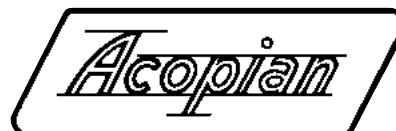

Acopian Technical Company

1-800-523-9478 • www.acopian.com