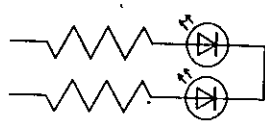
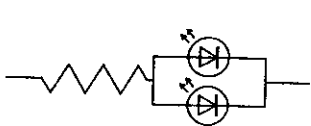

Approved	Checked	Designed	DEVELOPMENT SPECIFICATION					
		T. Takato	P/N: LNJ816C8SRA				TEMPORARY	
TYPE			Soft Orange Light Emitting Diode					
APPLICATION			Indicators					
MATERIAL			GaAsP					
OUTLINE			Attached					
ABSOLUTE MAXIMUM RATINGS			P	*1 I <sub>FP</sub>	I <sub>FDC</sub>	V <sub>R</sub>	Topr	Tstg
			60	60	20	3	-30~+85	-40~+100
			mW	mA	mA	V	°C	°C
CONDITION			Ta=25±3°C					
Test Specification								
Item	Symbol	Condition	Typ	Limit		Unit		
				Min	Max			
Forward Voltage	V <sub>F</sub>	I <sub>F</sub> =10mA	1.93		2.6	V		
Reverse Leakage Current	I <sub>R</sub>	V <sub>R</sub> = 3V			10	μA		
Luminous Intensity *2	I <sub>O</sub>	I <sub>F</sub> =10mA DC	1.5	0.8		mcd		
Peak Emission Wavelength	λ <sub>p</sub>	I <sub>F</sub> =10mA DC	610			nm		
Spectral Line Half Width	Δλ	I <sub>F</sub> =10mA DC	40			nm		
*1. The Condition of I <sub>FP</sub> is duty 10% . Pulse width 1 ms *2. Tolerance of luminous intensity: ±20%.								
NOTE								
★1. Please contact the Panasonic local office if you design at low current (below 1mA DC) or pulse current operation and have any questions.								
★2. Soldering conditions.....Refer to Handling note.								
★3. Compositions of the lead ..... Cu/Ni/Au plating								
★4. Circuit to operate LED.								
						(A) Recommended circuit. (B) The difference of brightness between the LED could be found due to the V <sub>F</sub> characteristics of each LED.		
(A)			(B)					
Oct. 24. 2001								

Approved	Checked	Designed
		T. Tabata

DEVELOPMENT SPECIFICATION

P/N: LNJ816C8SRA

TEMPORARY

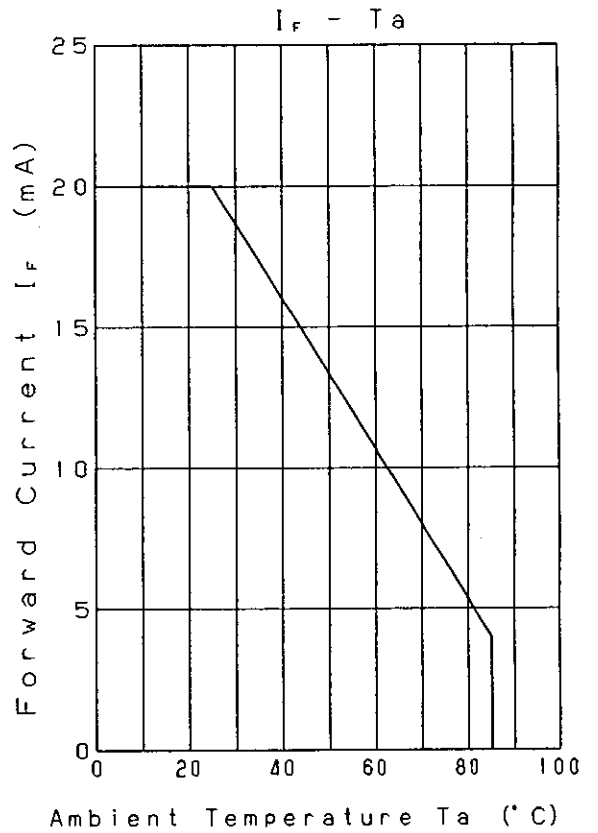
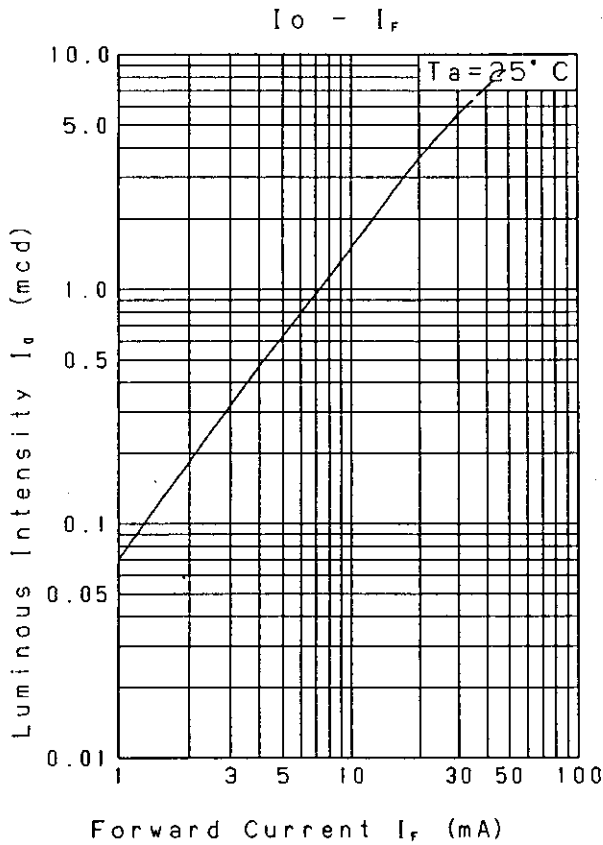
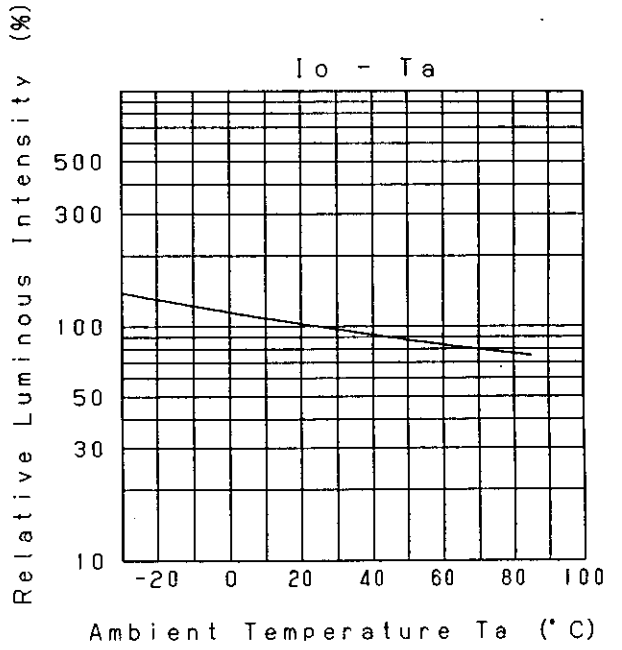
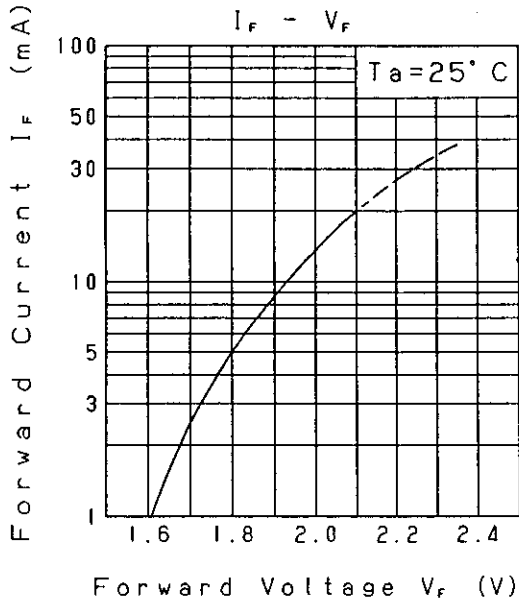

Oct.24.2001

Approved	Checked	Designed	DEVELOPMENT SPECIFICATION	TEMPORARY
		T. Tabata		

Relative Luminous Intensity  
Wavelength Characteristics

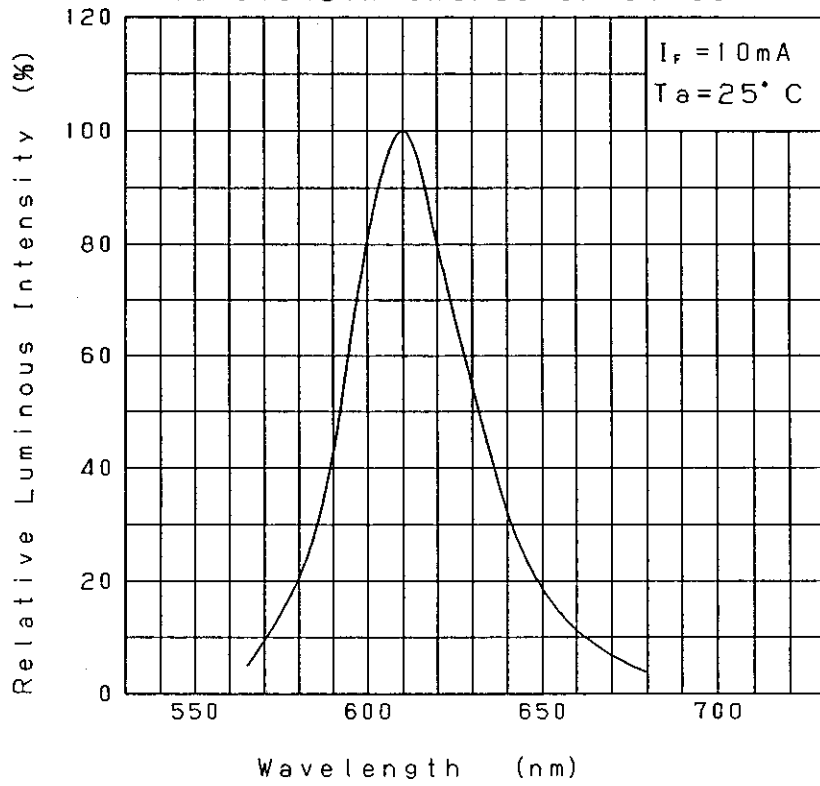

Directive Characteristics

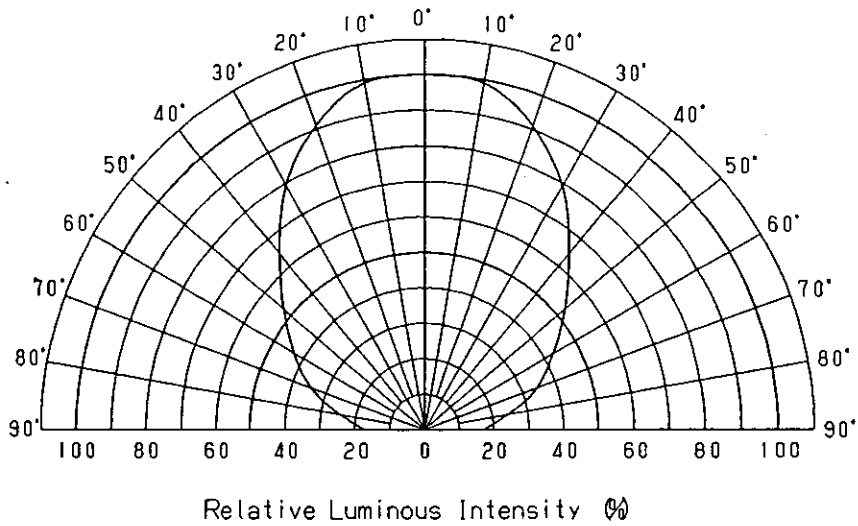

Nov. 7. 2001

Approved <i>T. Akeda</i>	Checked <i>M. Ni</i>	Designed <i>T. Taketa</i>	DEVELOPMENT SPECIFICATION (OUTLINE) P/N:	

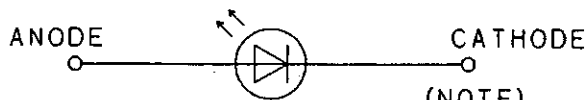
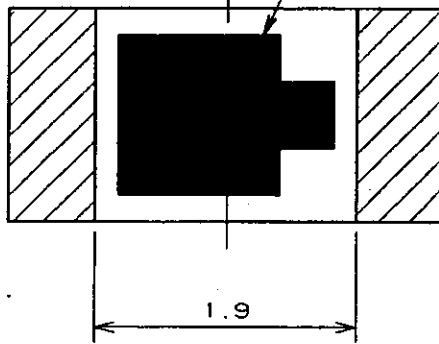
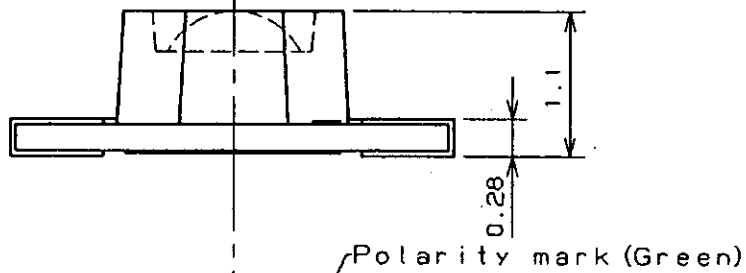
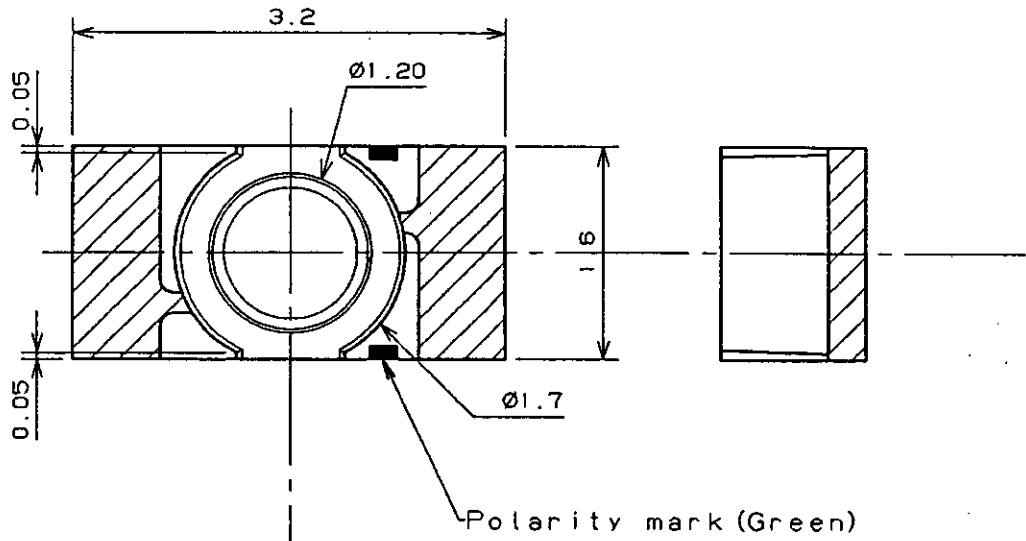

(NOTE)  
 1. Unit: mm  
 2. Tolerance unless specified is  $\pm 0.15$ .  
 3. indicate Au terminal.

Jan. 31. 2000			
---------------	--	--	--