

Approved	Checked	Designed	DEVELOPMENT SPECIFICATION					
		T. Tabata	P/N: LN J 4 1 6 C 8 4 R A				TEMPORARY	
T Y P E			Amber Light Emitting Diode					
A P P L I C A T I O N			Indicators					
M A T E R I A L			InGaAlP					
O U T L I N E			Attached					
A B S O L U T E M A X I M U M R A T I N G S			P	*I _{FP}	I _{FDC}	V _R	Topr	Tstg
			55	60	20	4	-30~+85	-40~+100
			mW	mA	mA	V	°C	°C
C O N D I T I O N			T _a = 25 ± 3°C					
Test Specification								
I t e m	Symbol	C o n d i t i o n	Typ	Limit		Unit		
				Min	Max			
Forward Voltage	V _F	I _F = 10 mA	2.0		2.5	V		
Reverse Leakage Current	I _R	V _R = 4 V			100	μA		
Luminous Intensity	I _O	I _F = 10 mA DC	26	13.8		mcd		
Peak Emission Wavelength	λ _p	I _F = 10 mA DC	595			nm		
Spectral Line Half Width	Δλ	I _F = 10 mA DC	15			nm		
<p>*1. The Condition of I_{FP} is duty 10 % , Pulse width 1 ms</p> <p>*2. Tolerance of luminous intensity : ±20%.</p>								
NOTE								
★1. Please contact the Panasonic local office if you design at low current (below 1mA DC) or pulse current operation and have any questions.								
★2. Soldering conditions.....Refer to Handling note.								
★3. Compositions of the lead Cu/Ni/Au plating								
★4. Beware of destruction by static electricity in handling the LED.								
★5. Circuit to operate LED.								
						(A) Recommended circuit.		
						(B) The difference of brightness between the LED could be found due to the V _F characteristics of each LED.		
Oct. 20. 2001								

Approved	Checked	Designed	DEVELOPMENT SPECIFICATION	TEMPORARY
		T. Tabata		

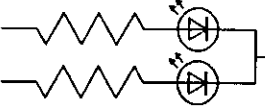
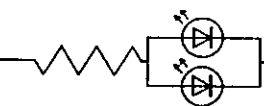
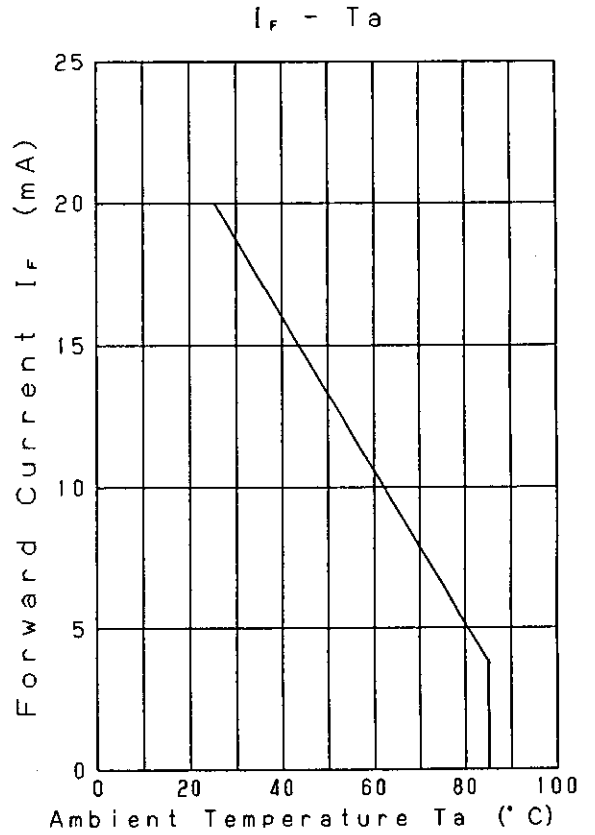
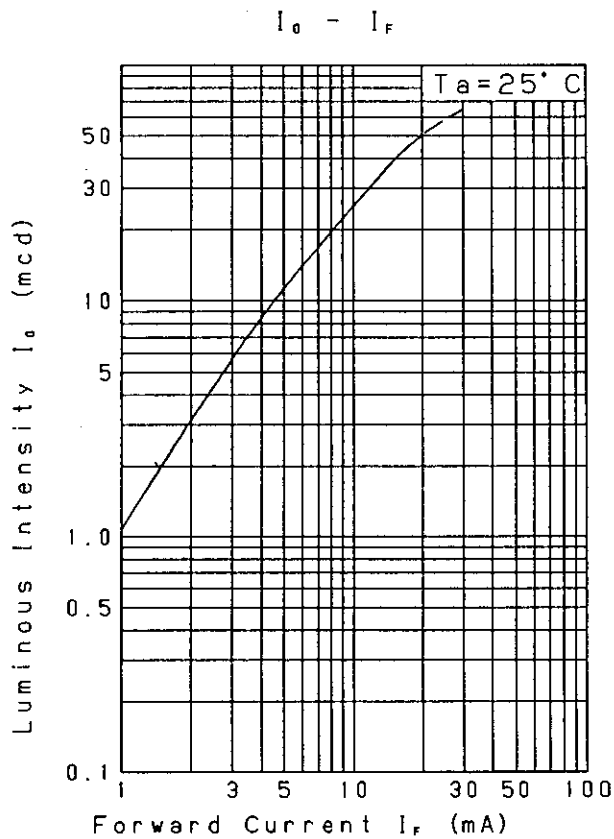
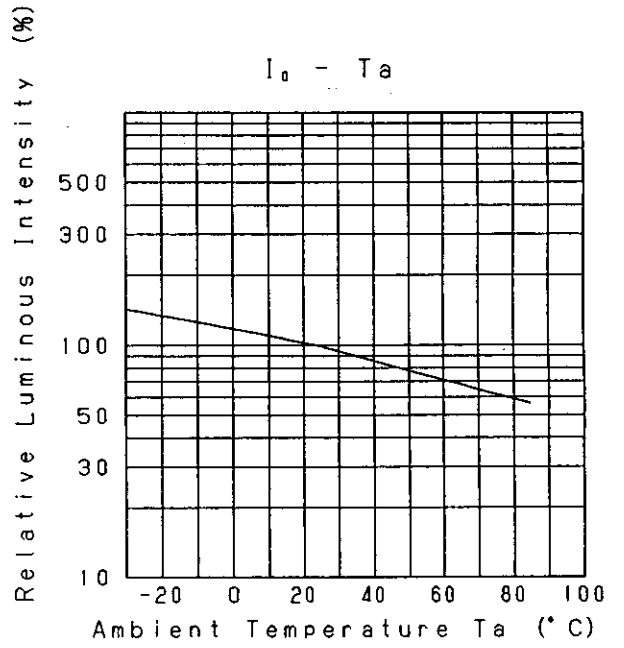
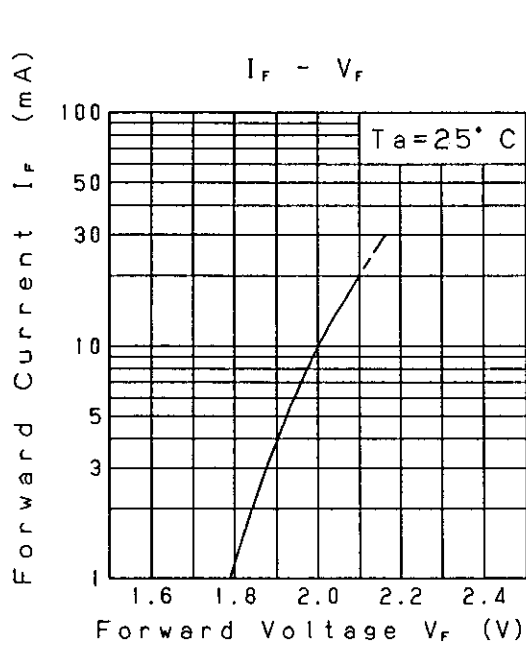

Oct.20.2001		
-------------	--	--

Approved	Checked	Designed	DEVELOPMENT SPECIFICATION	TEMPORARY	
		T. Tabata			

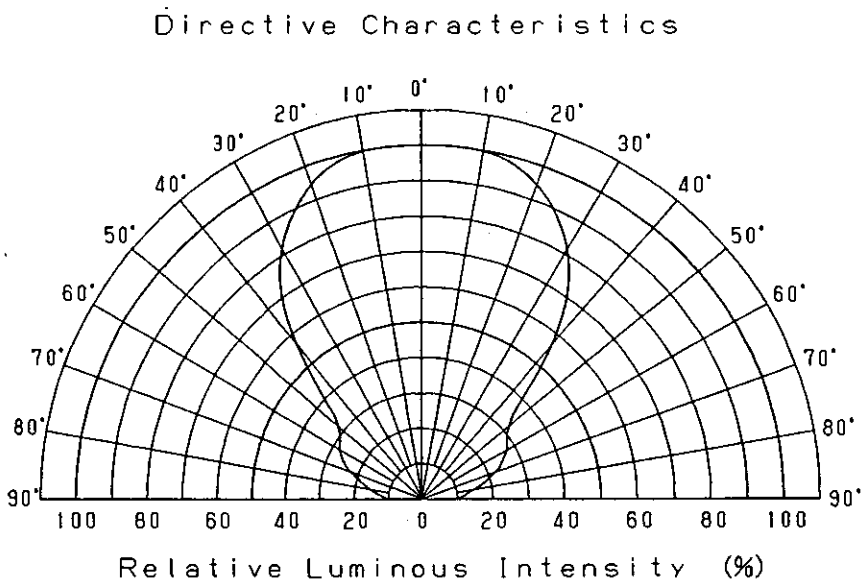
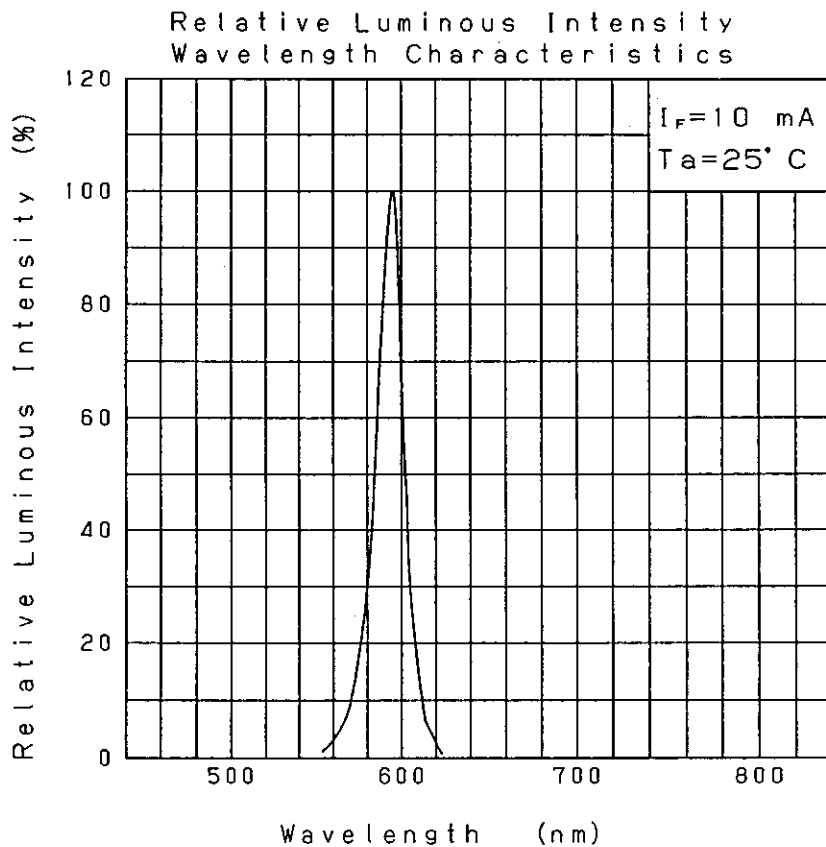

Oct.20.2001			
-------------	--	--	--

Approved <i>T. Akeda</i>	Checked <i>M. Ni</i>	Designed <i>T. Takata</i>	DEVELOPMENT SPECIFICATION (OUTLINE) P/N:	

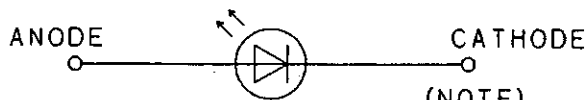
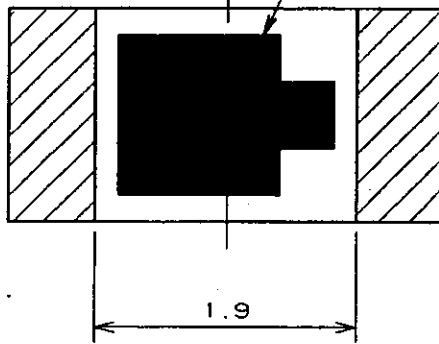
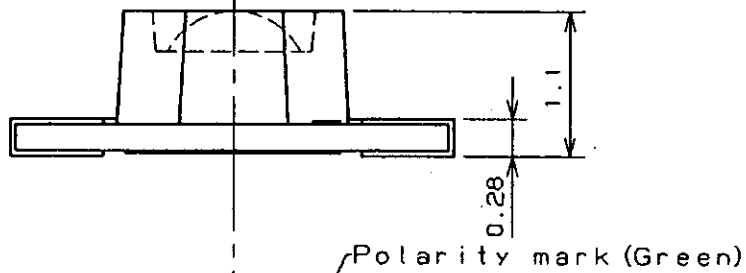
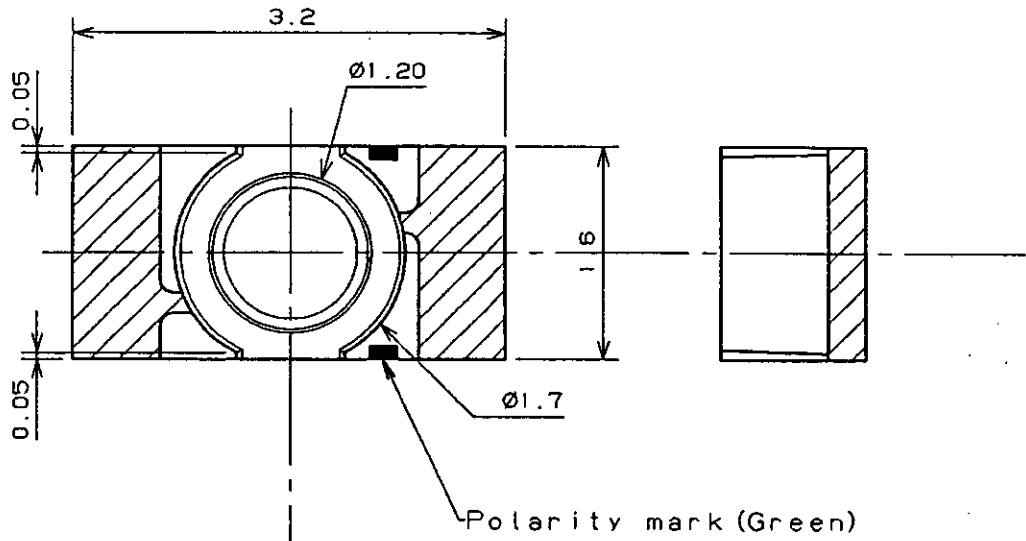

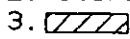
- (NOTE)
1. Unit: mm
 2. Tolerance unless specified is ± 0.15 .
 3.  indicate Au terminal.

Jan. 31. 2000			