

Workstation Multimedia Outlet (WMO)

A LANscape® Solutions Product

Corning
Cable Systems

Applications

- Voice, video and data in one outlet
- Modular furniture offices
- Fixed-wall offices
- Schools and hospitals
- Areas requiring an aesthetically pleasing outlet

Description

Corning Cable Systems Workstation Multimedia Outlet (WMO) is designed with an aesthetically pleasing look that blends in with modern office environment. The flexibility and capacity of the outlet set it apart from other outlets in the industry. The WMO accepts both fiber optic adapters and copper jacks.

Corning Cable Systems has designed the WMO to accept colored icons for labeling. This provides two benefits to the end-user. First, the colored icons allow for quick and easy line identification. Second, the colored icons make it easier to identify the connection from the outlet to the closet.

The WMO can be surface-mounted on a single-gang electrical box (2 x 4 in), or a dual-gang electrical box (4 x 4 in). Surface raceway can be inserted into each connector panel location or into the top of the unit. This allows for the large diversity of installation and cable routing methods.



Workstation Multimedia Outlet | Photo ICH95

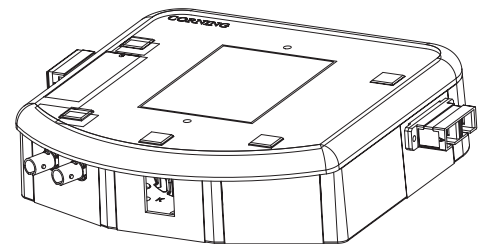

Workstation Multimedia Outlet (WMO);
shown closed | Drawing ZA-2803

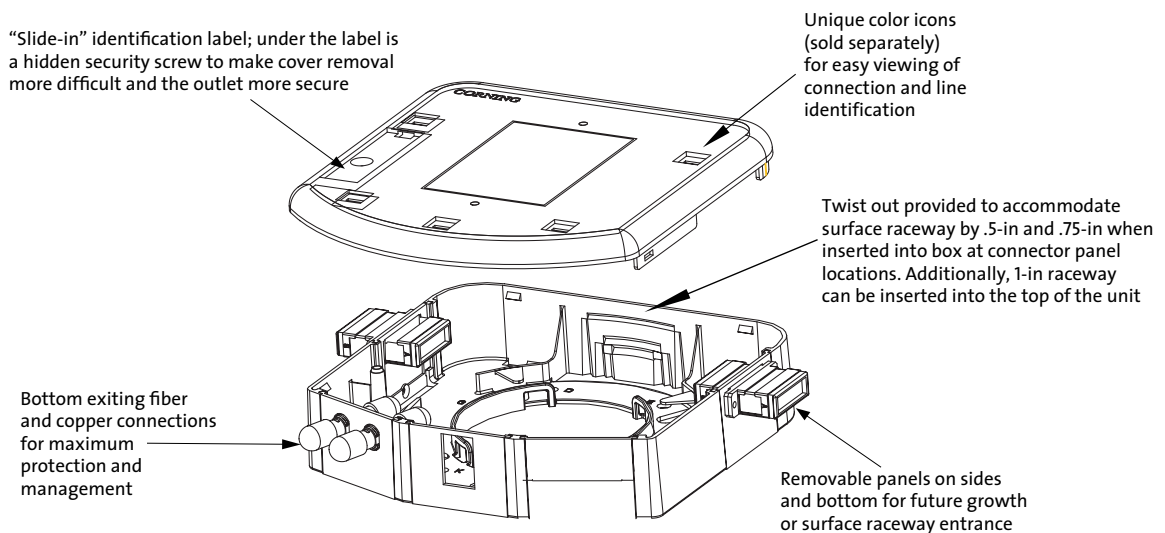

Workstation Multimedia Outlet (WMO);
shown open | Drawing ZA-2804

Workstation Multimedia Outlet (WMO)

A LANscape® Solutions Product

Corning
Cable Systems

Features / Benefits

- Flexibility in mounting: surface mount, single-gang or dual-gang electrical box
- 1/2-in and 3/4-in surface raceway can be run into box at all connector panel locations; additionally, 1-in raceway can be inserted into the top of the unit
- Factory-installed fiber optic adapters save time during installation
- Panels available for SC, ST® compatible, LC and MT-RJ connectors
- Cover contains a scored cut-out for mounting an industry standard single-gang face plate
- Internal routing guides provide protection of terminated and dark fibers and copper cabling
- The WMO accepts a maximum of five connector panels; standard configuration is three connector panels for “down the wall” routing
- Flammability rating of UL 94 V-0 and an oxygen index of 35 per ASTM D 2863
- Strain-relief provisions provided for incoming copper and fiber cables

Ordering Information

Outlets

Accepts up to five panels; supplied with five blank panels, each containing surface raceway twist outs.

Part Number	Dimensions (H x W x D) cm (in)	Weight g (oz)	Color
WMO-85	14.4 x 14.4 x 4.06 (5.7 x 5.7 x 1.6)	283.5 (10)	White
WMO-35	14.4 x 14.4 x 4.06 (5.7 x 5.7 x 1.6)	283.5 (10)	Beige

Workstation Multimedia Outlet (WMO)

A LANscape® Solutions Product

Corning
Cable Systems

Ordering Information (continued)

Fiber Optic Panels

WMO-CP0 - -
1 **2** **3**

Use the following options to construct the part number:

1 Select number of fiber connections per panel.

- 1 = One fiber connection per panel
- 2 = Two fiber connections per panel
- 4 = Four fiber connections per panel (SC duplex, LC duplex or MT-RJ)

2 Select adapter type.

Multimode

- 15T = ST® compatible, 62.5 µm, ceramic insert, threaded
- 25T = ST compatible, 62.5 µm, composite insert, threaded
- 91 = SC duplex, 62.5 µm, composite insert
- 97 = MT-RJ adapter, 62.5 µm,
- A8 = LC duplex, 62.5 µm, ceramic insert
- G7 = SC duplex, standard 50 µm, ceramic insert, black housing
- D3 = LC duplex, standard 50 µm, ceramic insert, black housing
- G1 = MT-RJ, standard 50 µm, black housing
- E1 = MT-RJ, LOMMF 50 µm, aqua housing
- E4 = LC duplex, LOMMF 50 µm, ceramic insert, aqua housing
- E7 = SC duplex, LOMMF 50 µm, ceramic insert, aqua housing

Single-mode

- 19T = ST compatible, ceramic insert, threaded
- 59 = SC duplex, ceramic insert
- 98 = MT-RJ adapter
- A9 = LC duplex, ceramic insert

3 Select color.

- 35 = Beige
- 85 = White

Copper Connection Panels

Part Number	Description
WMO-CP02-AX-35	Connector Panel with two cut-outs 0.582 x 0.816 inches, no jacks installed, beige
WMO-CP02-AX-85	Connector Panel with two cut-outs 0.582 x 0.816 inches, no jacks installed, white

Icons

Must be ordered separately; supplied with blank icons in color that matches the outlet color.

Part Number Example

Part Number	Description
WMO-CP04-91-85	Connector Panel with two factory-installed SC Duplex multimode adapters with composite inserts; white

Workstation Multimedia Outlet (WMO)

A LANscape® Solutions Product

Corning
Cable Systems

Corning Cable Systems LLC • PO Box 489 • Hickory, NC 28603-0489 USA

1-800-743-2675 • FAX: +1-828-901-5973 • International: +1-828-901-5000 • <http://www.corning.com/cablesystems>

Corning Cable Systems reserves the right to improve, enhance and modify the features and specifications of Corning Cable Systems products without prior notification. LANscape is a registered trademark of Corning Cable Systems Brands, Inc. Discovering Beyond Imagination is a trademark of Corning Incorporated. ST is a registered trademark of Lucent Technologies. All other trademarks are the properties of their respective owners. Corning Cable Systems is ISO 9001 certified. © 1999, 2005 Corning Cable Systems. All rights reserved. Published in the USA.

LAN-48-EN / June 2005 / pdf



CORNING
Discovering Beyond Imagination

LANscape
Fiber Cabling Solutions for Premises Networks