

Power Supply

PS/2 Type-Specification

Model No.	Rating(Max.)	Input Range(VAC)	Frequency(Hz)	DC Load Requirement												Safety
				+3.3V		+5V		+12V		-5V		-12V		6VSB		
				Max.	Min.	Max.	Min.	Max.	Min.	Max.	Min.	Max.	Min.	Max.	Min.	
IPS-ZKS-250AE	250W (AT)	90 ~ 135 or 180 ~ 265	47 ~ 63			25A	2.5A	10A	1A	0.5A	0A	0.5A	0A			CE, UL, TUV
IPS-ZKS-300W	300W (AT)	90 ~ 135 or 180 ~ 265	47 ~ 63			30A	3.0A	12A	1.2A	0.5A	0A	0.5A	0A			CE, UL, TUV
IPS-SP2-4400	400W (AT)	90 ~ 135 or 180 ~ 265	47 ~ 63			40A	7A	15A	2.5A	1A	0A	1A	0A			CE, UL, TUV
IPS-ZKS-250WX-B	250W (ATX)	90 ~ 135 or 180 ~ 265	47 ~ 63	14A	1A	25A	2.5A	10A	1A	0.5A	0A	0.5A	0A	1.5A	0A	CE, UL, TUV
IPS-ZKS-300WX	300W (ATX)	90 ~ 135 or 180 ~ 265	47 ~ 63	20A	2A	30A	3A	12A	1.2A	0.5A	0A	1A	0A	1.5A	0A	CE, UL, TUV
IPS-ZKS-300WX-A	300W (ATX)	90 ~ 265 (AUTO)	47 ~ 63	20A	2A	30A	3A	12A	1.2A	0.5A	0A	1A	0A	1.5A	0A	CE, UL, TUV
IPS-ZKS-400WX	400W (ATX)	90 ~ 135 or 180 ~ 265	47 ~ 63	35A	3.5A	45A	5A	15A	1.5A	1A	0A	1A	0A	3A	0A	CE, UL, TUV

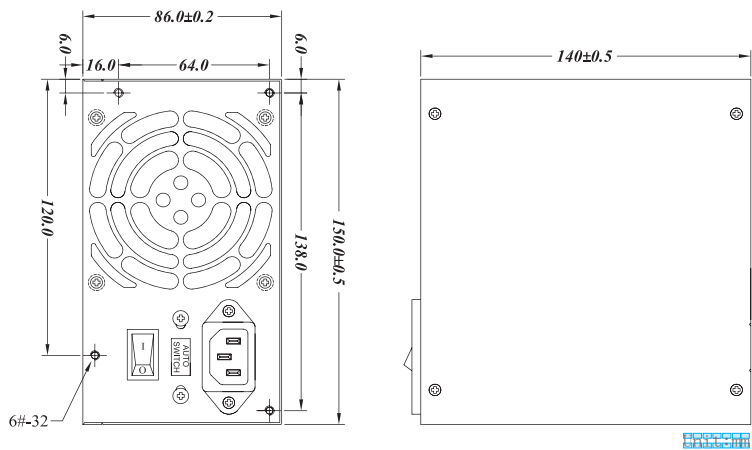

Switching Power Adapter-Specification

Model No.	Rating(Max.)	Input Range(VAC)	Frequency(Hz)	DC Load Requirement						Connector	Safety				
				+3.3V		+5V		+12V				-5V		-12V	
				Max.	Min.	Max.	Min.	Max.	Min.			Max.	Min.	Max.	Min.
PAD-3A-501DN12	48W	90 ~ 265 (AUTO)	47 ~ 63			4.2A	0A					A	UL, CUL, GS		
PAD-STD-1205	60W	90 ~ 265 (AUTO)	47 ~ 63			5A	0A					A	UL, CUL, GS		
PAD-SPD-050-D1	50W	90 ~ 265 (AUTO)	47 ~ 63			6A	0.3A	2A	0A			B	UL, CSA, TUV		
PAD-PW-060A-2YD	60W	90 ~ 265 (AUTO)	47 ~ 63			7A	0.5A	3A	0A			B	UL, CSA, TUV		

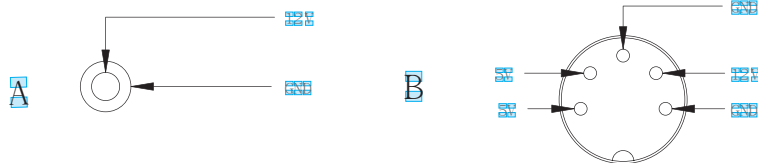

All specifications are subject to change without notice.

Computer
on Module

Embedded
Motherboard

Slot
Computing

Industrial
Motherboard

Wide
Temperature

Cable Kit / Cooling Kit
/SSC Daughter Board
/Power Converter

Rugged
Tablet PC

HMI / HMC

Box PC

Mobile DVR

Network
Communication
Appliance

Industrial Chassis
/ Backplane
Power supply



Power Supply

1U Type-Specification

Model No.	Rating(Max.)	Input Range(VAC)	Frequency(Hz)	DC Load Requirement												Safety
				+3.3V		+5V		+12V		-5V		-12V		5VSB		
				Max.	Min.	Max.	Min.	Max.	Min.	Max.	Min.	Max.	Min.	Max.	Min.	
IPS-P1U-6150P	150W (ATX)	90 ~ 264 (AUTO)	47 ~ 63	10A	1A	14A	2A	6A	1A	0.5A	0A	0.8A	0A	1.5A	0A	CE, UL, TUV
IPS-P1A-6200P	200W (ATX)	90 ~ 264 (AUTO)	47 ~ 63	14A	1A	25A	3A	8A	2A	0.5A	0A	0.5A	0A	1.5A	0A	CE, UL, TUV
IPS-P1G-6300P	300W (ATX)	90 ~ 264 (AUTO)	47 ~ 63	14A	1A	25A	3A	16A	2A	0.5A	0A	1A	0A	1.5A	0A	CE, UL, TUV
IPS-PIG-6250P	250W(ATX)	90 ~ 264 (AUTO)	47 ~ 63	14A	1A	25A	3A	12A	2A	0.5A	0A	1A	0A	1.5A	0A	CE, UL, TUV
IPS-PIG-6300P	300W(ATX)	90 ~ 264 (AUTO)	47 ~ 63	20A	1A	24A	3A	20A	2A	0.5A	0A	1A	0A	1.5A	0A	CE, UL, TUV
IPS-FSP200-50PLA	200W(ATX)	100 ~ 264 (AUTO)	50 ~ 60	16A	0.3A	12A	0.3A	12A	1.5A	0A	0A	0.8A	0A	2A	0A	CE, UL, TUV



IPS-P1U-6150P



IPS-P1A-6200P



IPS-P1G-6300P

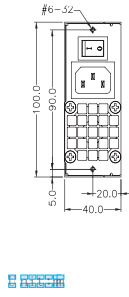
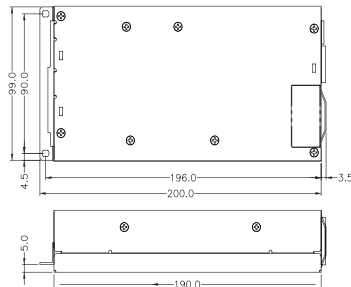
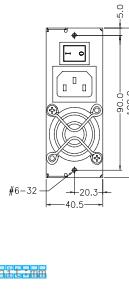
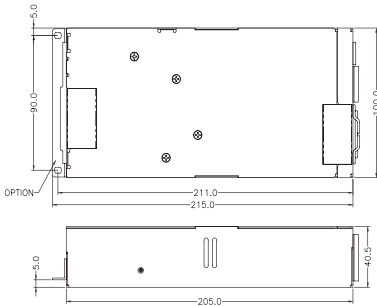

Open Frame-Specification

Model No.	Rating(Max.)	Input Range(VAC)	Frequency(Hz)	DC Load Requirement								Safety		
				+3.3V		+5V		+12V		-5V			-12V	
				Max.	Min.	Max.	Min.	Max.	Min.	Max.	Min.		Max.	Min.
IPS-SNP-8071-A	70W	90 ~ 264 (AUTO)	47 ~ 63			10A	0A	1.5A	0A			0.3A	0A	UL, CSA, VDE
IPS-SNP-Z101	110W	90 ~ 264 (AUTO)	47 ~ 63			15A	0A	5A	0A			0.5A	0A	UL, CSA, VDE
IPS-SNP-Z103	100W	90 ~ 264 (AUTO)	47 ~ 63			7A	0A	8A	0A					

Computer
on Module

Embedded
Mini-board

Slot
Computing

Industrial
Motherboard

Wide
Temperature

Cable Kit/ Cooling Kit
/ SBC Daughter Board
/ Power Converter

Rugged
Tablet PC

HMI / HMC

Box PC

Mobile DVR

Network
Communication
Appliance

Industrial Chassis
/ Backplane
Power supply

Power Supply

Redundant-Specification

Model No.	Rating(Max.)	Input Range(VAC)	Frequency(Hz)	DC Load Requirement										Safety		
				+3.3V		+5V		+12V		-5V		-12V			5VSB	
				Max.	Min.	Max.	Min.	Max.	Min.	Max.	Min.	Max.	Min.		Max.	Min.
IPS-R2G-6300F	300W+300W(ATX)	90 ~ 135 or 180 ~ 265	47 ~ 63	20A	1A	32A	3A	16A	2A	0.5A	0A	0.8A	0A	1.5A	0A	UL, TUV, CB

IPS-R2G-6300F

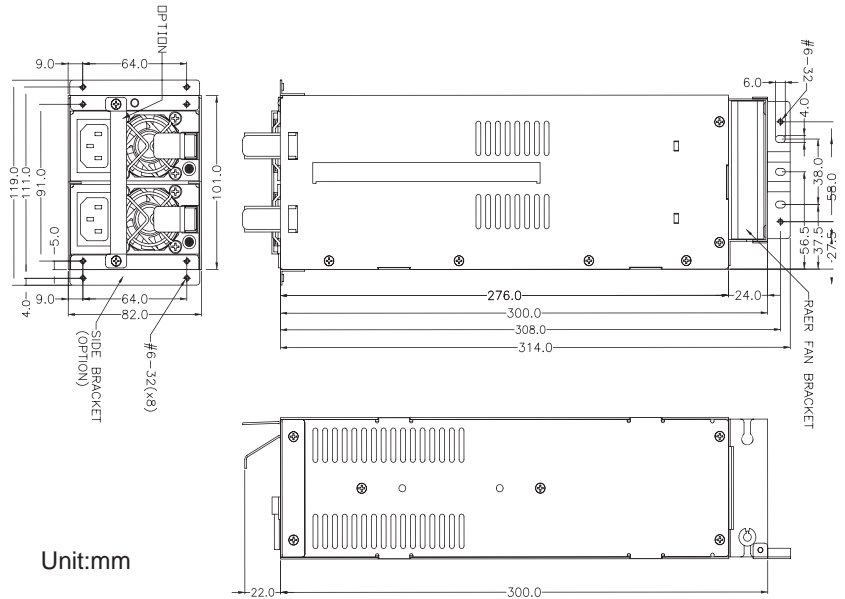

Unit:mm

Model No.	Rating(Max.)	Input Range(VAC)	Frequency(Hz)	DC Load Requirement										Safety
				+3.3V		+5V		+12V		-5V		-12V		
				Max.	Min.	Max.	Min.	Max.	Min.	Max.	Min.	Max.	Min.	
IPS-RHH-6400F	400W+400W(ATX)	95 ~ 264	47 ~ 63	28A	1A	35A	5A	20A	2.5A	0.8A	0A	1A	0A	UL, TUV, CB
IPS-RHH-6460F	460W+460W(ATX)	95 ~ 264	47 ~ 63	30A	1A	40A	5A	32A	2.5A	0.8A	0A	1A	0A	UL, TUV, CB

IPS-RHH-6400F

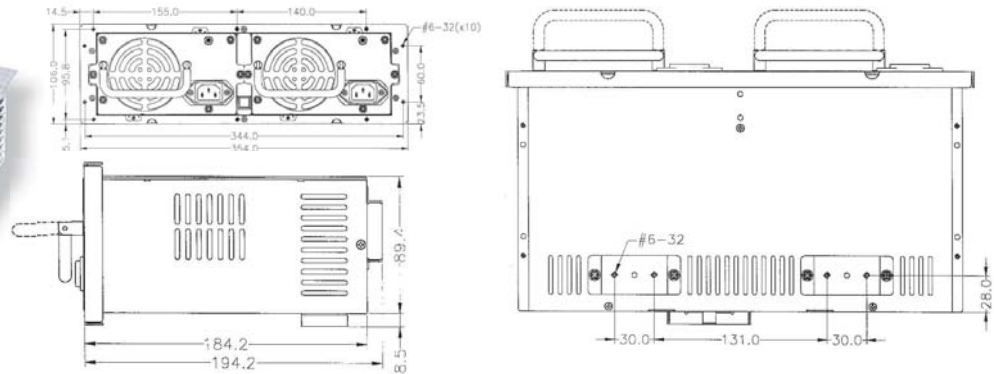

Unit:mm

All specifications are subject to change without notice.

Computer
on Module

Embedded
Motherboard

Slot
Computing

Industrial
Motherboard

Wide
Temperature

Cable Kit / Cooling Kit
/SSC Daughter Board
/Power Converter

Rugged
Tablet PC

HMI / HMC

Box PC

Mobile DVR

Network
Communication
Appliance

Industrial Chassis
/ Backplane
Power supply



Power Supply

PS2 Mini Redundant-Specification

DC Load Requirement

Model No.	Rating(Max.)	Input Range(VAC)	Frequency(Hz)	+3.3V		+5V		+12V		-5V		-12V		5VSB		Safety
				Max.	Min.	Max.	Min.	Max.	Min.	Max.	Min.	Max.	Min.			
IPS-MR2-250	250W+250W (AT)	90 ~ 135 or 180 ~ 265	47 ~ 63			25A	4A	10A	1.5A	0.5A	0A	0.5A	0A			UL, TUV, CB

DC Load Requirement

Model No.	Rating(Max.)	Input Range(VAC)	Frequency(Hz)	+3.3V		+5V		+12V		-5V		-12V		5VBS		Safety
				Max.	Min.	Max.	Min.	Max.	Min.	Max.	Min.	Max.	Min.			
IPS-TC-300R8	300W+300W (ATX)	90 ~ 135 or 180 ~ 265	47 ~ 63	24A	0.3A	30A	3A	15A	2A	0.5A	0A	0.8A	0A	2A	0A	UL, TUV, CB
IPS-TC-400R8	300W+400W (ATX)	90 ~ 135 or 180 ~ 265	47 ~ 63	24A	0.3A	35A	3A	18A	2A	0.5A	0A	0.8A	0A	2A	0A	UL, TUV, CB



IPS-TC-400R8

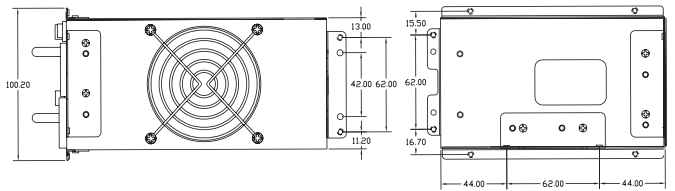
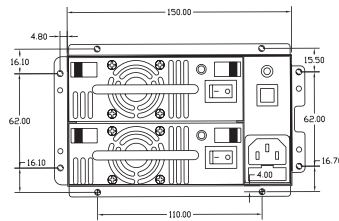
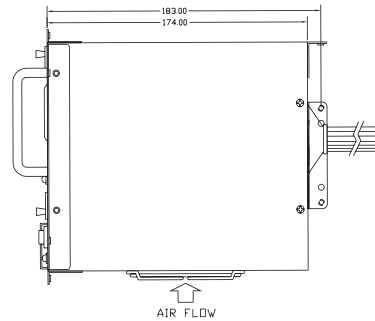

Unit:mm

All specifications are subject to change without notice.

Computer on Module

Embedded Mini-board

Slot Computing

Industrial Motherboard

Wide Temperature

Cable Kit / Cooling Kit / SBC Daughter Board / Power Converter

Rugged Tablet PC

HMI / HMC

Box PC

Mobile DVR

Network Communication Appliance

Industrial Chassis / Backplane Power supply