

# ACE-N023C

24VDC Input 30W Power Supply

Power Supply



## SPECIFICATIONS

- ◆ Input Voltage : 18V~32V DC
- ◆ Output Rating : +5V / 4A , +12V / 0.75A
- ◆ Ripple and Noise : Less than 1% of each output at rated load
- ◆ Load Regulation : +5V less than +/- 1% , +12V less than +/- 4%
- ◆ Efficiency : 74%
- ◆ Protection : Over voltage/Load protection and short circuit protection
- ◆ TTL signal compatible power good signal
- ◆ MTBF: 100,000hrs at 25°C
- ◆ Vibration : 10-55Hz at 2G , 3min period , 30min along X,Y and Z axis
- ◆ Shock : 10G for 11ms once on each X,Y and Z axis
- ◆ Safety : Meets UL 60950 , CSA 22.2 NO.234 , VDE EN60950
- ◆ EMI : Meets FCC docket 20780 Class "B" , EN 55022 "B"
- ◆ EMC : Meets EN 61000-4-2 8KV air discharge criterion B  
EN 61000-4-3 3V/M criterion A  
EN 61000-4-4 2KV criterion B
- ◆ Operating temperature : 0~50°C
- ◆ Storage temperature : -40~85°C
- ◆ Dimensions : 114(W)x23(H)x52(D)mm

## Pin Define

PIN	TB1	TB2
1	E	+12V
2	+	+5V
3	-	+5V
4		GND
5		GND

## Dimensions

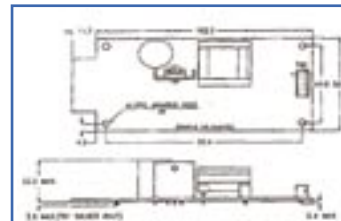

## ORDERING INFORMATION

- ACE-N023C 24VDC Input 30W Power Supply

# ACE-905A

40W Embedded ATX Power Supply



## SPECIFICATIONS

Designed to provide Embedded SBC (for example Wafer-5821) 5Vsb and PS-ON signal interface for Wake-on-Lan ,Wake-on-Modem ...etc advance functions.

- ◆ Input : 90V-264VAC, Molex 5273-05A type connector
- ◆ Output Rating : standard ATX power connector +5V : Max. 5A +12V : Max. 3A 5Vsb : 0.5A  
Total Output of +5V and +12V shall not exceed 40W.
- ◆ Hold-up time : 20ms min. at 115VAC
- ◆ Efficiency : 74% typ.
- ◆ Protection : Over Voltage/Load Protection and Short Circuit Protection
- ◆ Power On(PS-ON) signal provided
- ◆ Vibration : 10-55Hz at 2G 3min. period, 30 min. along X,Y and Z axis.
- ◆ Shock : 10G for 11ms once on each X,Y and Z axis.
- ◆ MTBF : over 100,000hrs at 25°C
- ◆ Safety : Meets UL 1950 , CSA 22.2 Level 3, TUV
- ◆ EMI : Meets FCC class "B", EN55022 class "B"
- ◆ EMS Standard : meets
  - IEC 801-2 8KV(Air Discharge)
  - IEC 801-3 3V/M criteria A
  - IEC 801-4, 2KV criteria B
  - IEC 801-5, 2KV criteria B
- ◆ Operating temperature. : 0~50°C

## Dimensions

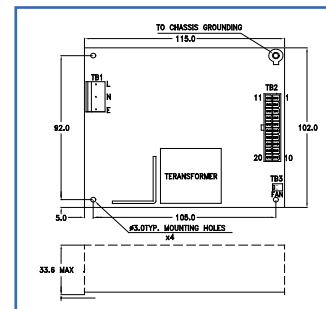

## ORDERING INFORMATION

- ACE-905A 40W Embedded ATX Power Supply

# ACE-540A

24V DC Output Industrial Power Supply



## SPECIFICATIONS

- ◆ Input : Voltage : 85 ~ 264V AC
- ◆ Output : 2A@24V DC, 50oC with 20CFM air cooling  
1.7A@24V DC, 50oC with free air cooling
- ◆ Load Regulation : Less than 1% by changing the output
- ◆ Efficiency : Higher than 70%
- ◆ Hold-up Time : 20ms (typical)@115V AC
- ◆ Protection : Over voltage protection.  
The trip point is around 26.2V ~ 31V output
- ◆ Operating temperature : -20° ~ 70°C  
(Will derate the output to 70% when operating at 70°C)
- ◆ Storage temperature : -40° ~ 85°C
- ◆ Altitude : 0 ~ 10,000ft
- ◆ MTBF : 396,220 Hours.
- ◆ Safety : UL 1950, meets CE
- ◆ EMI : FCC docket 20780 curve "B", EN55022
- ◆ EMS Standard :
  - EN-50082-1
  - IEC 801-2 8KV (Air Discharge) criteria B
  - IEC 801-3, 3V/M criteria B
  - IEC 801-4, 2KV criteria B
  - IEC 801-5, 2KV criteria B



## Dimensions

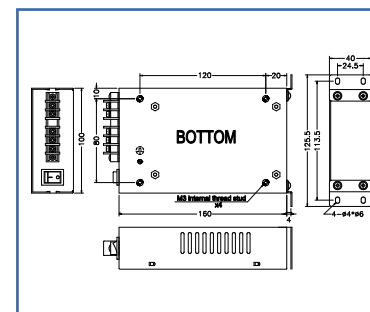

## ORDERING INFORMATION

- ACE-540A 24V DC Output Industrial Power Supply