

Compact Universal Tongue-Operated Safety Interlock Switch

- Strong and versatile—the compact size of the strong, glass-filled polyester housing can be used in many applications
- NEMA 6 enclosure enables these switches to withstand water washdown cleaning
- Rotatable head gives four possible actuator entry points for versatile installation. A blanking plug is supplied for the unused entry.
- Small swing radius allows use on doors with a swing radius as small as 64 mm (2.5 in.) when using the optional flexible 1 actuator with alignment guide
- Vibration resistant—optional catch and retainer keeps vibrating guard doors shut, preventing unwanted opening of guard doors on vibrating machines
- Long life—these switches, with their stainless steel actuators, are designed for a minimum of one million actuations
- Optional connector makes installation quick and easy
- An optional stainless steel head is available



Conforms to EN1088, EN292, EN60947-5-1, EN60204-1
UL and C-UL listed

G

Specifications

| Electrical | All Models |
|---------------------------------------|--|
| Contact Configurations: | 2 N/C or 1 N/C + 1 N/O |
| Safety Contacts: | 2 N/C or 1 N/C positive break |
| Switching Ability | AC: 500 V – 1 A, 250 V – 2 A, 100 V – 5 A DC: 250 V – 0.5 A, 24 V – 2 A |
| Safety Contact Gap: | > 2 mm (0.079 in.) |
| Auxiliary Contacts: | 1 N/O (only with 1 N/C safety version) |
| Max Switching Current/Volt/Amp: | 500 V/500 VA |
| Minimum Current: | 5 V 5 mA DC |
| Electrical Life: | 1 x 10 ⁶ minimum |
| Mechanical | |
| Mounting: | Any position |
| Mounting Hardware: | 2 x M5 screws |
| Actuator Travel for Positive Opening: | 6 mm (0.236 in.) |
| Min Operating Radius: | 60 mm (2.5 in.) with Flex 1 actuator; 175 mm (6.89 in.) with standard actuator |
| Break Contact Min Force: | 30 N (6.7 lb.) |
| Max Actuation Speed: | 160 mm/sec (6.30 in./sec) |
| Max Actuation Frequency: | 2 cycles/sec |
| Case Material: | UL listed, glass-filled polybutylene terephthalate (PBT), optional stainless steel head |
| Actuator Material: | Stainless steel |
| Wiring Entry: | 3 x M20 conduit with 0.5 in. NPT adapter, or Brad Harrison connector type BG 16881-008, 4 pole male, M12 |
| Weight: | 120 g (4 oz.) |
| Color: | Red |
| Mechanical Life: | 1 x 10 ⁶ minimum |
| Environmental | |
| Protection: | IP67 (NEMA 6) |
| Operating Temperature: | -20 to 80°C (-4 to 176°F) |
| Cleaning: | Water washdown |
| Compliance | |
| Standards: | EN1088, EN292, EN60947-5-1, EN60204-1 |
| Approvals/Listings: | CE marked for all applicable directives, UL and C-UL |

Specifications are subject to change without notice.

Note: The safety contacts of the Omron STI switches are described as normally closed (N/C)—i.e., with the guard closed, actuator in place, and the machine able to be started.

Operation

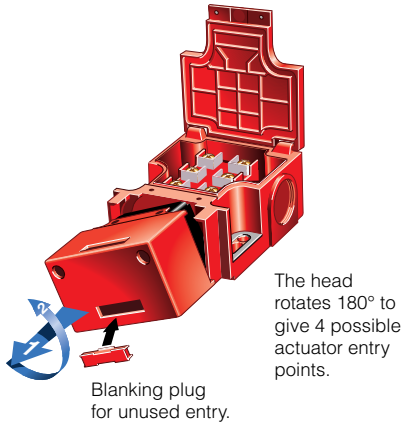

Optional Catch & Retainer

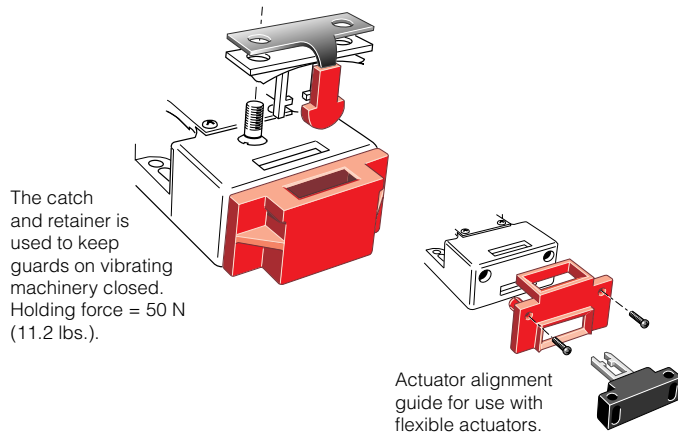

Optional Alignment Guide & Flexible Actuators

G

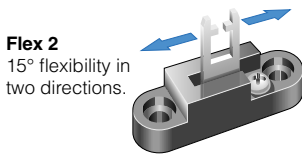
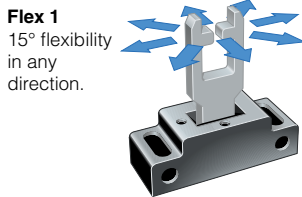

Optional SLD Series

Optional switch locking devices are available. See accessories section for details.



Optional Connector

4-Pin Male, Micro DC, M12
Safety Circuit 1 (N/C)

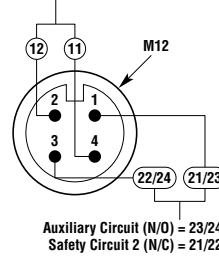

Contact Arrangements

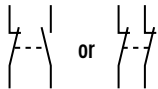

Actuator withdrawal distance from full insertion

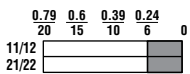

□ Contact Open ■ Contact Closed

Actuator withdrawal distance from full insertion: type BBM (Break Before Make Contact)

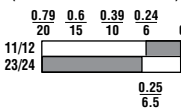

□ Contact Open ■ Contact Closed

Minimum Operating Radius Front-Entry (Std Actuator)

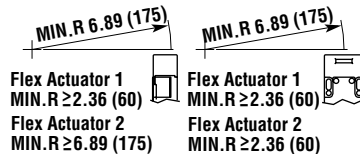

Minimum Operating Radius End-Entry (Std Actuator)

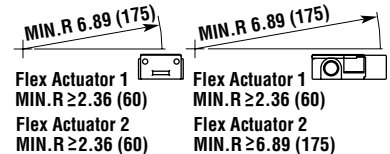

Applications

Typical applications are on sliding guard doors or swinging guard doors.

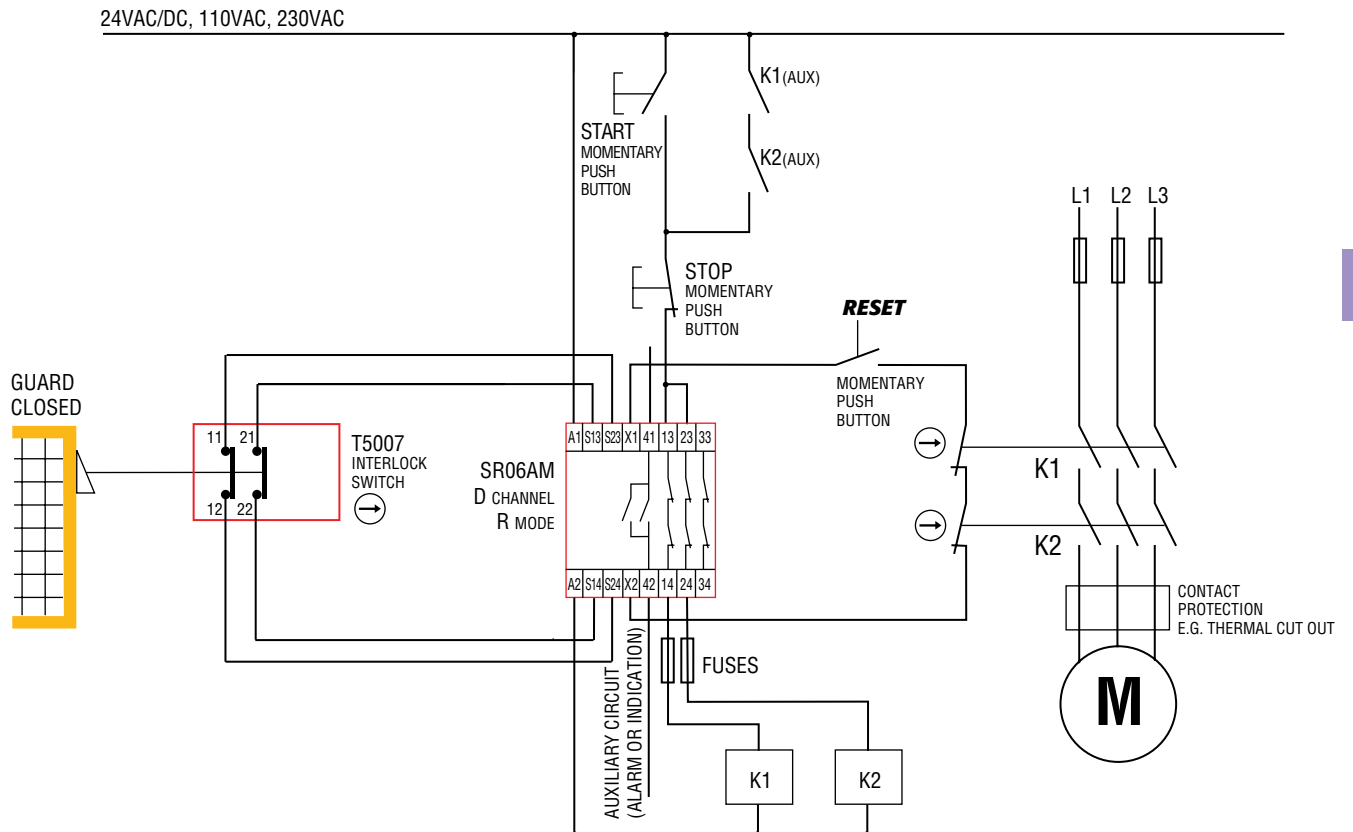
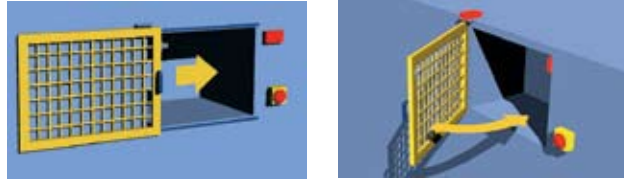

For a full explanation of the circuit operating principle and fault detection, see "Common Circuit Examples" in The Safety Library Section of this catalog.

Dimensions

(mm/in.)

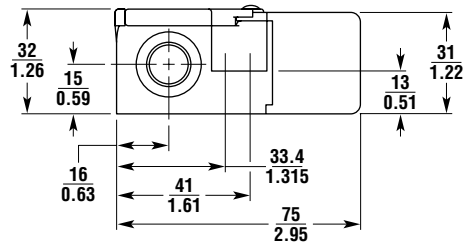
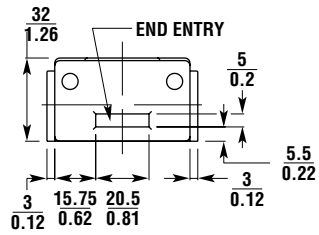

CATCH CASE

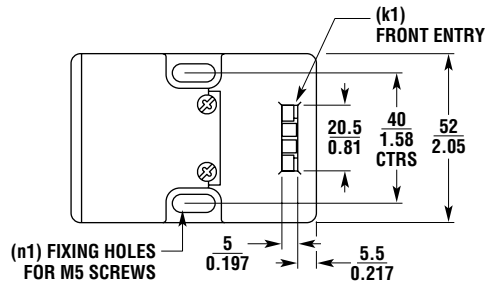
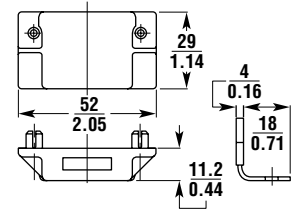

CATCH RETAINER

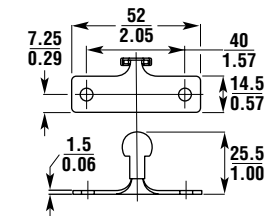

G

STANDARD ACTUATOR

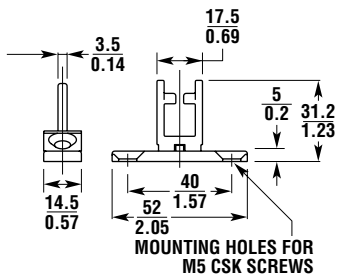

FLEX 1 ACTUATOR

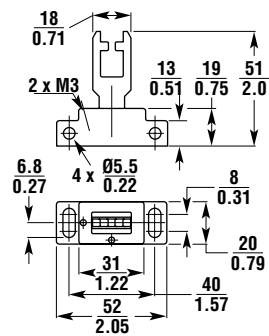

FLEX 2 ACTUATOR

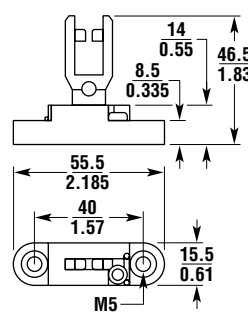

ALIGNMENT GUIDE FOR FLEX ACTUATORS

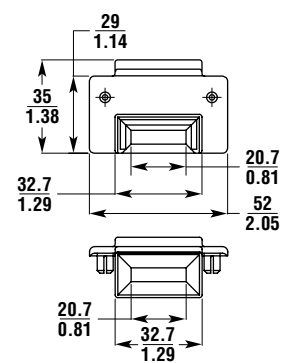

Ordering

| Model | Contacts | Wiring Entry | Part No. |
|---|-------------|--------------------------|------------|
| T5007 Standard Actuator | | | |
| T5007-11SM | 1N/C + 1N/O | 3 x M20 with NPT adapter | 44526-0010 |
| T5007-11SCC | 1N/C + 1N/O | cable connector | 44526-0012 |
| T5007-02SM | 2N/C | 3 x M20 with NPT adapter | 44526-0020 |
| T5007-02SCC | 2N/C | cable connector | 44526-0022 |
| T5007-11FSSM (Stainless head, front entry) | 1N/C + 1N/O | 3 x M20 with NPT adapter | 44526-1010 |
| T5007-11RSSM (Stainless head, rear entry) | 1N/C + 1N/O | 3 x M20 with NPT adapter | 44526-1011 |
| T5007-11FSSCC (Stainless head, front entry) | 1N/C + 1N/O | cable connector | 44526-1012 |
| T5007-11RSSCC (Stainless head, rear entry) | 1N/C + 1N/O | cable connector | 44526-1013 |
| T5007-02FSSM (Stainless head, front entry) | 2N/C | 3 x M20 with NPT adapter | 44526-1020 |
| T5007-02RSSM (Stainless head, rear entry) | 2N/C | 3 x M20 with NPT adapter | 44526-1021 |
| T5007-02FSSCC (Stainless head, front entry) | 2N/C | cable connector | 44526-1022 |
| T5007-02RSSCC (Stainless head, rear entry) | 2N/C | cable connector | 44526-1023 |
| T5007 Flex Actuator (Flex 1) | | | |
| T5007-11F1M | 1N/C + 1N/O | 3 x M20 with NPT adapter | 44526-0110 |
| T5007-11F1CC | 1N/C + 1N/O | cable connector | 44526-0112 |
| T5007-02F1M | 2N/C | 3 x M20 with NPT adapter | 44526-0120 |
| T5007-02F1CC | 2N/C | cable connector | 44526-0122 |
| T5007-11FF1SM (Stainless head, front entry) | 1N/C + 1N/O | 3 x M20 with NPT adapter | 44526-1110 |
| T5007-11RF1SM (Stainless head, rear entry) | 1N/C + 1N/O | 3 x M20 with NPT adapter | 44526-1111 |
| T5007-11FF1SCC (Stainless head, front entry) | 1N/C + 1N/O | cable connector | 44526-1112 |
| T5007-11RF1SCC (Stainless head, rear entry) | 1N/C + 1N/O | cable connector | 44526-1113 |
| T5007-02FF1SM (Stainless head, front entry) | 2N/C | 3 x M20 with NPT adapter | 44526-1120 |
| T5007-02RF1SM (Stainless head, rear entry) | 2N/C | 3 x M20 with NPT adapter | 44526-1121 |
| T5007-02FF1SCC (Stainless head, front entry) | 2N/C | cable connector | 44526-1122 |
| T5007-02RF1SCC (Stainless head, rear entry) | 2N/C | cable connector | 44526-1123 |
| T5007 Semi-Flex Actuator (Flex 2) | | | |
| T5007-11F2M | 1N/C + 1N/O | 3 x M20 with NPT adapter | 44526-0210 |
| T5007-11F2CC | 1N/C + 1N/O | cable connector | 44526-0212 |
| T5007-02F2M | 2N/C | 3 x M20 with NPT adapter | 44526-0220 |
| T5007-02F2CC | 2N/C | cable connector | 44526-0222 |
| T5007-11FF2SM (Stainless head, front entry) | 1N/C + 1N/O | 3 x M20 with NPT adapter | 44526-1210 |
| T5007-11RF2SM (Stainless head, rear entry) | 1N/C + 1N/O | 3 x M20 with NPT adapter | 44526-1211 |
| T5007-11FF2SCC (Stainless head, front entry) | 1N/C + 1N/O | cable connector | 44526-1212 |
| T5007-11RF2SCC (Stainless head, rear entry) | 1N/C + 1N/O | cable connector | 44526-1213 |
| T5007-02FF2SM (Stainless head, front entry) | 2N/C | 3 x M20 with NPT adapter | 44526-1220 |
| T5007-02RF2SM (Stainless head, rear entry) | 2N/C | 3 x M20 with NPT adapter | 44526-1221 |
| T5007-02FF2SCC (Stainless head, front entry) | 2N/C | cable connector | 44526-1222 |
| T5007-02RF2SCC (Stainless head, rear entry) | 2N/C | cable connector | 44526-1223 |
| Accessories | | | |
| Spare Standard Actuator for T5007 | | | 44526-0700 |
| Spare Standard Actuator for Stainless Head | | | 44519-0700 |
| Spare Flex 1 Actuator with plastic guide | | | 44519-0710 |
| Spare Flex 2 Actuator with plastic guide | | | 44501-0780 |
| Spare Alignment Guide (Plastic) | | | 44501-0770 |
| Mechanical Catch Kit (use with standard actuator only and with plastic head only) | | | 44501-0740 |
| Lockoff Actuator for T5007 | | | 44512-0700 |
| Spare M20 to 0.5 in. NPT adapter | | | 44512-0110 |
| M20 Cord Grip | | | 44512-0090 |

G

 = Highlighted **Rapid Delivery** products are available for shipment today or within **FIVE** days.