



GAI-TRONICS® CORPORATION  
A HUBBELL COMPANY

# 723-001 Remote Handset/Speaker Amplifier

## General Information

This data sheet applies to the 723-001 Remote Handset/Speaker Amplifier, which is used with GAI-Tronics desktop, desk-edge, and flush-mount stations. It has been designed to be remotely mounted within an enclosure, allowing the associated subsets to be placed on a desktop, mounted on the side of a desk, or to be flush-mounted.

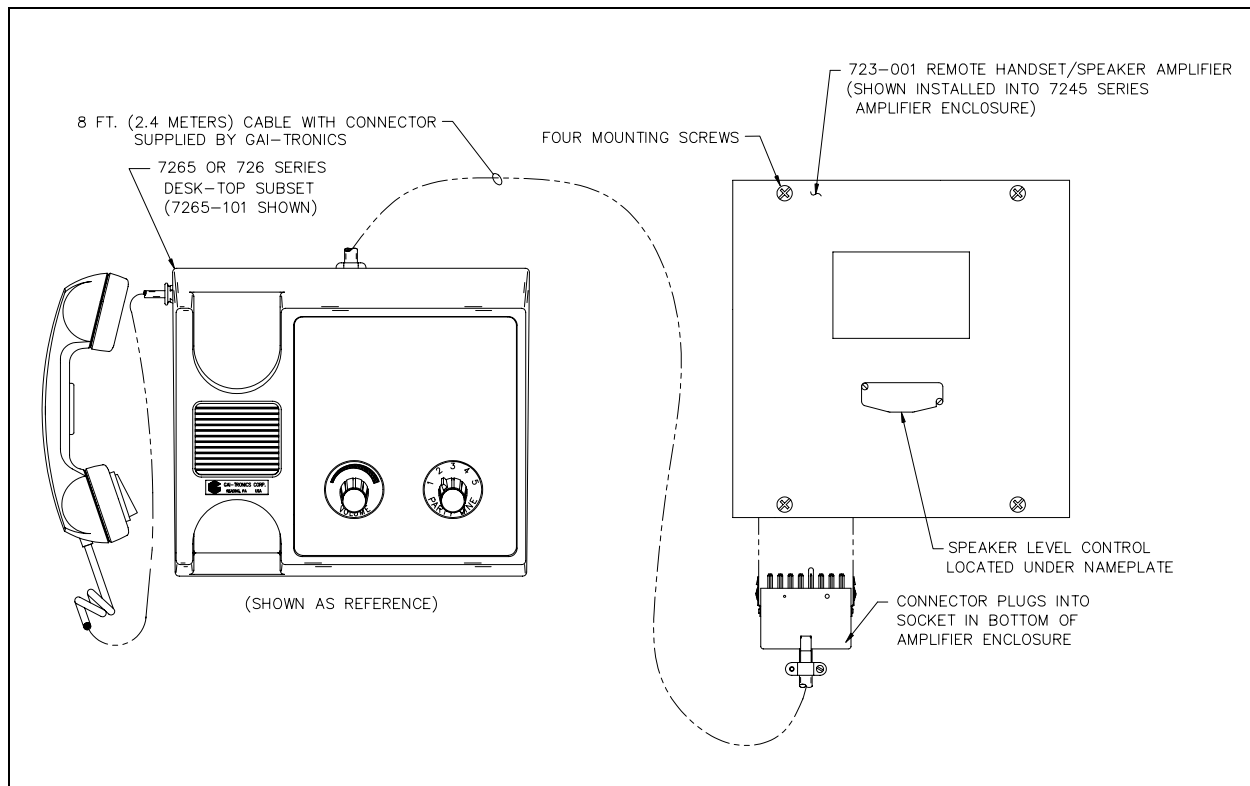

Figure 1. Typical Installation of the 723-001 Remote Handset/Speaker Amplifier

## Specifications

Power input .....	90-140 V ac range, 50/60 Hz, 120 V ac nominal
Power consumed .....	Zero signal: 10.5 VA, 5.3 W Maximum signal: 58 VA, 29.5 W
Construction/Finish.....	16-gauge cold-rolled steel/gray polyurethane enamel

### Handset Amplifier

Output level .....	1.5 V <sub>RMS</sub> nominal into 33-ohm load
Output limiter .....	1.5 V <sub>RMS</sub> nominal
Gain .....	55 dB nominal (below limiter level); adjustable from 40 to 63 dB
Frequency response .....	250-4,000 Hz, +0/-3 dB ref. to 1 kHz (below AGC)
Distortion.....	1.5% maximum THD @ 1,000 Hz
Controls .....	Microphone gain, receiver volume, and sidetone (adjusted through the access holes on rear surface of unit)

### Speaker Amplifier

Output.....	Push-pull, Class B, 12 watts min., with nominal supply voltage
Amplifier sensitivity.....	0.5 V ac, at rated output
Frequency response .....	250-4,000 Hz, +0/-3 dB ref. to 1 kHz
Distortion.....	1% max. THD @ 1,000 Hz, 12 watts
Input impedance .....	50,000 ohms nominal
Controls .....	Speaker volume (adjusted through the access hole behind nameplate on the front panel)
Temperature range .....	-22° F to +158° F (-30° C to +70° C)
Dimensions .....	8.1 H × 8.1 W × 3 D inches (206 × 206 × 76 mm) behind panel/ 3.5 D inches (89 mm) in front of panel
Net weight.....	4.4 lbs. (2.0 kg)
Shipping weight .....	5.4 lbs. (2.4 kg)
Approval .....	NRTL certified for use in US and Canada..... Class I, Div. 2, Groups A, B, C, D, when mounted into a certified GAI-Tronics Model 7245 Amplifier Enclosure