

# High Current RF Chokes

## Special Features

- Very high current capacity
- Low DCR
- Ferrite bobbin core
- VW-1 rated shrink tubing to cover winding
- Fixed lead spacing
- Operating temperature -55 to +105°C
- Current to cause 5% maximum inductance drop or 35°C maximum temperature rise

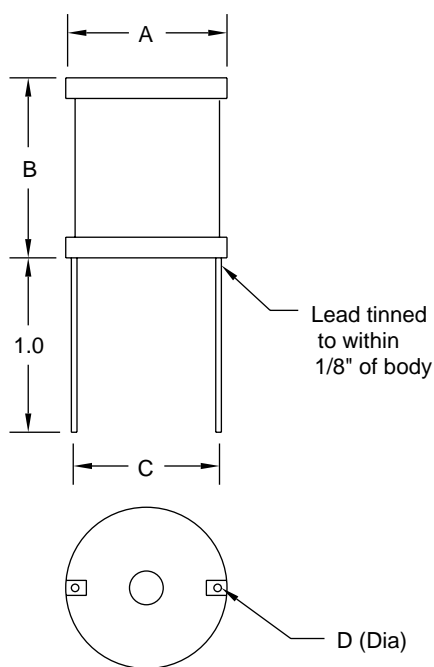

| 5600 Series |                    |              |           |             |             |             |              |
|-------------|--------------------|--------------|-----------|-------------|-------------|-------------|--------------|
| Part Number | L (uH) ±10% @ 1KHz | DCR (Ω) Max. | I, DC (A) | Dim. A Max. | Dim. B Max. | Dim. C ±.06 | Dim. D ±.005 |
| 5601        | 5                  | 0.007        | 15        | 0.83        | 0.91        | 0.59        | 0.065        |
| 5602        | 10                 | 0.008        | 14        | 0.83        | 0.91        | 0.60        | 0.065        |
| 5603        | 25                 | 0.023        | 8         | 0.83        | 0.91        | 0.57        | 0.042        |
| 5604        | 50                 | 0.034        | 6.6       | 0.83        | 0.91        | 0.65        | 0.042        |
| 5605        | 100                | 0.072        | 4.5       | 0.83        | 0.91        | 0.69        | 0.042        |
| 5606        | 250                | 0.173        | 2.9       | 0.83        | 0.91        | 0.65        | 0.042        |
| 5607        | 500                | 0.378        | 2         | 0.83        | 0.91        | 0.68        | 0.042        |
| 5608        | 1000               | 0.801        | 1.3       | 0.83        | 0.91        | 0.66        | 0.042        |
| 5609        | 2500               | 2.040        | .85       | 0.83        | 0.91        | 0.71        | 0.042        |
| 5610        | 5                  | 0.005        | 20        | 1.22        | 1.11        | 0.94        | 0.082        |
| 5611        | 10                 | 0.006        | 17        | 1.22        | 1.11        | 0.95        | 0.082        |
| 5612        | 25                 | 0.009        | 14        | 1.22        | 1.11        | 0.93        | 0.082        |
| 5613        | 50                 | 0.017        | 10        | 1.22        | 1.11        | 0.99        | 0.065        |
| 5614        | 100                | 0.034        | 7         | 1.22        | 1.11        | 0.85        | 0.053        |
| 5615        | 250                | 0.083        | 4.6       | 1.22        | 1.11        | 0.97        | 0.053        |
| 5616        | 500                | 0.129        | 3.7       | 1.22        | 1.11        | 1.12        | 0.053        |
| 5617        | 1000               | 0.279        | 2.5       | 1.22        | 1.11        | 1.05        | 0.053        |
| 5618        | 2500               | 0.690        | 1.6       | 1.22        | 1.11        | 1.05        | 0.053        |
| 5619        | 50                 | 0.012        | 14        | 1.50        | 1.11        | 1.23        | 0.082        |
| 5620        | 100                | 0.027        | 9.8       | 1.50        | 1.11        | 1.12        | 0.065        |
| 5621        | 250                | 0.059        | 6.4       | 1.50        | 1.11        | 1.10        | 0.053        |
| 5622        | 500                | 0.090        | 5         | 1.50        | 1.11        | 1.14        | 0.053        |
| 5623        | 1000               | 0.195        | 3.5       | 1.50        | 1.11        | 1.36        | 0.053        |
| 5624        | 2500               | 0.499        | 2.2       | 1.50        | 1.11        | 1.32        | 0.053        |
| 5625        | 5000               | 1.080        | 1.5       | 1.5         | 1.11        | 1.27        | 0.053        |
| 5626        | 100                | 0.018        | 14        | 1.50        | 1.50        | 1.18        | 0.082        |
| 5627        | 250                | 0.040        | 9         | 1.50        | 1.50        | 1.12        | 0.065        |
| 5628        | 500                | 0.085        | 6.5       | 1.50        | 1.50        | 1.06        | 0.053        |
| 5629        | 1000               | 0.183        | 4.4       | 1.50        | 1.50        | 1.23        | 0.053        |
| 5630        | 2500               | 0.464        | 2.8       | 1.50        | 1.50        | 1.21        | 0.053        |
| 5631        | 5000               | 0.714        | 2.2       | 1.50        | 1.50        | 1.63        | 0.053        |
| 5632        | 10,000             | 1.560        | 1.5       | 1.62        | 1.50        | 1.25        | 0.053        |

**J.W. Miller**  
M A G N E T I C S

306 E. Alondra Blvd., Gardena, CA 90247-1059 • (310) 515-1720 • FAX (310) 515-1962

[www.jwmiller.com](http://www.jwmiller.com)