

CPC-1631CVD2NA

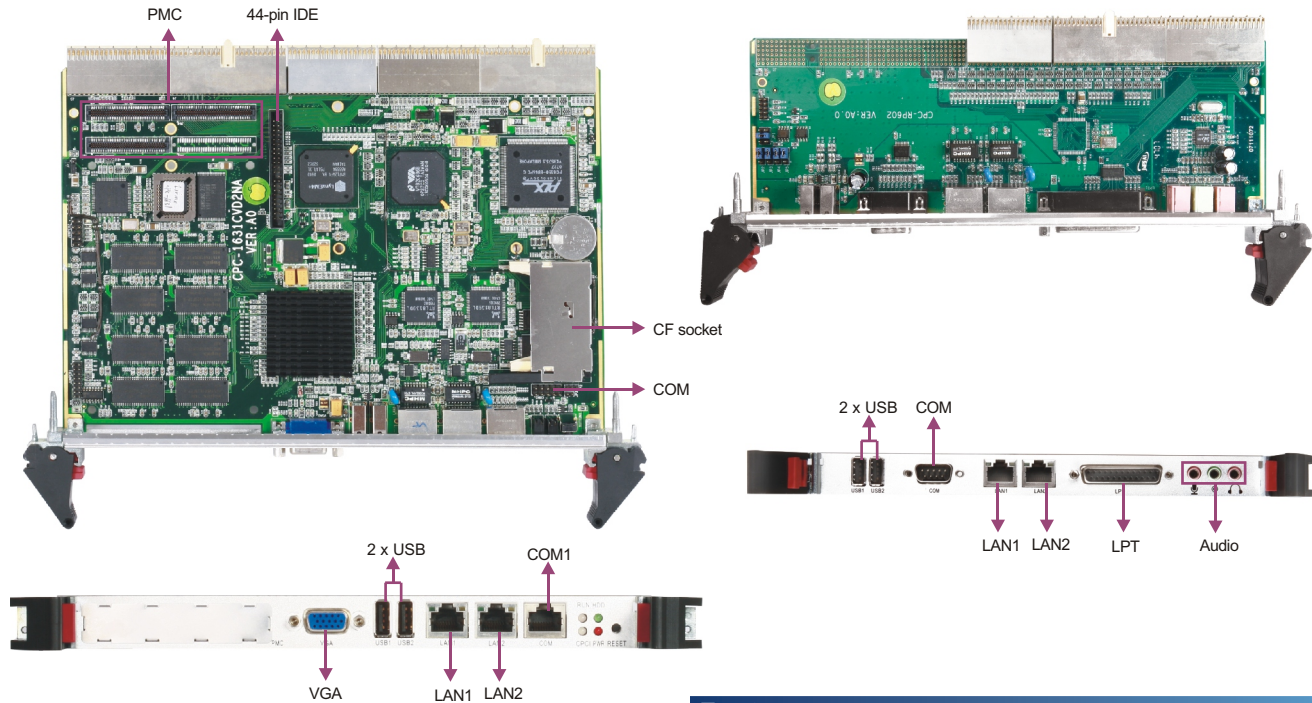

Motorola Power PC CompactPCI Boards with VGA/CF/2LAN/Audio



Board Diagram

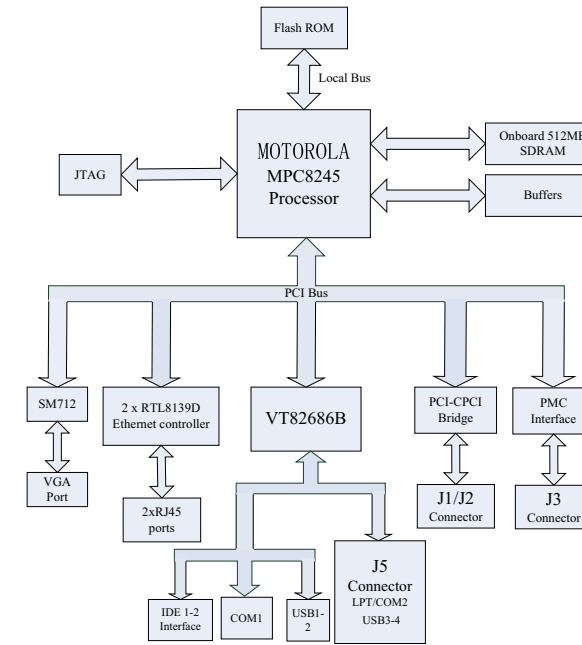

Dimensions

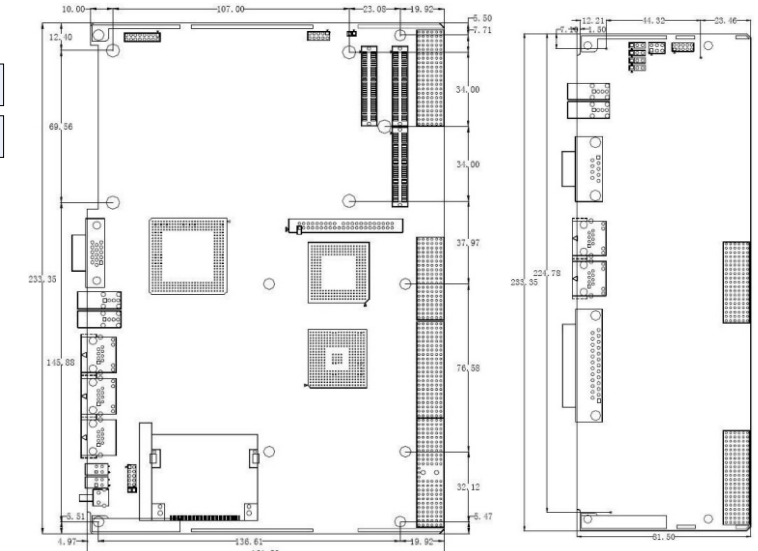

1

Full-Size/Half-Size Slot CPU Cards

2

SBC/Motherboard/Modules

3

Embedded Box PC

4

Network Application Computers

5

Industrial PC

6

HMI

7

EVOG Rugged Series

8

MCC Series

9

Chassis

10

Data Acquisition Boards & Modules

11

Accessories

1

Full-Size/Half-Size Slot CPU Cards

2

SBC/Motherboard/Modules

3

Embedded Box PC

4

Network Application Computers

5

Industrial PC

6

HMI

7

EVOG Rugged Series

8

MCC Series

9

Chassis

10

Data Acquisition Boards & Modules

11

Accessories

Features

- Onboard Motorola 8245 350MHz processor, with 133MHz FSB
- Onboard 512MB SDRAM, 8MB flash, and 1M boot BIOS(optional)
- Supports 2 x 10/100Mbps Ethernet interface
- Supports 1 x VGA port via SM712GF4 graphics controller
- PICMG 2.5 R1.0 H.110 CompactPCI Computer Telephony Specification compliant
- PICMG 2.3 PMC I/O specification compliant
- PICMG 2.1 R2.0 Hot Swap specification compliant
- PICMG 2.0 R3.0 CompactPCI specification compliant
- Selectable 6U rear I/O board: CPC-RP602



Specifications

System		
Processor	Onboard Motorola 8245 350MHz processor	
Chipset	VT82C686	
Memory	onboard 512MB SDRAM, 8MB flash, and 1M boot BIOS for optional	
Hardware Monitor	Monitors system status, voltage, temperature and fan speed etc.	
Watchdog Timer	1~255 sec./min. timer system reset or interrupt, setup by software	
Standard	PICMG2.0, PICMG2.1 R2.0(hot swap), PICMG2.11 R1.0, PICMG2.3 R1.0, PICMG2.5 R1.0 H.110, IPVMI 1.5	
Storage Interface		
Serial ATA	CPC-1631CVD2NA	CPC-RP602
IDE	1 x IDE interface, available interface of 44-pin header onboard	N/A
CF	Supports 1 x CF Socket Type I/II via IDE independent channel	N/A
I/O Interface		
USB	2 x USB2.0 port	2 x USB2.0 port
Serial Port	1 x RS-232(COM1, RJ45 port), 1x RS-232 (COM3, 10-pin header onboard)	1 x RS232/422/485 (COM2,DB9 port)
Parallel Port	N/A	1 x parallel port
PMC	1 x PMC connector with 32-bit PCI bus	N/A
Audio	N/A	Onboard ALC650 audio controller, with Line-out, Mic-in, Line-in
KB/MS	N/A	1 x PS/2(KB/MS) Port
Ethernet		
Chipset	2 x Realtek RTL8139DL, Supporting 2 x 10/100Mbps Ethernet interface based on PCI bus	N/A
Connector	2 x RJ45	2 x RJ45(optional)

Display	
Display port	1 x VGA port
Chipset	Onboard SM712GF4 graphics controller
Memory	
	Supports up to 16MB independent memory(optional)
Resolution	VGA mode up to 1280 x 1024@75Hz
Dual Display	N/A
Mechanical and Environmental	
Dimensions	CPC-1631CLD2NA: 233mm x 160mm x 4HP(1-slot width) CPC-RP602: 233mm x 80mm x 4HP(1-slot width)
Operating Temperature	-15°C~55°C
Storage Temperature	-20°C~75°C
Operating Humidity	5%-95%, non-condensing
Power	
Power Supply	Supports CPCI power supply
Power Consumption	Typical 11.55W(processor: Motorola 8245, system memory: 512M SDRAM)
Operating System	
Windows OS	N/A
Embedded OS	Linux/VxWorks

Available Accessories

Part Number	Name	Description	Qty.
N/A	User Manual/RoHS	CPC-1631CVD2NA	1
N/A	Operating system driver CD/VCD/RoHS	CPC-1631CVD2NA/LINUX trial version/V2.0	1
2330-000011	Jumper/RoHS	Pitch: 2.0mm, black, sealed tail	1
2360-007961	HDD flat cable/RoHS	44P/2.0mm pitch dual punching/gray/length: 30mm	1
2373-001980	Sponge washer	270x225x8	2
2390-000471	Spring piece/RoHS	PMC spring piece/R-931048050004152 SUS/301/1/2H	1

Related Product

Item	Typical Recommendation
CPCI Chassis	CPC-8202, CPC-8203, CPC-8402, CPC-8403, CPC-8404
Rear I/O Board	CPC-RP602
PMC Expansion	PMC-2LAN

Ordering Information

Part Number	Model Number	Description
0030-003230	CPC-1631CVD2NA	Motherboard
0030-003231	CPC-1631CVD2NA	Motherboard/RoHS
0060-001200	CPC-RP602	Rear I/O Board
0060-002360	CPC-RP602/ conformal coating	Rear I/O Board