

Screw Terminal Ultra-Slim Signal Conditioners M6N Series

POWER SUPPLY MODULE

(dual redundant)

Functions & Features

- Supplies power to the M6N modules mounted on the Installation Base
- High-density mounting
- Power indicator LED
- UL approval

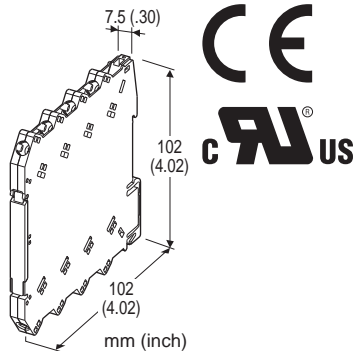

MODEL: M6NPS2-R[1]

ORDERING INFORMATION

- Code number: M6NPS2-R[1]
- Specify a code from below for [1].
(e.g. M6NPS2-R/UL)

POWER INPUT

DC Power

R: 24 V DC

(Operational voltage range 22 - 27 V, ripple 10 %p-p max.)

[1] OPTIONS

STANDARDS & APPROVALS

blank: CE marking

/UL: UL approval (CE marking)

GENERAL SPECIFICATIONS

Connection: M3 screw terminal (torque 0.5 N·m)

Recommended solderless terminal: Max. 5.8 mm (0.23") wide; Ones with insulation sleeve do not fit.

Applicable wire size 0.2 - 2.5 mm²

Housing material: Flame-resistant resin (black)

Power LED: Green light turns on when the power is supplied.

Recommended solderless terminal

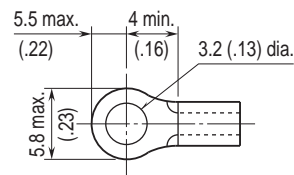

INSTALLATION

Power input: 2 A (Total current consumed by signal conditioners on the base must be 2 A or less.)

Operating temperature: -20 to +55°C (-4 to +131°F)

Operating humidity: 30 to 90 %RH (non-condensing)

Mounting: Installation Base (model: M6NBS)

Weight: 60 g (2.1 oz)

PERFORMANCE

Insulation resistance: ≥ 100 MΩ with 500 V DC

Dielectric strength: 2000 V AC @1 minute (power to ground)

STANDARDS & APPROVALS

CE conformity:

EMC Directive (2004/108/EC)

EN 61000-6-4 (EMI)

EN 61000-6-2 (EMS)

Approval:

UL/C-UL nonincendive Class I, Division 2,

Groups A, B, C, and D hazardous locations

(ANSI/ISA-12.12.01, CAN/CSA-C22.2 No.213)

UL/C-UL general safety requirements

(UL 61010-1, CAN/CSA-C22.2 No.61010-1)

EXTERNAL VIEW

(With the cover open)

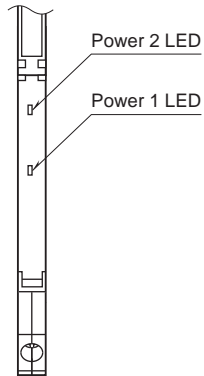

DIMENSIONS unit: mm (inch)

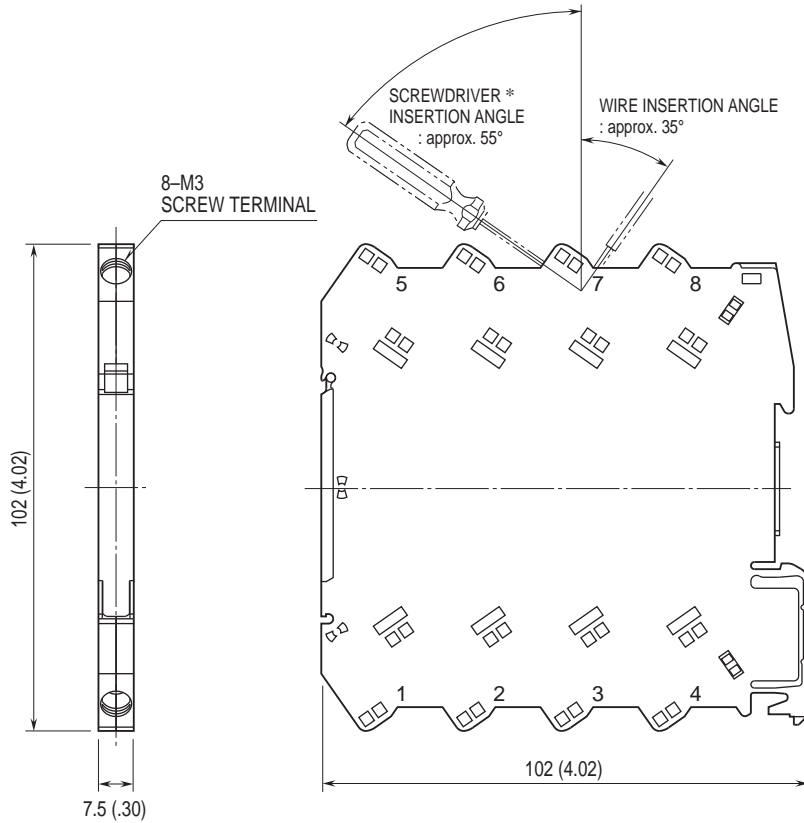

*Screwdriver stem diameter: 6 mm (.24") or less

SCHEMATIC CIRCUITRY & CONNECTION DIAGRAM

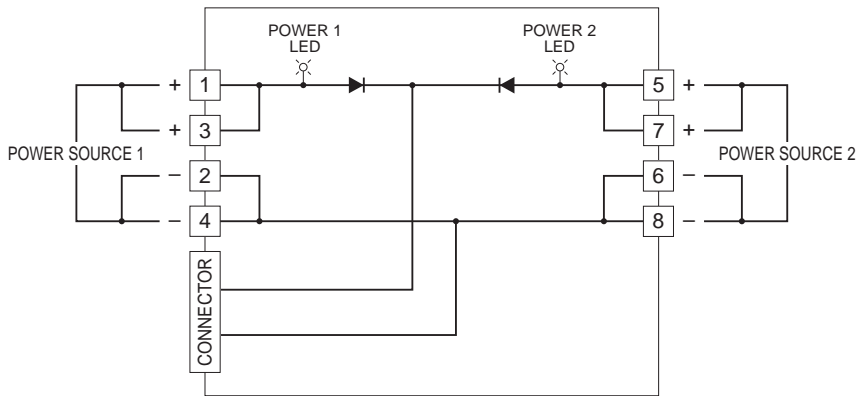

Specifications are subject to change without notice.