

# VELAN COMPRESSED AIR DRAIN TRAPS

## STANDARD MATERIALS

PART	MATERIALS	
	MFA-0,1,2	MFA-S
A Body	Cast iron Gr.250	Cast steel WCB
B Cover	Same as body material	
C Plate	Stainless steel 1/8" thick	
D Holder	Stainless steel	
E Float	Stainless steel	
F Cover gasket	Stainless steel with non-asbestos filler	
G Cover screw	High tensile steel Gr. S	
H Strainer	Stainless steel	
I Stem and ball	Stainless steel	
J Seat <sup>(1)</sup>	SS hardfaced with Stellite 6	
K Self- locking adjusting nut	Stainless steel	
L Pivot plug	Stainless steel	
M Connection for balance pipe	3/8" NPT	

(1) MFA0: hardened seat.

## ENGINEERING DATA

TYPE	PRESSURE RANGE psi / bar	PMO psi / bar	MAX TEMP °F/°C	ORIFICE in/mm	MAX CAPACITY lb/hr/kg/hr
MFA0	0-125	125	Cast iron Gr.250	7/32 5.5	4,500
MFA1	0-8.5	8.5			2,045
MFA2	0-200	200			6,000
MFAS	0-150	150	Cast carbon steel WCB		3,000
	0-10.5	10.5			1,364
	0-230	230			3,500
	0-16	16	1,590		
	0-300	300	4,000		
	0-21	21	1,818		

PMA = Maximum allowable pressure = PMO  
 Maximum cold hydrostatic test pressure: 400psi.g (27.5bar.g) where PMO ≤ 200psi  
 Twice PMO where PMO > 200psi  
 PMO = Maximum operating pressure: (See Table)

## DIMENSIONS & WEIGHTS

TYPE	SIZE IN/MM	A HEIGHT	B <sup>(1)</sup> CENTER TO FACE	C <sup>(2)</sup> CENTER TO FACE	D LENGTH	WEIGHT LB/KG
MFA0	1/2 3/4 1 15 20	6 1/8 156	4 3/8 111	1 1/8 29	6 3/4 171	8.75 4

(1) Center of inlet to outlet face. (2) Center of outlet to inlet face.

TYPE	SIZE IN/MM	A <sup>(1)</sup> FACE TO FACE	B <sup>(2)</sup> CENTER TO CENTER	C <sup>(3)</sup> CENTER TO FACE	D LENGTH	WEIGHT LB/KG
MFA1	1/2 3/4 1 15 20 25	6 5/8 168	3 15/16 100	1 3/8 35	8 5/16 211	12 5.5
MFA2	3/4 1 20 25	7 11/16 195	4 3/4 121	1 7/16 37	9 3/8 238	15 7
MFA2	1 1/4 1 1/2 32 40	8 203	4 1/2 114	1 3/4 44	10 3/8 264	17 8

(1) Vertical connection. (2) Horizontal connection. (3) Center of vertical outlet to face of horizontal outlet.

TYPE	SIZE IN/MM	A FACE TO FACE			B CENTER TO BOTTOM	C CENTER TO TOP	WEIGHT LB/KG		
		SCR/SW	BW	FLG			SCR/SW	BW	FLG
MFA0	1/2 3/4 1 15 20 25	3 11/16 94	9 11/16 246	6 152	5 1/4 133	9 1/4 235	18 8	20 9	30 14

## CONDENSATE CAPACITY

The performance graph indicates the continuous discharge capacities of condensate per hour at various pressure differentials across the trap.

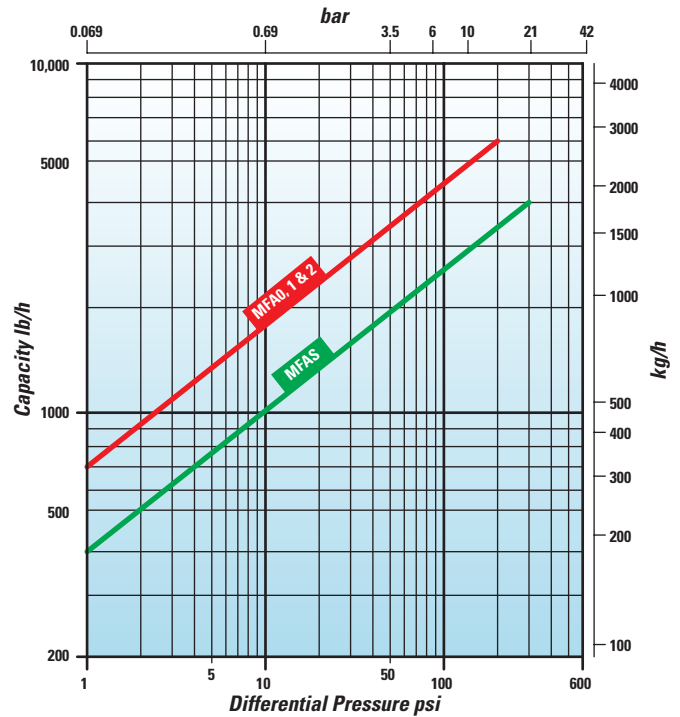

Maximum cold water capacity x 3.5

### Type MFA0

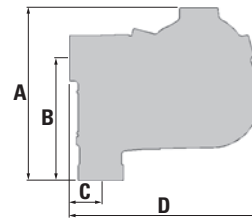

### Type MFA1, 2

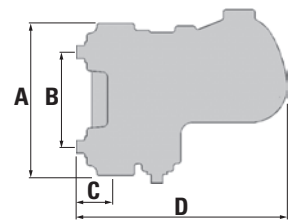

### Type MFAS

