

IPC-610-H/L

4U 14-slot Rackmount Chassis with Front-accessible USB/PS2 Connectors



Features

- 4U rackmount chassis supports up to 14 cards
- Shock-resistant disk drive bay design holds up to three 5.25" and one 3.5" disk drives
- Front accessible USB & PS/2 interfaces for easy data transferring
- Dual front-accessible filtered cooling fans provide optimal, streamlined airflow
- Special hold-down clamp design with rubber cushions protects the cards from harsh environments and any unexpected shocks
- Visible power status and HDD activity notification improves system availability
- User-friendly and front-accessible filter for easy system maintenance
- Flexible mechanical design supports both single PS/2 and redundant ATX power supply

Specifications

Drive Bay	3.5"	Front-accessible	1
	5.25"		3
Cooling	Fan		2 (85 CFM each)/1 (85 CFM each)
	Air Filter		Yes
I/O Interface	USB		2/-
	PS/2		PS/2 keyboard & mouse, or PS/2 keyboard only, depending on the enclosed CPU card/motherboard (IPC-610-H only)
Miscellaneous	Slide Rail		General Devices (http://www.generaldevices.com/) C-300 series supported (not included)
	Indicators		Power & HDD activity
	Rear Panel		D-Sub 9-pin and 25-pin openings
Environment		Operating	Non-Operating
	Temperature	0 ~ 40° C (32 ~ 104° F)	-20 ~ 60° C (-4 ~ 140° F)
	Humidity	10 ~ 85 % @ 40° C, non-condensing	10 ~ 95 % @ 40° C, non-condensing
	Vibration (5 ~ 500 Hz)	1 Grms	2 G
	Shock	10 G (with 11 ms duration, 1/2 sine wave)	30 G
	Acoustic Noise	Less than 52 dB sound pressure at 5 ~ 28° C (41 ~ 82° F)	
Physical Characteristics	Altitude	0 to 3,048 m (0 ~ 10,000 ft)	
	Dimensions (W x H x D)	482 x 177 x 478 mm (19" x 7" x 18.8")	
	Weight	17.0 kg (37.4 lb)/16.5 kg (36.3 lb)	

IPC-610-H

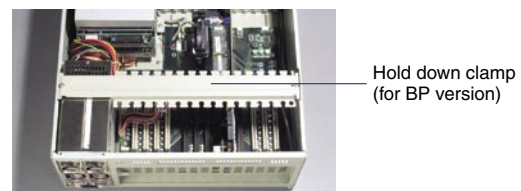
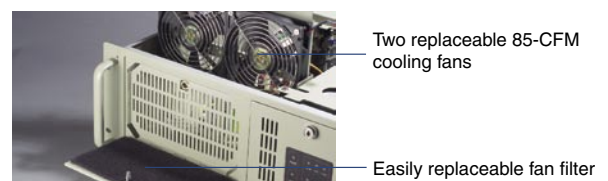
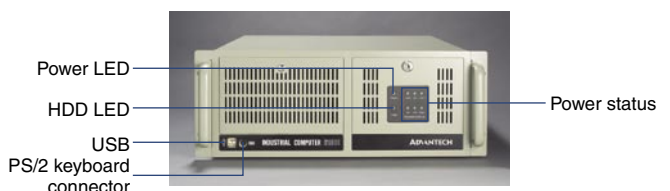

Dimensions

IPC-610-H

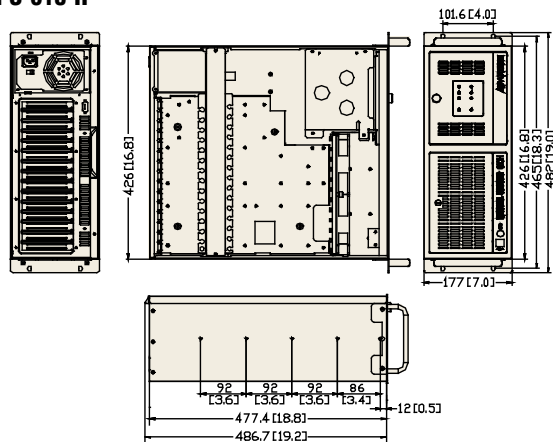

IPC-610-L

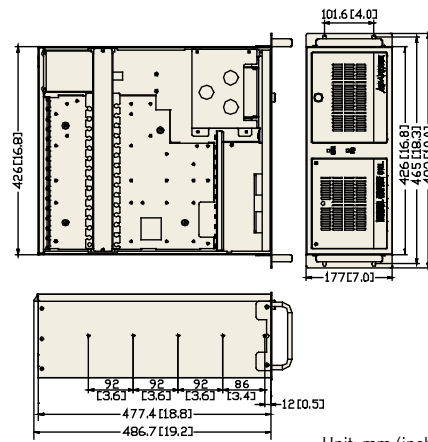

Unit: mm (inch)

Power Supply Options

Part Number	Watt	Input	Output	Specifications		
				Mini-load	Safety	MTBF
PS-250ATX-ZE (ATX, PFC)	250 W	AC 115/230 V (selectable)	+5 V @ 27 A, +3.3 V @ 20 A +12 V @ 13 A, -12 V @ 0.8 A -5 V @ 0.3 A, +5 Vsb @ 2 A	+5 V @ 0.5 A, +12 V @ 1 A +3.3 V @ 0.3 A	UL/TUV/CB/CCC	100,000 hours @ 25° C
PS-300ATX-ZBE (ATX, PFC)	300 W	AC 100 ~ 240 V (full-range)	+5 V @ 30 A, +3.3 V @ 28 A +12 V @ 15 A, -12 V @ 0.3 A -5 V @ 0.3 A, +5 Vsb @ 2 A	+5 V @ 0.1 A, +3.3 V @ 0.3 A	UL/TUV/CB/CCC	100,000 hours @ 25° C
RPS-300ATX-ZE (ATX, PFC) (IPC-610-H only)	300 W	AC 100 ~ 240 V (full-range)	+5 V @ 25 A, +3.3 V @ 18 A +12 V @ 16 A, -12 V @ 0.5 A -5 V @ 0.5 A, +5 Vsb @ 2 A	+5 V @ 3 A, +3.3 V @ 1 A +12 V @ 2 A	UL/TUV/CB/CCC	100,000 hours @ 25° C
PS-400ATX-ZBE (ATX, PFC) (IPC-610-H only)	400 W	AC 100 ~ 240V (full-range)	+5 V @ 35 A, +3.3 V @ 25 A +12 V @ 30 A, -12 V @ 1 A -5 V @ 0.8 A, +5 Vsb @ 2 A	+5 V @ 3 A, +12 V @ 1 A +3.3 V @ 1 A	UL/TUV/CB/CCC	91,000hours @ 25° C
RPS-400ATX-ZE (ATX, PFC) (IPC-610-H only)	400 W	AC 100 ~ 240 V (full-range)	+5 V @ 35 A, +3.3 V @ 25 A +12 V @ 28 A, -5 V @ 0.5 A -12 V @ 1.2 A, +5 Vsb @ 2 A	+5 V @ 3 A, +3.3 V @ 1 A +12 V @ 2 A, +5 Vsb @ 0.1 A	UL/cUL/TUV/CB/CCC	100,000 hours @ 25° C
PS-300ATX-DC48E (IPC-610-H only)	300 W	DC -48 V	+3.3 V @ 28 A, +5 V @ 30 A, +12 V @ 15 A, -5 V @ 0.3 A, -12 V @ 0.8 A, +5 Vsb @ 2 A	+5 V @ 0.3 A, +3.3 V @ 0.3 A, +12 V @ 0.2 A	UL/TUV/CB/CCC	100,000 hrs @ 25° C

Accessories

Part Number	Description
19914K0010	Door filter 97.6 x 36.6 x 5 mm
1999615000	Fan filter 115 x 195 x 5 mm



IPC-610-L

Ordering Information

Part Number	Power Supply	Motherboard/Backplane	Regulation
BP version			
IPC-610BP-00XHE	Without power supply, with ATX switch	-	-
IPC-610BP-25ZHE	PS-250ATX-ZE	-	CE
IPC-610BP-30ZHE	PS-300ATX-ZBE	-	CE
IPC-610BP-30RHE	RPS-300ATX-ZE	-	CE
IPC-610BP-40ZHE	PS-400ATX-ZBE	-	CE
MB version			
IPC-610MB-00XHE	Without power supply with ATX switch	-	-
IPC-610MB-30ZHE	PS-300ATX-ZBE	-	CE
IPC-610MB-30RHE	RPS-300ATX-ZE	-	CE
IPC-610MB-00XLE	Without power supply, with ATX switch	-	-
IPC-610MB-25ZLE	PS-250ATX-ZE	-	CE
IPC-610MB-30ZLE	PS-300ATX-ZBE	-	CE

PCE-5120

LGA775 Core™ 2 Duo/Pentium® D/Pentium® 4/ Celeron® D Processor Card with PCI Express/ VGA/Dual GbE LAN

NEW

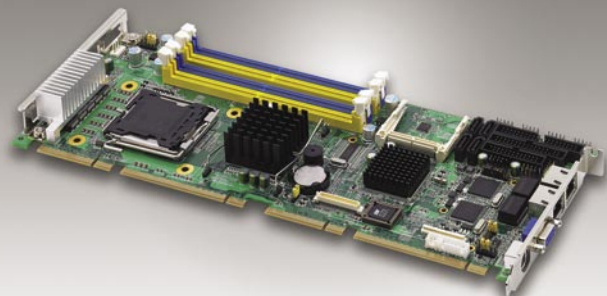

Features

- Complies with PICMG 1.3
- Supports LGA 775 Intel® Core™ 2 Duo/ Pentium® D/Pentium® 4/Celeron® D with 1066/800/533 MHz FSB
- Supports dual-channel DDR2 533/667 SDRAM up to 4 GB
- One PCIe x16 and four PCIe x1 links to backplane
- Dual Gigabit Ethernet via two PCIe x1 ports
- Onboard IPMI module (optional)
- Four SATA II channels with software RAID 0, 1, 5 and 10
- A2 version is enhanced to support Intel Core™ 2 Duo processors



Specifications

Processor System	CPU	Intel® Core™ 2 Duo (A2 Version Only)	Intel Pentium D	Intel Pentium 4	Intel Celeron D		
	Max. Speed	2.66 GHz	3.2 GHz (dual core)	3.8 GHz	3.06 GHz		
	L2 Cache	4 MB	2 MB x 2/1 MB x 2	2 MB/1 MB	512 KB/256 KB		
	Chipset	Intel 945G + ICH7R					
	BIOS	4 Mb flash via LPC					
	Front Side Bus	1066/800/533 MHz					
Bus	PCI Express	One x16 & four x1 to backplane					
	PCI	32-bit/33 MHz					
	PCI Daughterboard	32-bit/33 MHz Advantech PCI expansion connector for SCSI or PCA-GIGA cards					
Memory	Technology	Dual-channel DDR2 533/667 MHz DIMMs					
	Max. Capacity	4 GB					
	Socket	240-pin DIMM x 4					
Graphic	External Card	PCI Express x16 graphic card					
	Chipset Integrated	Up to 2048 x 1536 @ 75 Hz refresh					
	VRAM	Shared with 224 MB system memory					
	Video Output	15-pin CRT connector x 1					
Ethernet	Interface	10/100/1000Base-T					
	Controller	LAN1: Intel 82573V (PCI Express x1) LAN2: Intel 82573V (PCI Express x1)					
	Connector	RJ-45 with LED connector x 2					
SATA II	Max. Data Transfer Rate	300 MB/s					
	Channel	4 on SHB; supports software RAID 0, 1, 5 and 10					
EIDE	Mode	ATA 100/66/33					
	Channel	1 (supports up to 2 IDE devices including 1 optional type II CF card)					
I/O Interface	USB	Max. 8 (USB 2.0 compliant) 4 on SHB by Pin Header, 4 to Backplane					
	Serial	4 (RS-232) with Pin Header (COM2 can be configured to RS-232/422/485)					
	Parallel	1 (EPP/ECP)					
	FDD	1					
	PS/2	1 (Y cable for mouse and keyboard included)					
Watchdog Timer	Output	Interrupt, system reset					
	Interval	Programmable 1, 2, 4, 8, ..., 256 sec					
Miscellaneous	Audio Output	AC'97 audio interface (requires an audio extension module P/N: PCA-AUDIO-00A1E)					
	Test Conditions	Intel Pentium D 3.2 GHz/2 MB/800 MHz/130 W; DDR2 667 MHz 1 GB x 4					
Power Requirement	Voltage	+12 V	+5 V	+3.3 V	+5 VSB	-12 V	-5 V
	Typical Current	15 A	2 A	20 A	0.7 A	0 A	0 A
Environment		Operating			Non-Operating		
	Temperature	0 ~ 55° C (32 ~ 131° F), depends on CPU's speed			-20 ~ 80° C (-4 ~ 176° F)		
Physical	Dimensions (L x W)	338.58 x 126.39 mm (13.3" x 4.98")					

Block Diagram

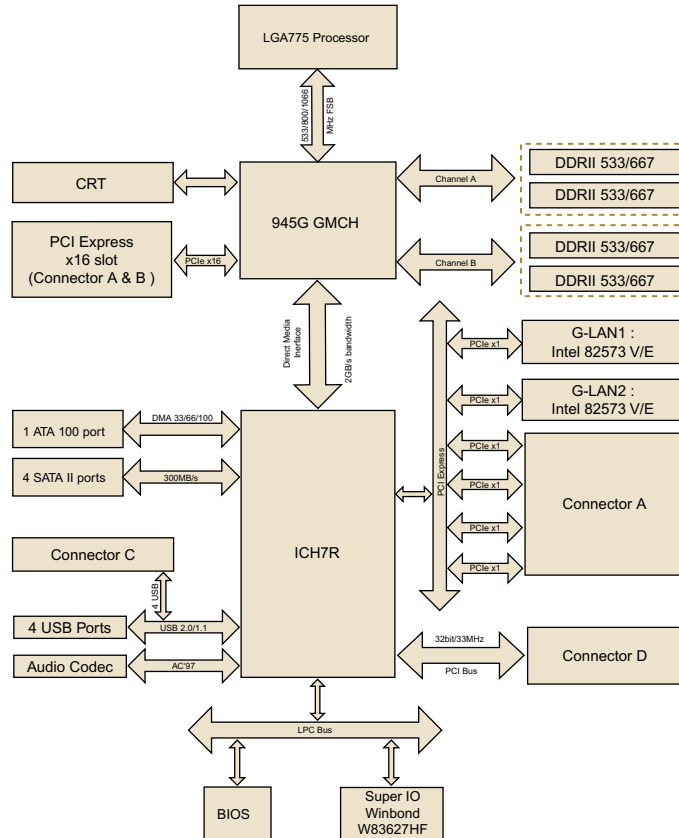

Ordering Information

Part Number	Core™ 2 Duo	CPU	Gigabit LAN	VGA
PCE-5120G2-00A2E	Yes		Dual	Yes
PCE-5120VG-00A2E	Yes		Single	Yes
PCE-5120G2-00A1E	No		Dual	Yes
PCE-5120VG-00A1E	No		Single	Yes

Packing List

Part Number	Description	Quantity
1700340640	FDD cable	x 1
1701400452	Ultra ATA 66/100 HDD cables	x 1
1700003194	Serial ATA HDD data cable	x 2
1703150102	Serial ATA HDD power cable	x 2
1701260305	Printer + COM cable	x 1
1701092300	Dual COM port cable kit	x 1
1700060202	Y cable for PS/2 keyboard and mouse	x 1
1750000400	CPU cooler	x 1
1700002314	USB cable with 4 ports	x 1
9689000068	Jumper pack	x 1
-	Startup manual	x 1
-	Utility CD	x 1

Bracket View



PCE-5120G2-00A2E



PCE-5120VG-00A2E

Accessories

Part Number	Description
PCA-AUDIO-00A1E	Audio extension module