

## Highlights

- Small sensing head fits where other sensors can't
- Special models for glass and metals processing applications
- 1% accuracy across the whole temperature range
- 0/4 – 20 mA, 0 – 5 V, J or K thermocouple output
- Ambient head temperatures up to 85°C without cooling
- Interchangeable sensing heads
- Adjustable emissivity, transmissivity, peak hold, valley hold and averaging
- 5-digit backlit LCD user interface
- Accessories for cooling and air purging
- Optional RS-232 or RS-485 digital communications
- Multidrop Network (max. 32 sensors with RS-485)

## Electrical Specifications

Outputs	4 – 20 mA, 0 – 20 mA, 0 – 5 V (scaleable) J or K thermocouple, 10 mV / °C head ambient signal
Cable Length	1 m standard
Output Impedance (T/C)	20 Ω
Minimum Load Impedance (mV)	100 kΩ
Maximum Loop Impedance (mA)	500 Ω with 24 VDC power supply
Current Draw	100 mA
Power Supply	12 – 24 VDC

## Sensor Specifications

<b>Environmental Rating</b>	IP65 (NEMA-4)
<b>Ambient Temperature</b>	
Sensing head	0 to 85°C
With air cooling	-18 to 200°C
Electronics housing	0 to 65°C
<b>Storage Temperature</b>	-40 to 85°C
<b>Relative Humidity</b>	10 to 95%, non-condensing
<b>EMI</b>	IEC 801-3, Level 3 (max. cable length 3 m)
<b>Weight</b>	
Sensing head	50 g (with 1 m cable), Stainless steel
Electronics housing	270 g, Zinc, die-cast

## Optical Specifications

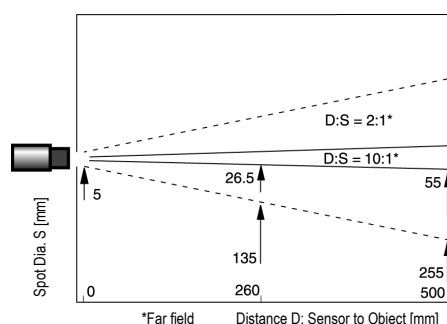

## Raytek Compact Series

# MID

## Datasheet



## Measurement Specifications

<b>Temperature Range</b>	
LT (Low Temperature)	-40 to 600°C -25 to 600°C for J-thermocouple output
G5 (Glass)	150 to 850°C
MTB (Medium Temperature)	200 to 1200°C
<b>Spectral Response</b>	
LT	8 to 14 μm
G5	5 μm
MTB	3,5 to 4 μm
<b>Optical Resolution<sup>1</sup></b>	
LT	2:1 or 10:1
G5, MTB	10:1
<b>System Accuracy<sup>2</sup></b>	
LT, G5, MTB	±1% or ±1°C <sup>3</sup>
Thermocouple output	±1% or ±2,5°C <sup>3</sup>
<b>Repeatability</b>	±0,5% or ±0,5°C <sup>3</sup>
<b>Temperature Coefficient</b>	
MIC sensing head <sup>4</sup>	0,05°C / °C or 0,05% / °C <sup>3</sup> (ambient temperature: 23 – 85°C)
MIC sensing head <sup>4</sup>	0,15°C / °C or 0,15% / °C <sup>3</sup> (ambient temperature: 0 – 23°C)
MID sensing head	0,05°C / °C or 0,05% / °C <sup>3</sup> (ambient temperature: 0 – 85°C)
Electronics housing	0,1°C
<b>Temperature Resolution</b>	
LT	0,1°C <sup>5</sup>
G5	0,2°C <sup>5</sup>
MTB	0,4°C
<b>System Response Time</b>	150 ms (95%)
<b>Emissivity</b>	0,100 to 1,100 digitally adjustable increments of 0,001
<b>Transmission</b>	0,100 to 1,000 digitally adjustable increments of 0,001
<b>Signal Processing</b>	Peak hold, valley hold, variable averaging filter, adjustable up to 998 s

<sup>1</sup> 90% energy

<sup>2</sup> at ambient temperature 23°C ± 5°C

<sup>3</sup> whichever is greater

<sup>4</sup> with ISO Calibration Certificate, based on NIST/DKD certified probes

<sup>5</sup> for temperature span 300K

## Dimensions

### Sensing Head

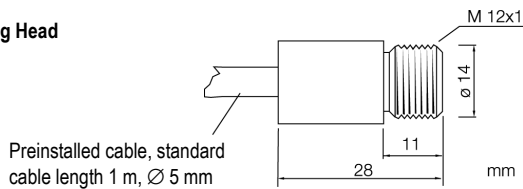

### Electronics Housing

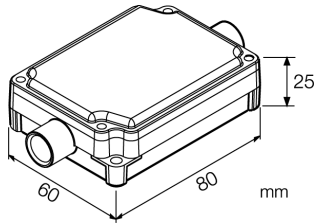

## Accessories

Each standard MID package includes a sensing head, one mounting nut, 1 m of cable, die-cast housing with premounted electronics, and an operator's manual. Longer cables up to 15 m maximum are available and must be specified at time of order.

### Adjustable Mounting Bracket (XXXMIACAB), or fixed mounting bracket (XXXMIACFB)

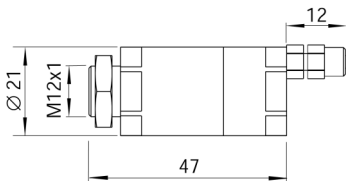
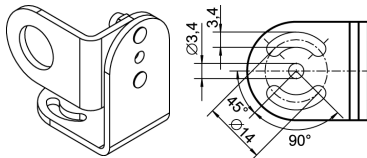

**Air Purge Jacket with fitting, no cooling (XXXMIACAJ)**

### Right Angle Mirror for Air Cooling Jacket and Air Purge Jacket only (XXXMIACRAJ)

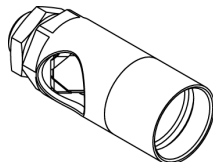

### Air Cooling Jacket and T-Adapter incl. 0.8 m air hose and insulation (XXXMIACCJ)

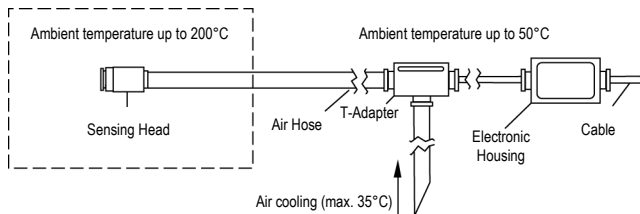

58501, Rev. C, 06/2002, Raytek, the Raytek Logo and DataTemp are registered trademarks of Raytek Corporation. Specifications subject to change without notice.

## Multidrop Network Installation

RS-485 sensors can be configured in a multidrop network or point-to-point installation. In multidrop networks, a dedicated PC with DataTemp Multidrop software supports online system monitoring and configuration. Up to 32 sensors are supported in a multidrop network.

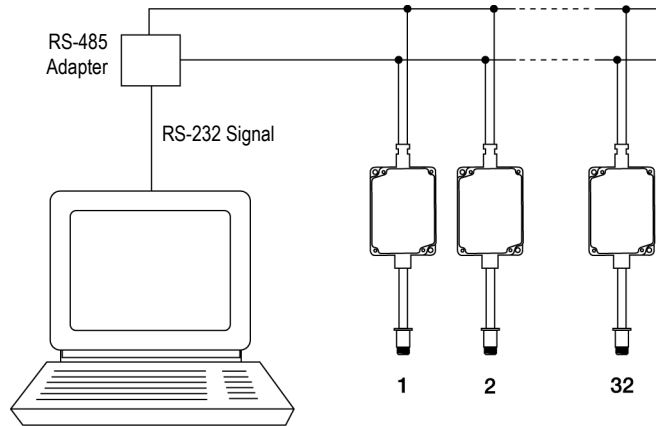

## DataTemp® Multidrop Software



For use with RS-232 or RS-485 models, DataTemp Multidrop software allows access to the extended digital features of the MID with an easy-to-use interface. Compatible with WIN 95/98/NT/2000, DataTemp Multidrop provides for sensor setup, remote monitoring, and simple data logging for analysis or to meet quality record-keeping requirements.

Additional features configurable with optional RS-232 or optional RS-485 communications and DataTemp MultiDrop Software:

- 5V alarm signal triggered by target temperature or ambient head temperature
- Eight-position "recipe" table that can be easily interfaced to an external control system
- External reset signal input for signal processing
- External inputs for analog emissivity adjustment or background radiation compensation
- Remote digital communication and control of up to 32 sensors in an RS-485 multidrop configuration

**TRANSCAT**

Visit us at [Transcat.com!](http://Transcat.com!)

35 Vantage Point Drive // Rochester, NY 14624 // Call 1.800.800.5001

**Raytek®**