



# MARCH PUMPS

1819 PICKWICK AVE., GLENVIEW, IL 60026-1306, U.S.A

**AC-2CP-MD, AC-2AP-MD  
BC-2CP-MD, BC-2AP-MD  
2CP-MD, LC-2CP-MD**

**DESCRIPTION & OPERATION:** Series 2 are centrifugal magnetic drive pumps, eliminating the need for a shaft seal. Pumps can be serviced with a screwdriver. The "LC" model is hermetically encapsulated allowing the pump to run fully submerged or in open air for complete moisture protection. Model 2CP-MD must be run submerged only. See the parts list for a breakdown of parts. BC models have an encapsulated impeller magnet.

Pumps are not self-priming, lack a suction lift, and thus require a **flooded suction**. Pumps **cannot be run dry** because the impeller requires the liquid being pumped for lubrication. For liquids with a specific gravity greater than water, have a higher viscosity, or for elevated temperatures, a trimmed impeller may be necessary. For application assistance, contact March Pump.

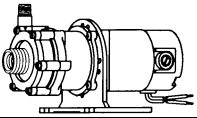
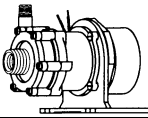
SPECIFICATIONS	BC-2CP-MD (12V & 24V DC)	
		
<b>Models (Motor Style)</b>	<b>Brush</b>	<b>Brushless</b>
Max Flow	6 gpm - 22.7 lpm	
Max Head	15 ft / 6.5 psi - 4.6 m	23 ft / 9.9 psi - 7 m
Inlet - Outlet	3/8" FPT & 3/4" MPT - 1/4" MPT	
Max Internal Pressure	50 psi - 3.4 bar	
Max Liquid Temperature	190°F / 87°C	
Motor Type	DC	
Watts - Amps	12V 43 - 3.5 24V 43 - 1.8	38 - 3.1 38 - 1.6
Restricted Voltage Range	12V	10V to 14V
	24V	20V to 28V
Hp / Kw - Rpm	1/25 / 0.029 - 3650	
Electrical Connection	9" Leads	12" Leads
Overall Pump Size (H x W x L)	Inches 4.44 x 4.50 x 7.61 cm 11.2 x 11.4 x 19.3	Inches 4.44 x 4.50 x 5.46 cm 11.2 x 11.4 x 13.8
Packed Weight	4 lbs / 1.8 kg	2 lbs / 0.9 kg

The red lead is positive & blue lead is negative.

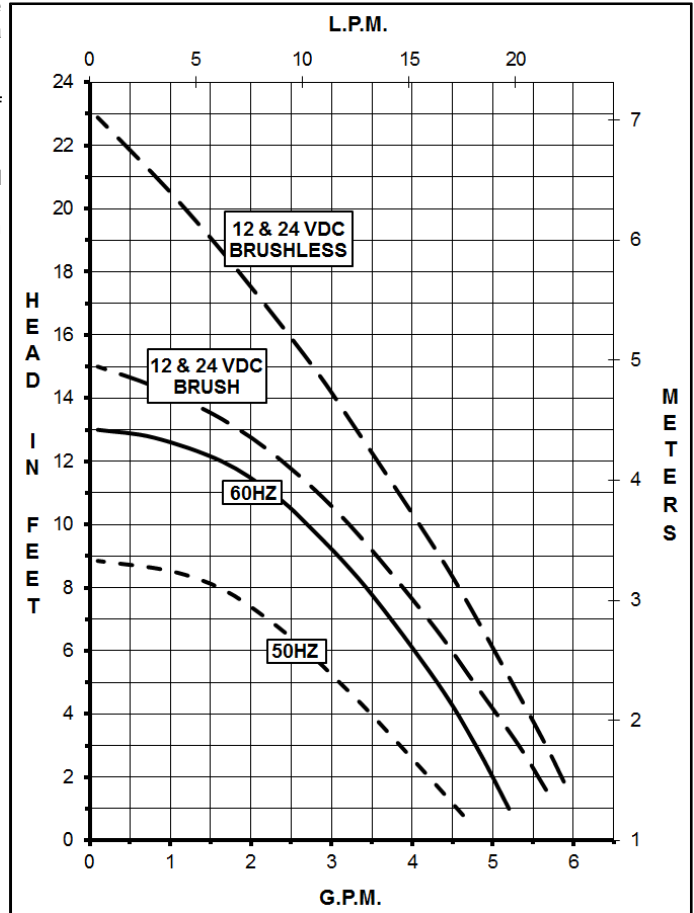

**ELECTRICAL:** The AC-2CP-MD & AC-2AP-MD open air cooled motors as well as BC-2CP-MD & BC-2AP-MD blast cooled motors are available in different electrical configurations such as, 115V 50/60Hz, or 230V 50/60Hz, 1 phase. The 2CP-MD and LC-2CP-MD pumps are U.L. Recognized under File No. E80954. U.L. Recognition On Pumps Is For Water Only.

**LIMITED WARRANTY:** March pumps are guaranteed only against defects in workmanship or materials for a period of one year from date of manufacture pumping water. For the complete warranty and to register online go to [www.marchpump.com/warranty-registration](http://www.marchpump.com/warranty-registration)

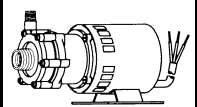
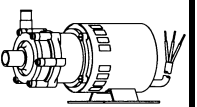
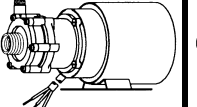
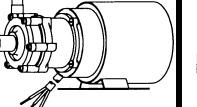
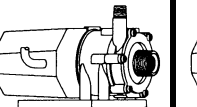
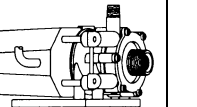
SPECIFICATIONS	AC-2CP-MD	AC-2AP-MD	BC-2CP-MD	BC-2AP-MD	2CP-MD	LC-2CP-MD
						
Model Abbreviations	CP: Threaded Ports	AP: Smooth Ports	CP: Threaded Ports	AP: Smooth Ports	CP: Threaded Ports	LC: Liquid Cooled
Motor Type	AC: Air Cooled		BC: Blast Cooled		Submersible	TE/ Submersible
Rating / Duty	U.L. listed motor / Continuous		U.L. listed motor / Continuous		U.L. listed motor / Continuous	
Max Flow	60Hz - 50Hz 5 gpm - 18.5 lpm		5 gpm - 18.5 lpm		5 gpm - 18.5 lpm	
Max Head	60Hz - 50Hz 13 ft / 5.7 psi - 2.7 m		13 ft / 5.7 psi - 2.7 m		13 ft / 5.7 psi - 2.7 m	
Inlet	3/8" FPT & 3/4" MPT	3/4" OD	3/8" FPT & 3/4" MPT	3/4" OD	3/8" FPT & 3/4" MPT	
Outlet	1/4" MPT	1/2" OD	1/4" MPT	1/2" OD	1/4" MPT	
Max Internal Pressure	50 psi - 3.4 bar		50 psi - 3.4 bar		50 psi - 3.4 bar	25 psi - 1.7 bar
Max Liquid Temperature	190°F / 87°C		190°F / 87°C		130°F / 54°C	
Overall Pump Size (H x W x L)	Inches 4.5 x 3.5 x 7.39 cm 11.4 x 8.8 x 18.7	Inches 4.5 x 3.5 x 7.77 cm 11.4 x 8.8 x 19.7	Inches 4.56 x 3.91 x 8.36 cm 11.5 x 9.9 x 21.2	Inches 4.56 x 3.91 x 8.73 cm 11.5 x 9.9 x 22.1	Inches 4.13 x 4.87 x 6.11 cm 10.4 x 12.3 x 15.5	
Packed Weight	4.5 lbs / 2 kg		6.5 lbs / 3 kg		5 lbs / 2.3 kg	
Electrical Connection	115V 3 ft (0.9 m) Cord 230V 3 ft (0.9 m) Cord		3 ft (0.9 m) Cord 3 ft (0.9 m) Cord		6 ft Cord w/plug 6 ft (1.8 m) Cord 6 ft (1.8 m) Cord	
<b>Models</b>	<b>AC-2CP-MD &amp; AC-2AP-MD</b>		<b>BC-2CP-MD &amp; BC-2AP-MD</b>		<b>2CP-MD &amp; LC-2CP-MD</b>	
	60Hz		50Hz		60Hz	
	50Hz		60Hz		50Hz	
1Ph 115V Watts - Amps	77 - 1.2	84 - 1.2	73 - 1.2	75 - 1.2	54 - 0.92	58 - 1.1
230V Watts - Amps	75 - 0.6	82 - 0.6	66 - 0.5	66 - 0.5	57 - 0.53	59 - 0.72
Hp / Kw - Rpm	1/40 - 3450	0.018 - 2850	1/40 - 3450	0.018 - 2850	1/35 - 3450	0.021 - 2850

All specifications & data are based on pumping water & are intended as a guideline only. Specifications may vary with different motors.

**PARTS LIST**

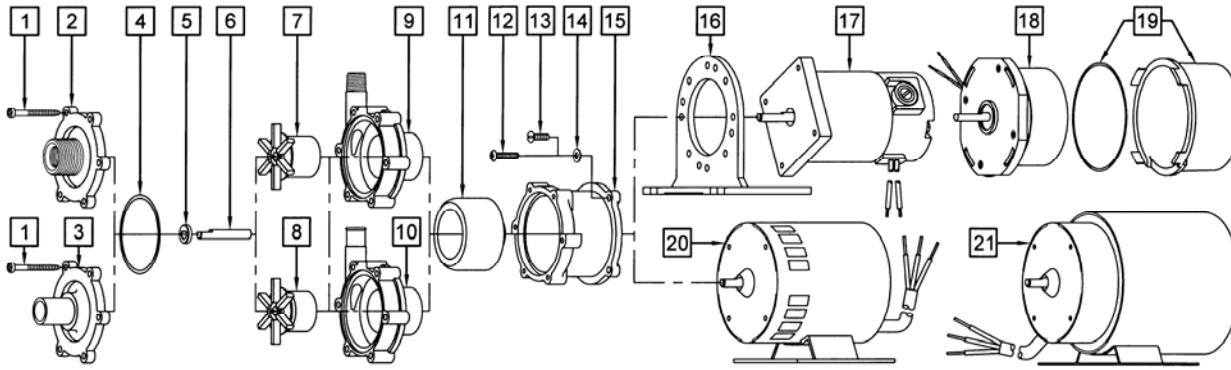

**MATERIALS IN CONTACT WITH SOLUTION:**

**AC-2CP-MD & AC-2AP-MD**  
 - Polypropylene  
 - Ceramic & Viton  
 - Ceramic Magnet

**BC-2CP-MD & BC-2AP-MD**  
 - Polypropylene  
 - Ceramic & Viton

**NOTE:** When attaching the Drive Magnet to the motor shaft, position the face of the Drive Magnet 1/16 inch below the face of the Motor Bracket.

#	DESCRIPTION	MATERIAL	SIZE (Inches)	QTY.	PART #	AC-2CP-MD	AC-2AP-MD	BC-2CP-MD	BC-2AP-MD
1	Self-Tapping Screw	Stainless	#7-19 x 1-7/16 Lg.	6	0115-0062-1000	S	S	S	S
2	Cover	Polypropylene	3/8 FPT x 3/4 MPT	1	0125-0056-1000	S	O	S	O
3	Cover	Polypropylene	3/4 OD Smooth	1	0125-0096-1000	O	S	O	S
4	"O" Ring	Viton	3/32 CS x 2-3/16 OD	1	0125-0065-1000	S	S	S	S
		Buna N	3/32 CS x 2-3/16 OD	1	0125-0066-1000	O	O	O	O
5	Thrust Washer	Ceramic		1	0130-0028-1000	S	S	S	S
6	Shaft	Ceramic		1	0125-0061-1000	S	S	S	S
		Stainless		1	0125-0125-1000	O	O	O	O
7	Impeller Encapsulated	Polypropylene		1	0125-0087-0200	O	O	S	S
8	Impeller Bare Magnet	Polypropylene/Ceramic		1	0125-0055-0100	S	S	O	O
9	Rear Housing	Polypropylene	1/4 MPT	1	0125-0058-1000	S	O	S	O
10	Rear Housing	Polypropylene	1/2 OD Smooth	1	1008-0001-1000	O	S	O	S
11	Drive Magnet		0.250 Bore	1	0125-0083-0100	S	S	S	S
		6mm (Brushless DC Motors ONLY)		1	0125-0083-0200			S (DC)	
12	Screw	Stainless	#8-32 x 3/4 Lg.	4	0210-0036-1000			S (DC)	
13	Screw	Stainless	#8-32 x 1/2 Lg.	4	0150-0015-1000	S	S	S	S
14	Washer	Stainless	#8	4	0858-0004-1000	S	S	S	S
15	Motor Bracket	Plastic		1	0125-0069-1000	S	S	S	S
16	Base	Plastic		1	0125-0106-1000			S (DC)	
17	Motor (DC) 12V Brush			1	0809-0101-1000			S (DC)	
	Motor (DC) 24V Brush			1	0809-0103-1000			S (DC)	
18	Motor (DC) 12V Brushless			1	0125-0127-1000			S (DC)	
	Motor (DC) 24V Brushless			1	0125-0128-1000			S (DC)	
19	Cover & "O" Ring	1/16 CS x 3 OD (Brushless DC Motors ONLY)		1	0125-0133-1000			O (DC)	
20	Motor, 115V, 50/60Hz, Air Cooled			1	0125-0052-1000	S	S	O	O
	Motor, 230V, 50/60Hz, Air Cooled			1	0125-0063-1000	S	S	O	O
21	Motor, 115V, 50/60Hz, Blast Cooled			1	0125-0088-1000	O	O	S	S
	Motor, 230V, 50/60Hz, Blast Cooled			1	0125-0089-1000	O	O	S	S

Legend: S = Standard, O = Option

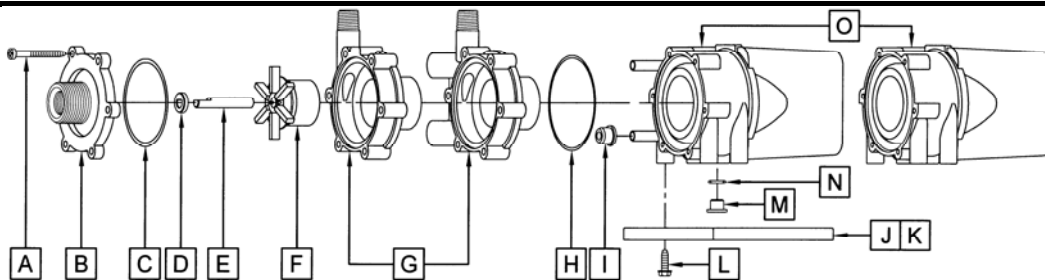

**MATERIALS IN CONTACT WITH SOLUTION:**

- Polypropylene
- Viton
- Stainless Steel
- Ceramic,
- Ceramic Magnet.
- When submerged also Epoxy, Buna N, and cord.

#	2CP-MD	LC-2CP-MD	MATERIAL	SIZE (Inches)	QTY.	2CP-MD	LC-2CP-MD
A	Self-Tapping Screw		Stainless	#7-19 x 1-7/16 Lg.	6	0115-0062-1000	
B	Cover		Polypropylene	3/8 FPT x 3/4 MPT	1	0125-0056-1000	
C	"O" Ring		Viton	3/32 CS x 2-3/16 OD	1	0125-0065-1000	
D	Thrust Washer		Ceramic		1	0130-0028-1000	
E	Shaft		Stainless		1	0125-0125-1000	
F	Impeller with Ceramic Magnet		Polypropylene		1	0125-0055-0100	
G	Rear Housing	Rear Housing & Plug	Polypropylene	1/4 MPT	1	0125-0058-1000	0125-0057-0100
H	Bracket "O" Ring		Viton	1/16 CS x 2-3/8 OD	1	0125-0121-1000	
I	Cooling Tube Seal		Buna N		2		0125-0007-1000
J	Mounting Base		Polypropylene		1	0125-0060-1000	
K	Marine Base (Not Shown) (Option)		Polypropylene & Grommets		1		0125-0113-0100
L	Base Screw		Stainless		4	0125-0130-1000	
M	Plug (Motor Bracket)				1	0125-0110-1000	
N	"O" Ring		Viton	1/16 CS x 7/16 OD	1	0210-0008-1000	
O	Epoxy Motor Assembly	L.C. Epoxy Motor Assembly			n/a	Not Available	

NOTE: Contact Factory for other materials and/or parts not listed.

0125-0076-1000 R20