

The Gemini Series "A" Series Paddles

Refer to Pages E12-E17 For Additional Options

MATERIAL SPECIFICATIONS:

Contacts/Terminals Gold/gold flash
 Silver/tin lead
 Case Material Thermoset 94V-0
 Actuator Material Polyamide
 Terminal Seal Epoxy

ENVIRONMENTAL SPECIFICATIONS:

Operating Temperature -4°F to +185°F (-20°C to +85°C)
 Storage Temperature -49°F to +212°F (-45°C to +100°C)

TYPICAL PERFORMANCE CHARACTERISTICS:

Contact Rating Gold: .04 VA @ 20 AC/DC
 Silver: 2 A @ 250 VAC: 5 A @ 125 VAC
 Initial Contact Resistance 30 Milliohms max.
 Contact Timing Break-before-make
 Insulation Resistance 1,000 Megohms @ 500 VDC
 Dielectric Strength 1,000 Volts RMS @ sea level
 Actuator Travel 25°
 Life Expectancy 30,000 Cycles

NOTE: Part numbering sequence page E12

SPDT

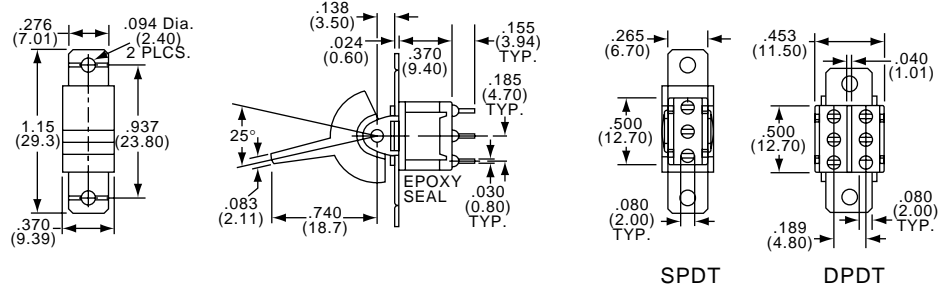

DPDT

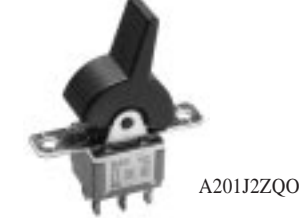

Standard Paddle Color - (Black)

Silver Contacts Model	Type	Act. Code	P. M8	↖	↓	↗	Silver Contacts Model	Type	Act. Code	P. M8	↖	↓	↗
A101J2ZQ0	SPDT	1	On	None	On		A201J2ZQ0	DPDT	2	On	None	On	
A103J2ZQ0	SPDT	5	On	Off	On		A203J2ZQ0	DPDT	6	On	Off	On	
A105J2ZQ0	SPDT	5	(On)	Off	(On)		A205J2ZQ0	DPDT	6	(On)	Off	(On)	
A107J2ZQ0	SPDT	5	On	Off	(On)		A207J2ZQ0	DPDT	6	On	Off	(On)	
A108J2ZQ0	SPDT	1	On	None	(On)		A208J2ZQ0	DPDT	2	On	None	(On)	

SPDT / DPDT

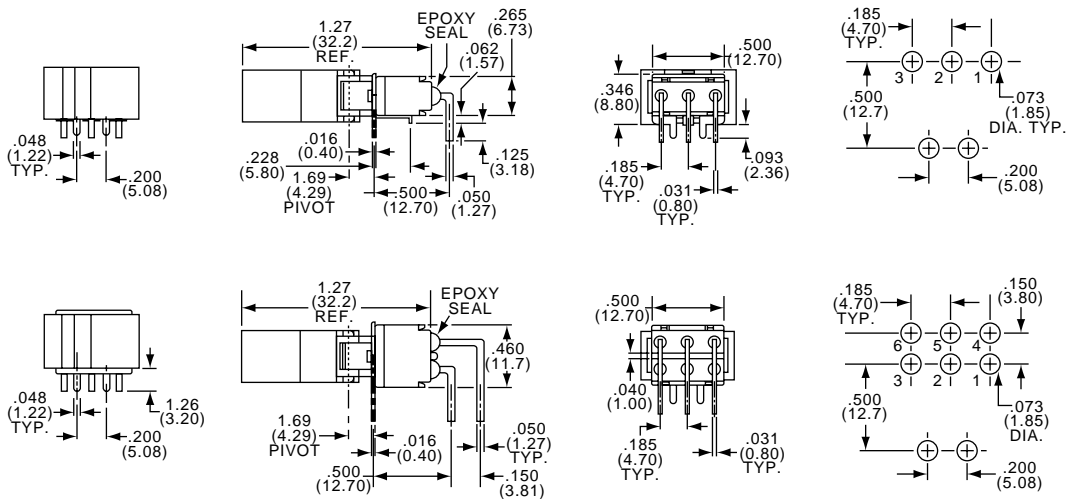
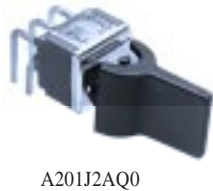

Standard Paddle Color - (Black)

Silver Contacts Model	Type	Act. Code	P. M8	↖	↓	↗	Silver Contacts Model	Type	Act. Code	P. M8	↖	↓	↗
A101J2AQ0	SPDT	1	On	None	On		A201J2AQ0	DPDT	2	On	None	On	
A103J2AQ0	SPDT	5	On	Off	On		A203J2AQ0	DPDT	6	On	Off	On	
A105J2AQ0	SPDT	5	(On)	Off	(On)		A205J2AQ0	DPDT	6	(On)	Off	(On)	
A107J2AQ0	SPDT	5	On	Off	(On)		A207J2AQ0	DPDT	6	On	Off	(On)	
A108J2AQ0	SPDT	1	On	None	(On)		A208J2AQ0	DPDT	2	On	None	(On)	

"A" Series Miniature Rockers
Refer to Page E12-E17 For Additional Options

The Gemini Series

SEE PAGE E8 FOR PRODUCT SPECIFICATIONS

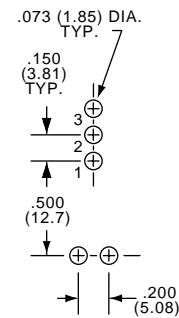
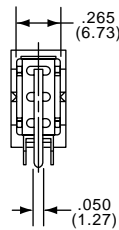
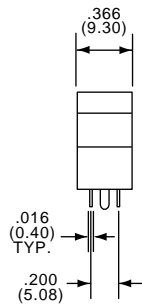
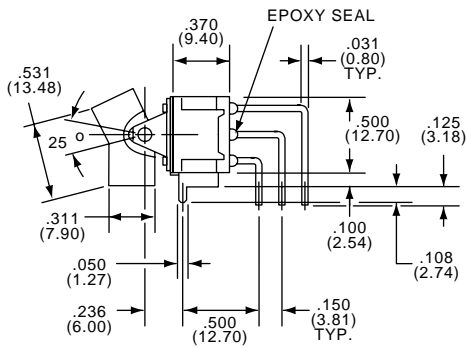

A101J1AV2Q0

SPDT

Silver Contacts Model	Type	Act. Code.	P. M8			
A101J1AV2Q0	SPDT	1	On	None	On	
A105J1AV2Q0	SPDT	5	(On)	Off	(On)	
A107J1AV2Q0	SPDT	5	On	Off	(On)	
A201J1AV2Q0	DPDT	2	On	None	On	
A205J1AV2Q0	DPDT	6	(On)	Off	(On)	
A208J1AV2Q0	DPDT	2	On	None	(On)	

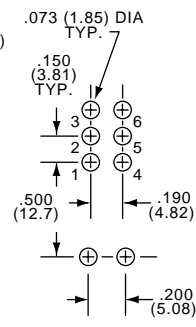
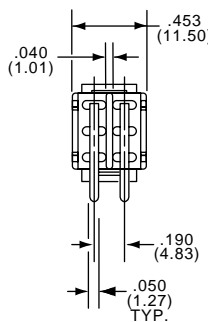
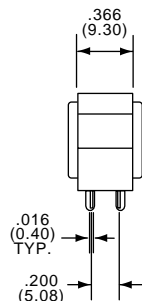

A205J1AV2Q0

Standard Rocker Color - (Black)

DPDT

E

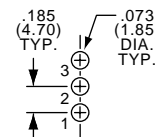
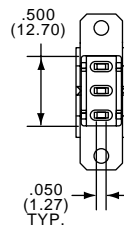
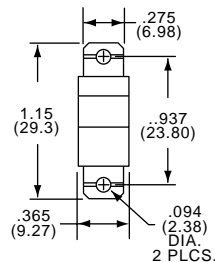
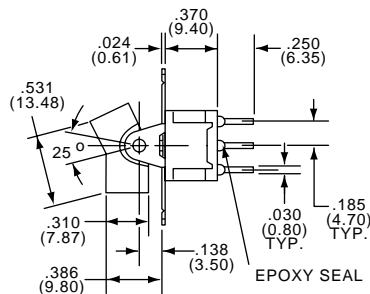

A101J1CQ0

SPDT

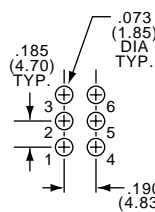
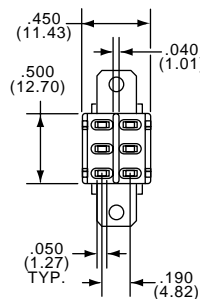
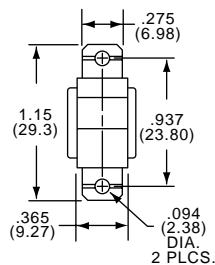

A201J1CQ0

DPDT

Silver Contacts Model	Type	Act. Code.	P. M8			
A101J1CQ0	SPDT	1	On	None	On	
A105J1CQ0	SPDT	5	(On)	Off	(On)	
A201J1CQ0	DPDT	2	On	None	On	
A203J1CQ0	DPDT	6	On	Off	On	
A205J1CQ0	DPDT	6	(On)	Off	(On)	
A207J1CQ0	DPDT	6	On	Off	(On)	

Standard Rocker Color - (Black)

Need more technical information?

Consult your local Augat sales office listed on the back cover

The Gemini Series "A" Series Miniature Rockers

Refer to Pages E12-E17 For Additional Options

SEE PAGE E8 FOR PRODUCT SPECIFICATIONS

SPDT



A101J1ZQO

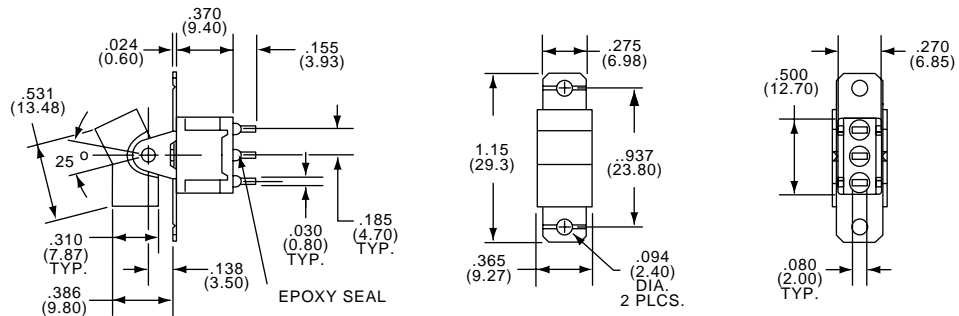

DPDT



A201J1ZQO

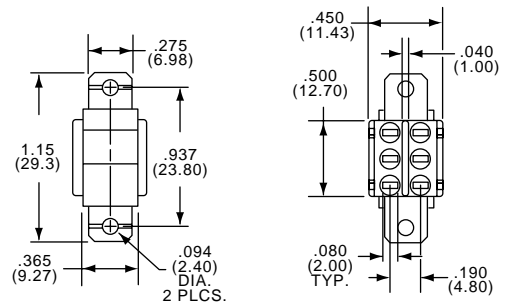

Standard Rocker Color - (Black)

Silver Contacts						Silver Contacts							
Model	Type	Act. Code.	P. M8				Model	Type	Act. Code.	P. M8			
A101J1ZQO	SPDT	1		On	None	On	A201J1ZQO	DPDT	2		On	None	On
A103J1ZQO	SPDT	5		On	Off	On	A203J1ZQO	DPDT	6		On	Off	On
A105J1ZQO	SPDT	5	(On)	Off	(On)		A205J1ZQO	DPDT	6	(On)	Off	(On)	
A107J1ZQO	SPDT	5		On	Off	(On)	A207J1ZQO	DPDT	6		On	Off	(On)
A108J1ZQO	SPDT	1		On	None	(On)	A208J1ZQO	DPDT	2		On	None	(On)

SPDT



A101J1AQO

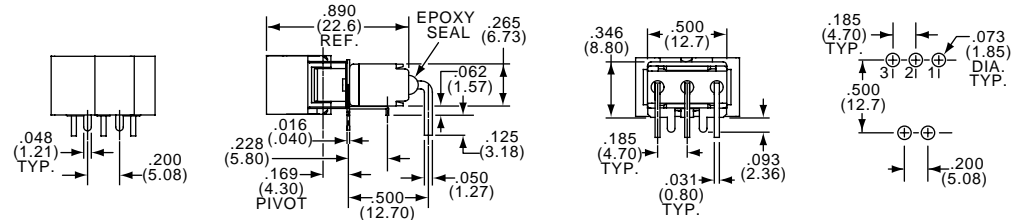

DPDT



A201J1AQO

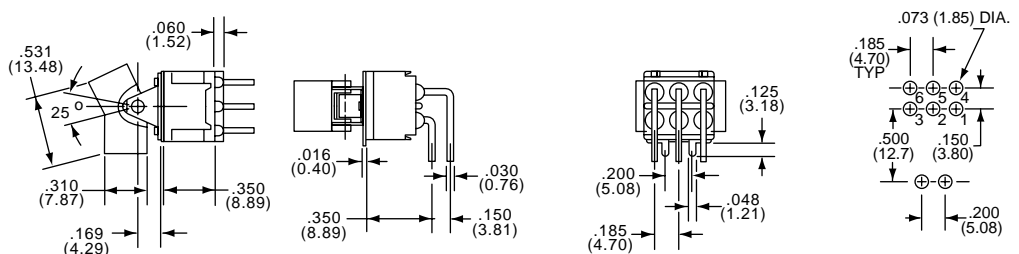

Standard Rocker Color - (Black)

Silver Contacts						Silver Contacts							
Model	Type	Act. Code.	P. M8				Model	Type	Act. Code.	P. M8			
A101J1AQO	SPDT	1		On	None	On	A201J1AQO	DPDT	2		On	None	On
A105J1AQO	SPDT	5	(On)	Off	(On)		A203J1AQO	DPDT	6		On	Off	On
A107J1AQO	SPDT	5		On	Off	(On)	A205J1AQO	DPDT	6	(On)	Off	(On)	

"A" Series Paddles
Refer to Page E12-E17 For Additional Options

The Gemini Series

SEE PAGE E8 FOR PRODUCT SPECIFICATIONS

SPDT / DPDT

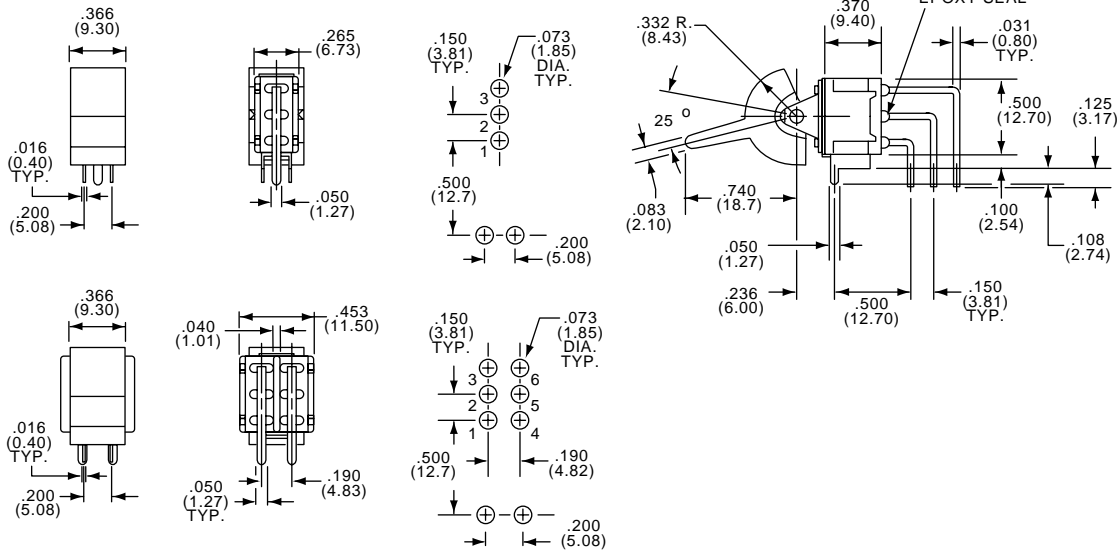

A105J2AV2Q0

Standard Paddle Color - (Black)

Silver Contacts Model	Type	Act. Code	P. M8	⏏	⏏	⏏	Silver Contacts Model	Type	Act. Code	P. M8	⏏	⏏	⏏
A101J2AV2Q0	SPDT	1		On	None	On	A201J2AV2Q0	DPDT	2		On	None	On
A105J2AV2Q0	SPDT	5		(On)	Off	(On)							

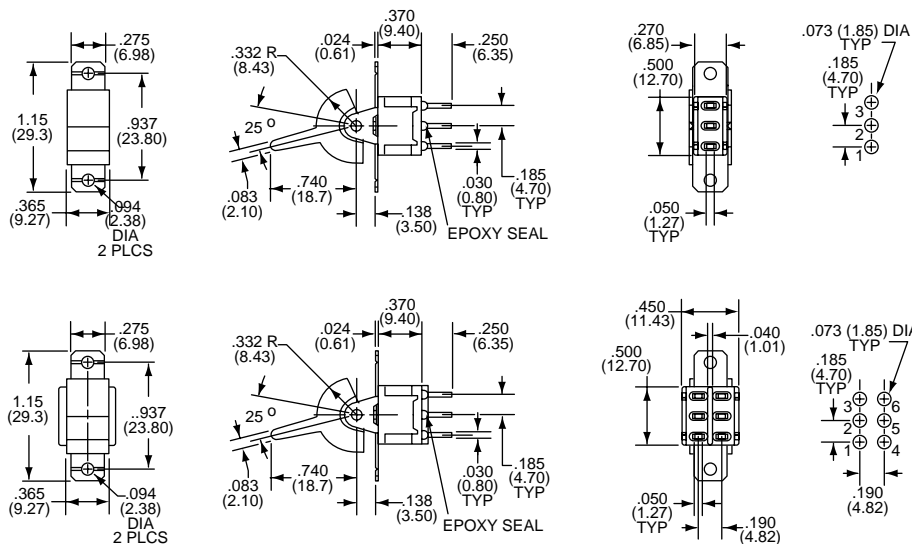

SPDT



A105J2CQ0

DPDT



A205J2CQ0

Silver Contacts Model	Type	Act. Code	P. M8	⏏	⏏	⏏	Silver Contacts Model	Type	Act. Code	P. M8	⏏	⏏	⏏
A105J2CQ0	SPDT	5		(On)	Off	(On)	A201J2CQ0	DPDT	2		On	None	On
							A205J2CQ0	DPDT	6		(On)	Off	(On)

Need more technical information?

Consult your local Augat sales office listed on the back cover

AUGAT Inc.
452 John L. Dietsch Blvd.
Attleboro Falls, MA 02763 USA
(508) 699-9800 FAX (800) 533-2526

The Gemini Series "A" Series Miniature Rockers/Paddles

BEZELS FOR ROCKER AND PADDLE SWITCHES

Model	Panel Dimensions		(*) Specify Colors
	A	B	
B10(*)	.797-.803 (20.24)-(20.40)	.495-.505 (12.57)-(12.83)	(0) Black, (1) Brown, (2) Red, (3) Orange, (4) Yellow, (5) Green, (6) Blue, (8) Gray & (9) White
B20(*)	.595-.605 (15.11)-(15.37)	.495-.500 (12.57)-(12.70)	(0) Black, (1) Brown, (2) Red, (3) Orange, (4) Yellow, (5) Green, (6) Blue, (8) Gray & (9) White

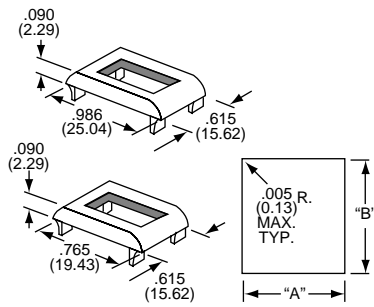

DESIGN

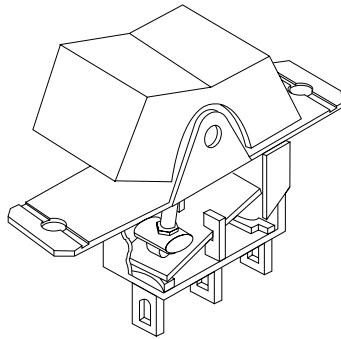

SP

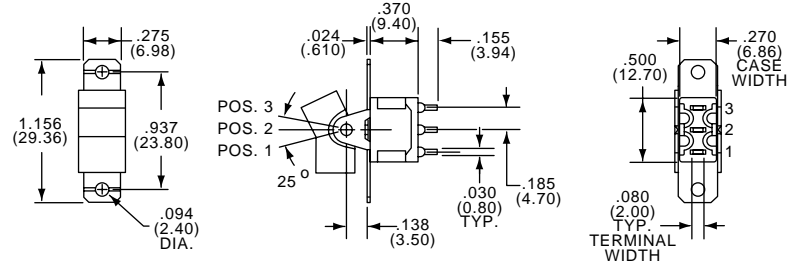

DP

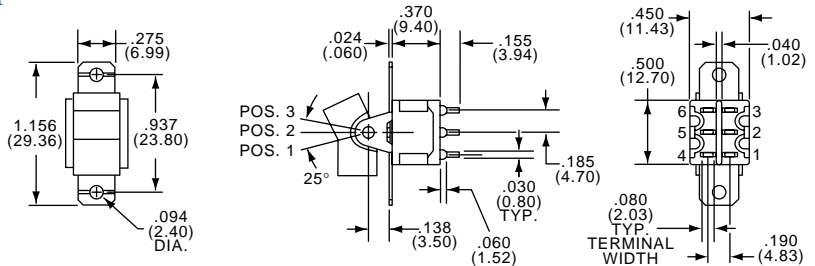

PART NUMBERING

Model	Function	Actuator	Terminal	Contact	Actuator Color	Beveled Frame Color	Option
A1	Single Pole	J1 Small	Z Wire Lug	Q Silver	0 Black (Std.)	0 Black (Std.)	UL (Q or G) contacts only
A2	Double Pole	J3 Large	A Right Angle	B Gold	1 Brown	1 Brown	
01	On-On	J15 Snap-in	AV2 Vert. Right Angle	G Gold over Silver	2 Red	2 Red	
03	On-Off-On	J16 Snap-in w/beveled frame	C Printed Circuit		3 Orange	3 Orange	
05	(On)-Off-(On)	J50 Snap-in	V5 Vertical Right Angle		4 Yellow	4 Yellow	
07	On-Off-(On)	J51 Snap-in w/beveled frame	V3 V4 V6 Vertical Support Bracket		5 Green	5 Green	
08	On-(On)	J52 Snap-in w/beveled frame LED	V7 V8 V9		6 Blue	6 Blue	
11	On-On-On		W W1 W3 W4 W5		8 Gray	8 Gray	
13	On-On-(On)	J2 Small	Z3 Quick Connect		9 White	9 White	
15	(On)-On-(On)	J4 Large					
		J5 Large					
		J60 Snap-in					
		J61 Snap-in w/beveled frame					
		J62 Snap-in w/beveled frame & LED					

OPTIONAL:

UL recognized under the Component Program of Underwriters Laboratories Inc. File # E46765
CSA Certified File #LR65901

See pages M2-M4 for application specific indexing.

"A" Series Miniature Rockers/Paddles The Gemini Series

FUNCTIONS

The following functions available in SP or DP.

01	2 Positions	None indicates no mechanical position
03	3 Positions	
05	3 Positions	Off indicates a mechanical position with no electrical connection.
07	3 Positions	
08	2 Positions	(On) indicates momentary action.

SPDT, connect terminals:

DPDT, connect terminals:

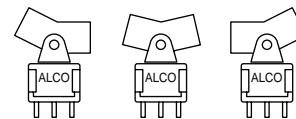

On None On

On Off On

(On) Off (On)

(On) Off On

(On) None On



On On On

(On) On On

(On) On (On)

11 3 Positions

13 3 Positions

15 3 Positions

Functions available in DP only: Connect terminals:

SP3T Available in DP format only

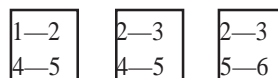

Wiring Diagram for Functions

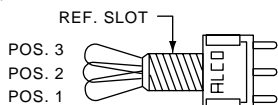

11 **13** **15**

SINGLE POLE 3 POSITION

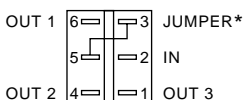

SP3T function achieved with external jumpers.
* Installed by Customer

POS. 1

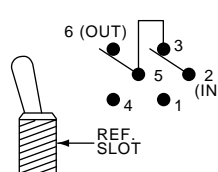

POS. 2

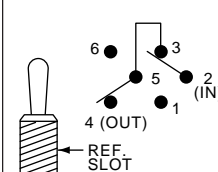

POS. 3

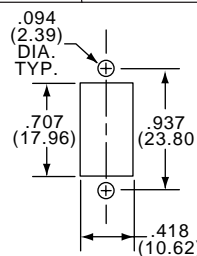
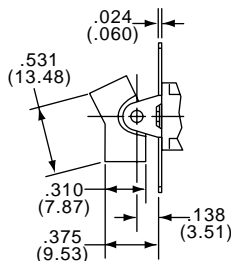
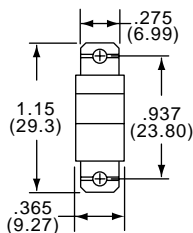
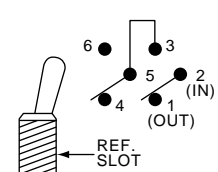

ACTUATORS

Rockers **J1**

Small

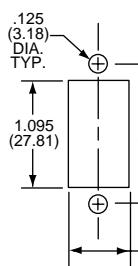
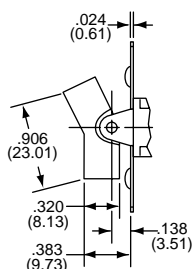
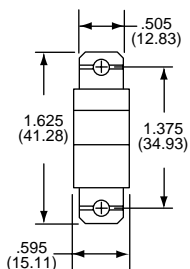
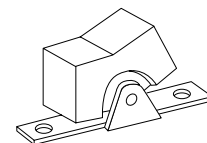

J3

Large

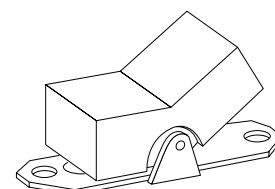

Use beveled frame B100 for enhancement (Pg.E12) when ordering with terminations other than C or Z.

Need more technical information?

Consult your local Augat sales office listed on the back cover



The Gemini Series "A" Series Miniature Rockers/Paddles

ROCKER

J50

Snap-in

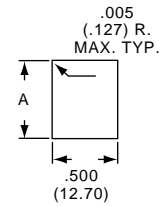
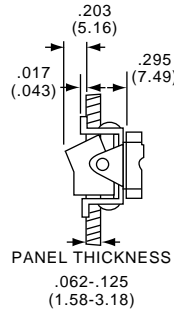
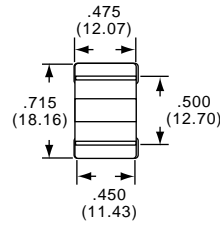
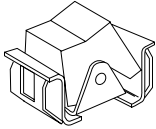

Use Beveled Frame B200 for enhancement (Pg. E12) when ordering with terminations other than C or Z.

	Panel Opening		
Panel Thickness	.062	.093	.125
"A"	.600-.605	.610-.615	.620-.625

J51

Snap-in with beveled frame

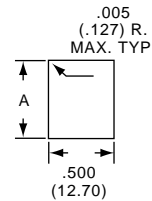
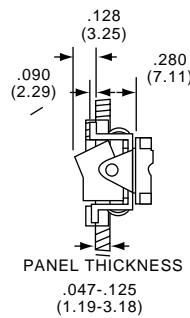
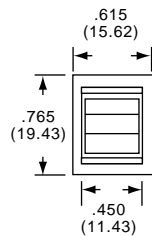
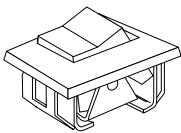

	Panel Opening		
Panel Thickness	.062	.093	.125
"A"	.600-.605	.610-.615	.620-.625

J52

Snap-in with beveled frame/L.E.D.

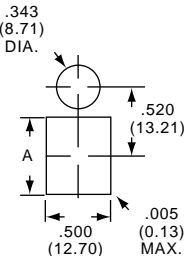
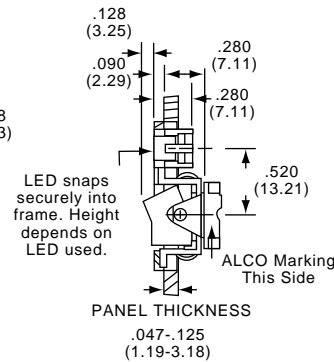
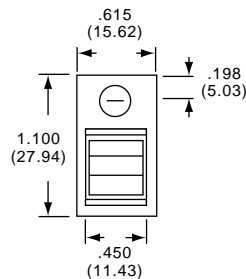
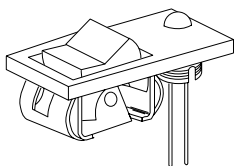

L.E.D. Not supplied.

Accepts BL-17 or equivalent LED

	Panel Opening		
Panel Thickness	.062	.093	.125
"A"	.600-.605	.610-.615	.620-.625

PADDLE

J2

Small

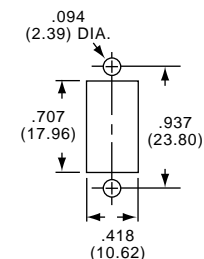
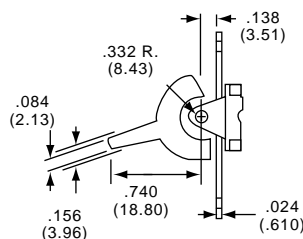
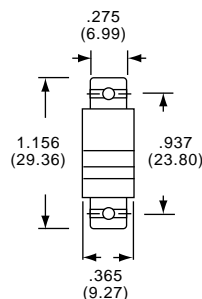
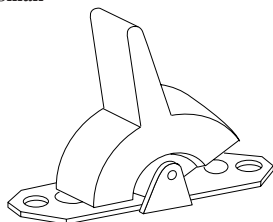

Use Beveled frame B100 for enhancement (Pg. E12) when ordering with terminations other than C or Z.

"A" Series Miniature Rockers/Paddles The Gemini Series

J4
J5

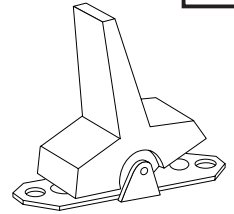
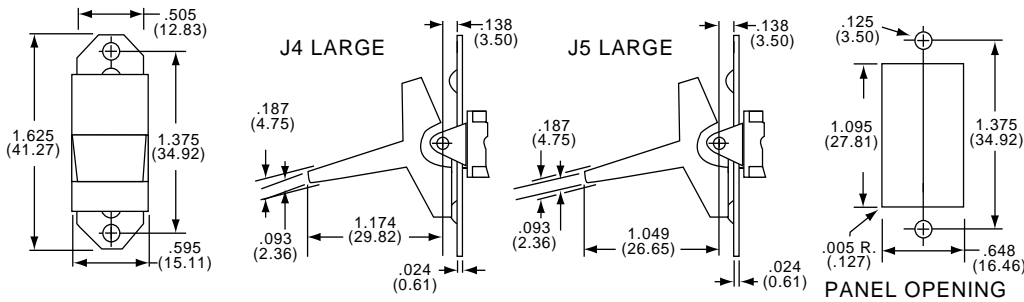

Snap-In **J15**

Snap-in with beveled frame **J16**

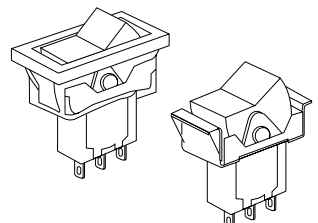
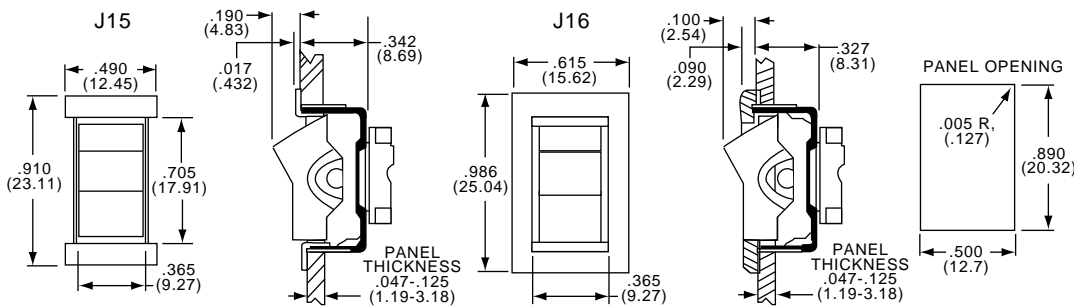

Snap-in **J60**

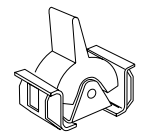
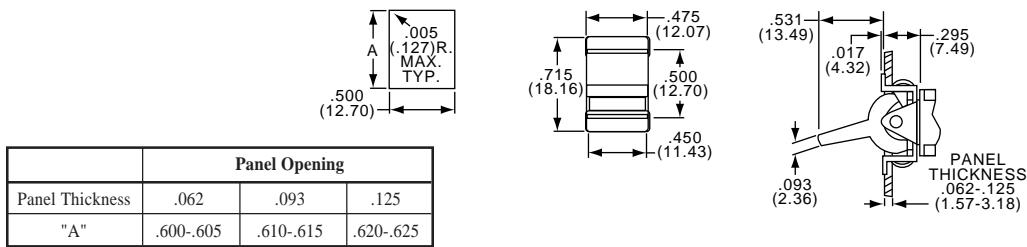

Use Beveled Frame B200 for enhancement (Pg. E12) when ordering with terminations other than C or Z.

Snap-in with beveled frame **J61**

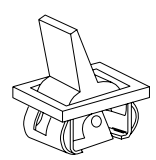
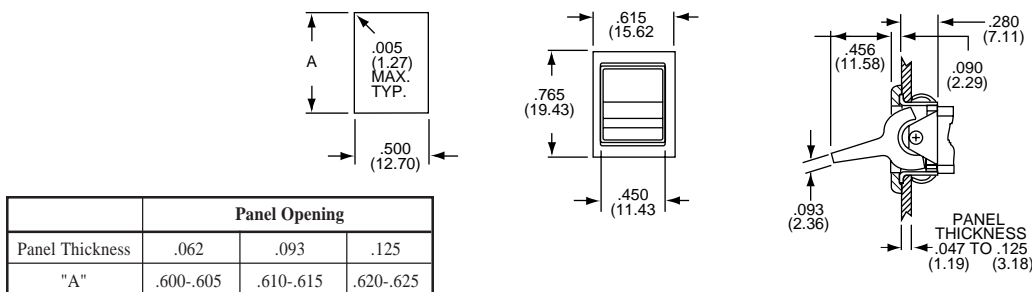

Snap-in with beveled frame/LED **J62**

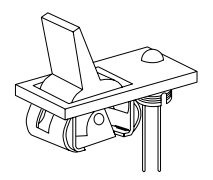
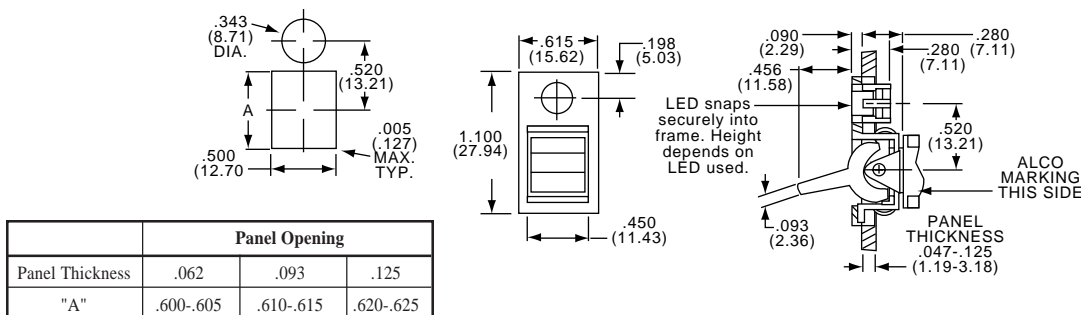

Accepts BL-17 or equivalent LED

Need more technical information?

Consult your local Augat sales office listed on the back cover

The Gemini Series "A" Series Miniature Rockers/Paddles

TERMINALS

Z

Wire Lug Standard

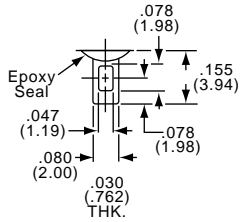

Z3

Quick Connect

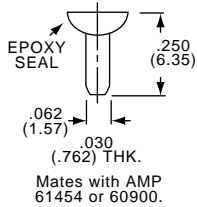

W

Wire Wrap

	"A"
W	.750
W1	.964
W3	.425
W4	1.062
W5	1.305

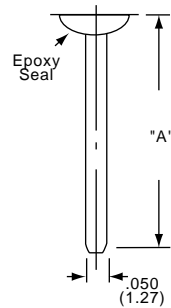

C

Printed Circuit

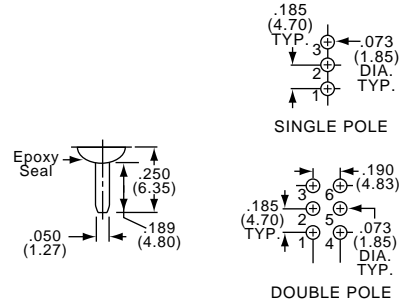

A

Right Angle Single Pole

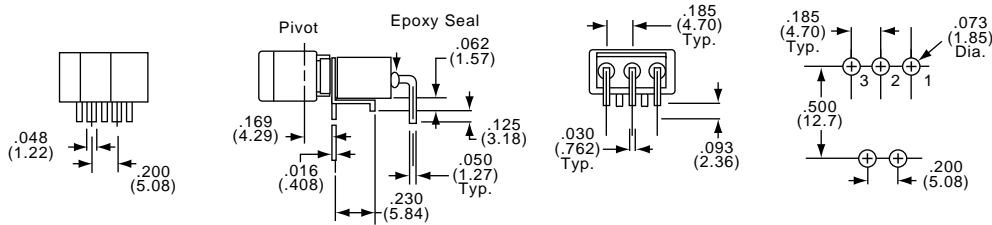

NOTE: Terminal numbers viewed from top of P.C. board.

Right Angle Double Pole

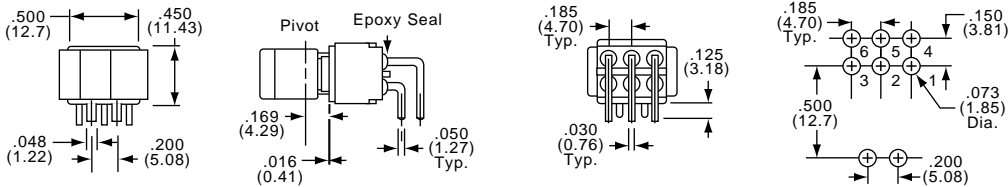

NOTE: Terminal numbers viewed from top of P.C. board.

AV2

Vertical Right Angle Single Pole

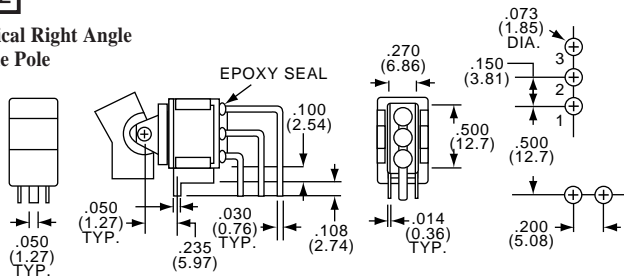

NOTE: Terminal numbers viewed from top of P.C. board.

V5

Vertical Right Angle Double Pole

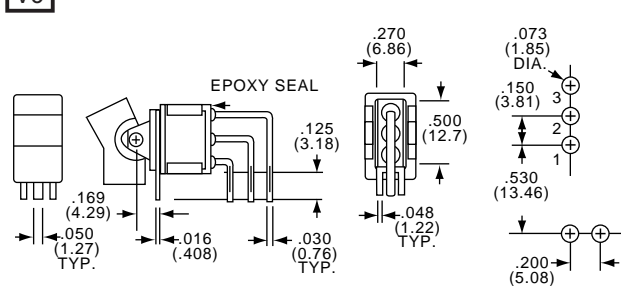

NOTE: Terminal numbers viewed from top of P.C. board.

Right Angle Double Pole

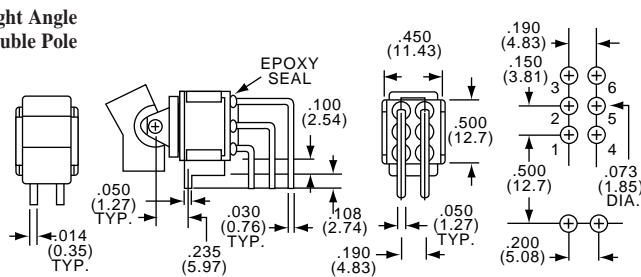

NOTE: Terminal numbers viewed from top of P.C. board.

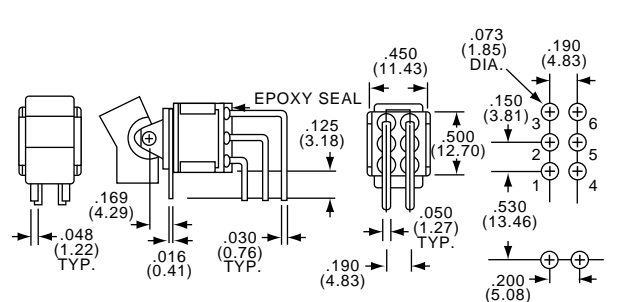

"A" Series Miniature Rockers/Paddles The Gemini Series

V3 V4 V9

Vertical Support Bracket
Single Pole

Option Code	Dim. "A"
V3	.460 (11.68)
V4	.630 (16.00)
V9	1.150 (29.21)

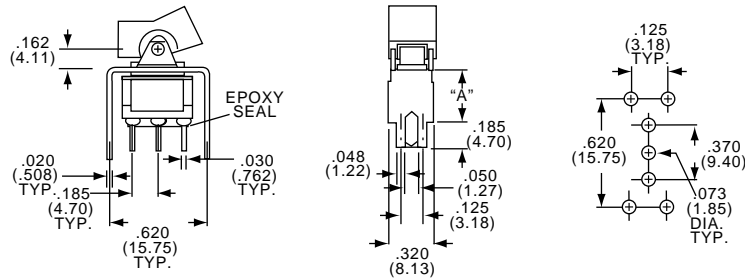

Vertical Support Bracket
Double Pole

Option Code	Dim. "A"
V3	.460 (11.68)
V4	.630 (16.00)
V9	1.150 (29.21)

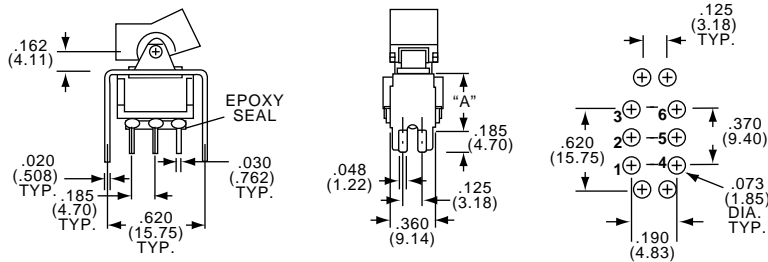

V6 V7 V8

Vertical Support Bracket
Single Pole

Option Code	Dim. "A"
V6	.460 (11.68)
V7	.630 (16.00)
V8	.953 (24.21)

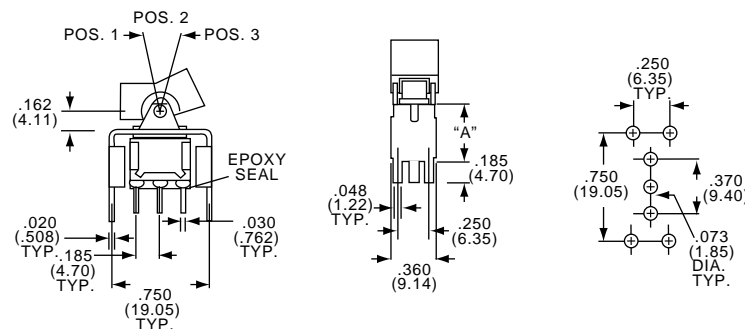

Vertical Support Bracket
Double Pole

Option Code	Dim. "A"
V6	.460 (11.68)
V7	.630 (16.00)
V8	.953 (24.21)

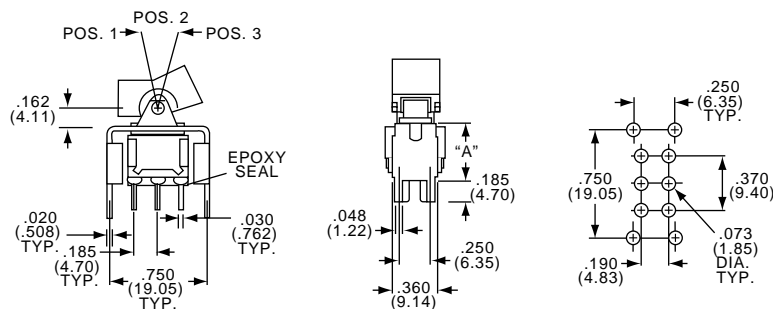

CONTACTS

B CONTACTS: Copper alloy with gold plate, welded button.

TERMINALS: Copper alloy with gold plate.

ELECTRICAL RATING: 0.4VA @ 20 VAC/DC.

Q CONTACTS: Copper alloy with silver, welded button.

TERMINALS: Copper alloy with tin/lead plate.

ELECTRICAL RATING: 5 A @ 125 VAC, 2 A @ 250 VAC, 5 A @ 28 VDC. UL/CSA RATING: 5A @ 125 VAC, 3 @ 250 VAC (Specify "UL" option code)

G CONTACTS: Copper alloy with gold plate over silver, welded button.

TERMINALS: Copper alloy with gold plate.

ELECTRICAL RATING: 0.4 VA @ 20 VAC/DC or 5 A @ 125 VAC, 2 A @ 250 VAC, 5 A @ 28 VDC.

Note: This contact option can be used for low-level or power switching. If level is above 0.4 VA @ 20 VAC/DC, the switch is rendered usable only for power switching due to arc-removal of gold plate.

UL/CSA RATING: 5A @ 125 VAC, 3 @ 250 VAC (Specify "UL" option code)

Need more technical information?

Consult your local Augat sales office listed on the back cover