

IPC-611

4U 14-Slot Rackmount Chassis with Front-accessible Fan



Features

- User-friendly and front-accessible filter for system maintenance
- Visible power and HDD activity notification improves system availability
- Compatible with Dialogic computer telephony (CT) boards, and provides access to the widest range of call processing applications
- Advanced cooling system with one system fan optimally placed to cool system key components
- Shock-resistant disk drive bay holds three 5.25" and one 3.5" front-accessible disk drives
- Flexible mechanical design supports both 300 W ATX PFC PS/2 power supply and 300 W ATX PFC redundant power supply



Introduction

IPC-611 is a 4U-high 14-slot rackmount IPC chassis designed for building mission-critical applications. This rugged, all-steel chassis meets EIA RS-310C 19" rackmount standard. IPC-611 comes with four shockproof and front accessed drive bays, three 5.25" & one 3.5". The unit includes a versatile 14-slot passive-backplane and ATX M/B form factor, a high-efficiency 250 W ATX with PFC (Power Factor Correction) power supply and one easy maintenance cooling fan which provides abundant cooling. For high-density requests, IPC-611 supports 12 full-length slots for high-density applications. The flexible mechanical design provides PS/2 size single or redundant power supply through a power bracket replacement. A wide range of standard computing peripherals can be integrated with the chassis to meet application development under mission-critical environments 24 hours a day, 7 days a week.

Specifications

Drive Bay	3.5"	Front-accessible	1
	5.25"		3
Cooling	Fan		1 (84 CFM/each)
	Air Filter		Yes
Miscellaneous	Slide Rail	General Device C-300 series supported (not included)	
	Indicator	LED displays for power on and HDD activity	
	Rear Panel	D-SUB 9-pin and 25-pin bracket	
Environment	Temperature	Operating	Non-Operating
		0 ~ 40 °C (32 ~ 104 °F)	-20 ~ 60 °C (-4 ~ 140 °F)
	Humidity	--	10 ~ 95 % @ 40 °C, non-condensing
	Vibration (5-500 Hz)	1 Grms	2 G
	Shock	10 G (With 11 msec duration, 1/2 sine wave)	30 G
	Acoustic Noise	Less than 52 dB sound pressure at 5 ~ 28 °C (-4 ~ 82 °F)	
Physical	Altitude	0 to 3048 m (0 ~ 10,000 ft)	
	Dimensions (W x H x D)	482 x 177 x 480 mm (19" x 7" x 18.9")	
	Weight	10.2 Kg (22.5 lb)	

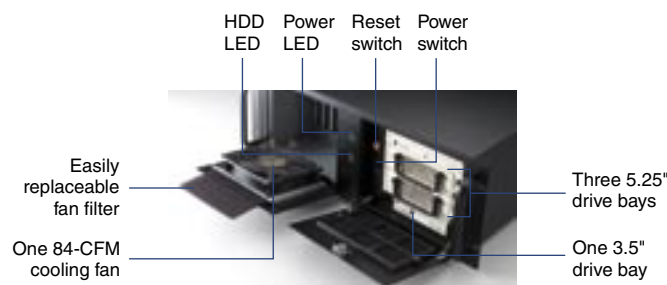

Hold-down clamp Max. 14-slot backplane

Dimension Diagram

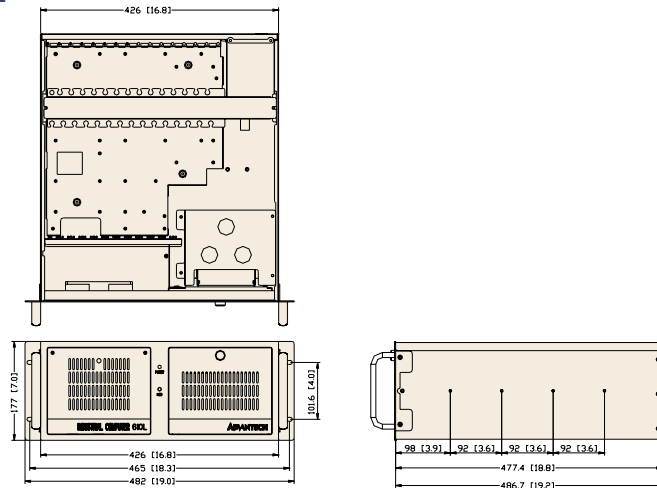

Unit: mm (inch)

Power Supply Options

Part Number	Watt	Input	Output	Specifications		
				Mini-load	Safety	MTBF
PS-250ATX-Z (ATX, PFC)	250 W	AC 95 ~ 132 V AC 190 ~ 264 V (Selectable)	+5 V @ 27 A, +3.3 V @ 20 A +12 V @ 13 A, -12 V @ 0.8 A -5 V @ 0.3 A, +5 Vsb @ 2 A	+5 V @ 0.5 A +12 V @ 0.3 A	UL/cUL (60950 3rd) CE (EN61000-3-2 Class D) TUV/FCC/CSA/Nemko CB/CCC	100,000 hours @ 25 °C full load
RPS-300ATX-Z (ATX, PFC)	300 W	AC 90 ~ 264 V (Full-range)	+5 V @ 25 A, +3.3 V @ 18 A +12 V @ 16 A, -12 V @ 0.5 A -5 V @ 0.5 A, +5 Vsb @ 2 A	+5 V @ 3 A +3.3 V @ 1 A +12 V @ 2 A +5 Vsb @ 0.1 A	UL/cUL (60950 3rd) CE (EN61000-3-2 Class D) FCC/CB/CCC/TUV	150,000 hours @ 25 °C full load
PS-310-DC48 (AT)	310 W	DC -38 ~ -58 V	+5 V @ 25 A, +12 V @ 10 A -5 V @ 1 A, -12 V @ 5 A	+5 V @ 2 A	UL/CSA/CE	100,000 hours @ 25 °C
PS-300ATX-ZB (ATX, PFC)	300 W	AC 90 ~ 264 V (Full-range)	+5 V @ 30 A, +3.3 V @ 28 A +12 V @ 15 A, -12 V @ 0.8 A -5V @ 0.8 A, +5 Vsb @ 2 A	+5 V @ 0.1 A +3.3 V @ 0.1 A	UL/cUL (60950 3rd) CE (EN61000-3-2 Class D) TUV/FCC/CSA/Nemko CB/CCC	100,000 hours @ 25 °C full load

Passive Backplane Options

Part Number	Slot	Segment
PCA-6113P4R-0C1	7 ISA, 4 PCI, 2 PICMG	Single
PCA-6113P7X	4 ISA, 7 PCI (64-bit), 2 PICMG	Single
PCA-6114P4-C	8 ISA, 4 PCI, 2 PICMG	Single
PCA-6114P7-0D2	4 ISA, 6 PCI, 3 PICMG, 1 PCI/ISA	Single
PCA-6114P10-B	2 ISA, 10 PCI, 2 PICMG	Single
PCA-6114P12-0B1	1 ISA, 11 PCI, 1 PICMG/PCI, 1 PICMG	Single
PCA-6114-0B1	14 ISA	Single
PCA-6114P12X-A1	1ISA, 11PCI, 1PICMG, 1PICMG/PCI	Single



Rear panel of backplane version

Ordering Information

Part Number	With Power Supply	With Backplane	Regulation
IPC-611BP-00P	Without power supply, with AT switch	--	None
IPC-611BP-00X	Without power supply, with ATX switch	--	None
IPC-611BP-25Z	PS-250ATX-Z	--	UL, cUL, CE
IPC-611P4-25Z	PS-250ATX-Z	PCA-6114P4-C	UL, cUL, CE
IPC-611BP-30Z	PS-300ATX-ZB	--	UL, cUL, CE