

# RMC-3A-2

## Applications

Internet Server (Web / Mail)

Telephony / Telecom / VoIP

Network / Security Appliance

Military Application

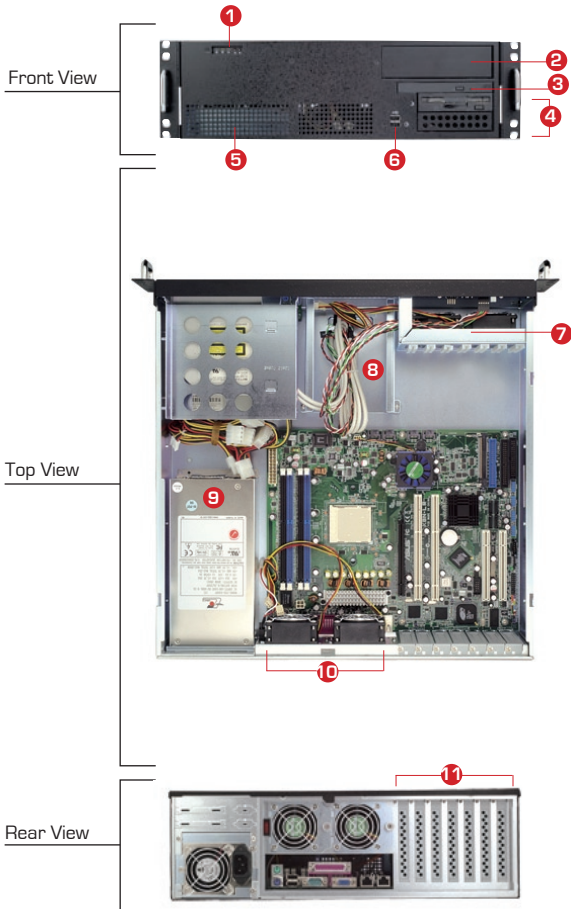

## Features & Benefits

- 1 Power on/off, system reset and LEDs for HDD & LAN
- 2 One(1) external 5.25-inch bay supported
- 3 One(1) external slim CD-ROM supported
- 4 Two(2) external 3.5-inch bay supported
- 5 Superior cooling through front air intake
- 6 Front access dual USB port
- 7 Two(2) front fans for optimized cooling
- 8 Two(2) internal 3.5-inch HDD supported
- 9 Single power supply
- 10 Two(2) easy-swap rear fans for optimized cooling
- 11 Seven(7) PCI slots attribute to network expansion and scalability

# RMC-3A-2

Model Number : RMC-3A-2	
Order Information : RMC-3A-●-2	
Industry Standard : EIA-RS310D	
Materials : Heavy-duty cold-rolled steel	
Finish :	Inside / Body : Zinc-plated with bright chromate
	Outside / Front : Texture-coated
Dimensions : (W x D x H)	mm : 482.6 x 431.8 x 133.35
	inches : 19 x 17 x 5.25
Cooling :	Middle: 2 x 60x25mm (optional 60x38mm upgrade)
	Rear: 2 x 60x25mm easy-swap
Power Supply :	● Descriptions
	30X 300W ATX PFC 40X 400W ATX PFC
Expansion : 7 x PCI slots (full height)	
Controls : Power on/off and system reset + 2 x USB ports	
Indicators : Power, LAN and HDD LED's	
System Board : Up to 12"(W) x 9.6"(D) ATX compliant motherboard	

Drive Bay :	External	5.25"	1
		3.5"	2
		3.5" hot-swap	0
		2.5" hot-swap	0
	Internal	3.5"	2
Slim CD-Rom/DVD-Rom		1	
Slim FDD		0	
Temperature : 0°C(32°F) ~ 50°C(122°F)			
Humidity : 5%~95% non-condensing			
Gross Weight : 12 kgs / 26.4 lbs			
Packaging Dimension (W x D x H) :		mm : 600 x 590 x 280	
Cubic Feet : 3.5			
Reference Container Loading :	20'	300	
	40'	600	
	40' H	685	
Mounting Options :	BR-2U03	BR-2U05	
	SR-20	SR-26	

## Mechanical Drawing

