



Maintenance-Free Rechargeable Sealed Lead-Acid Battery



BP28-12

The battery is constructed by plates, separators, safety valves and container. Since the electrolyte is held by a glass-mat separator and plates, the battery can use in any direction and position without leakage.

PERFORMANCE SPECIFICATIONS

| | |
|---|--|
| Nominal Voltage(V)..... | 12 volts(6cells in series) |
| Nominal Capacity(AH) | |
| 20 hour rate F.V.(1.75V/cell) (1400mA to 10.50volts) | 28.0A.H. |
| 10 hour rate F.V.(1.75V/cell) (2660mA to 10.50volts)..... | 26.6A.H. |
| 5 hour rate F.V.(1.75V/cell) (4760mA to 10.50volts) | 23.8A.H. |
| 1 hour rate F.V.(1.55V/cell) (16800mA to 9.30volts)..... | 16.8A.H. |
| Approximate Weight..... | 9600g(21.17lbs) |
| Terminal | |
| Standard..... | Type B1 |
| Optional..... | Type T2,I1 |
| Internal Resistance (Fully Charged Battery)..... | <10mΩ |
| Maximum Discharge Current For 5 sec.(A)..... | 420A |
| Maximum Charge Current(A)..... | 8.4A |
| Ambient Temperature | |
| Charge..... | 0°C(32°F)~40°C(104°F) |
| Discharge..... | -20°C(-4°F)~50°C(122°F) |
| Storage..... | -20°C(-4°F)~40°C(104°F) |
| Vibration test: | |
| Frequency: 16.7HZ | |
| Amplitude: 4mm | |
| Vibrate the battery horizontally or vertically for 60 minutes. The battery have no abnormality. | |
| Case..... | ABS |
| Dimension(mm/inch) | |
| Length ±1.5mm..... | 175/6.89 |
| Width ±1.5mm..... | 166/6.54 |
| Container Height ±1.5mm..... | 125/4.92 |
| Total Height ±1.5mm..... | 125/4.92 |
| Application..... | Wheelchairs, Lawn Mowers, Electronic Medical Equipment, UPS, Golf-Carts. |

BP28-12 Battery discharge characteristics (25°C/77°F)

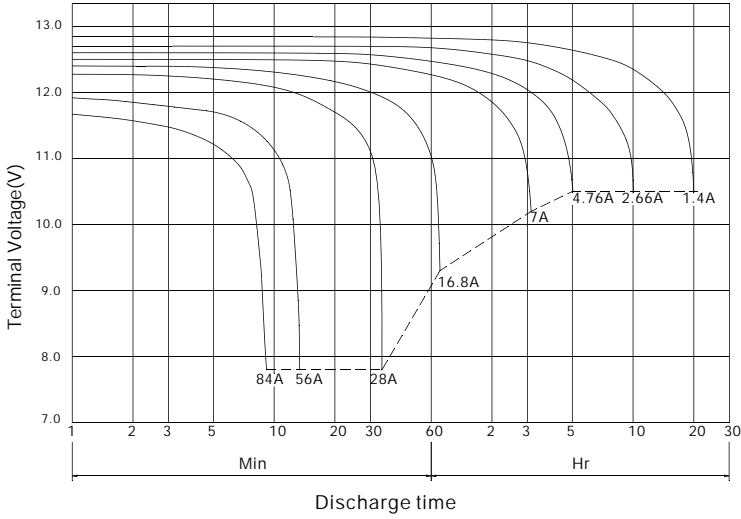

BATTERY CHARGING CHARACTERISTICS (Typical example of the charge characteristics for the standby use)

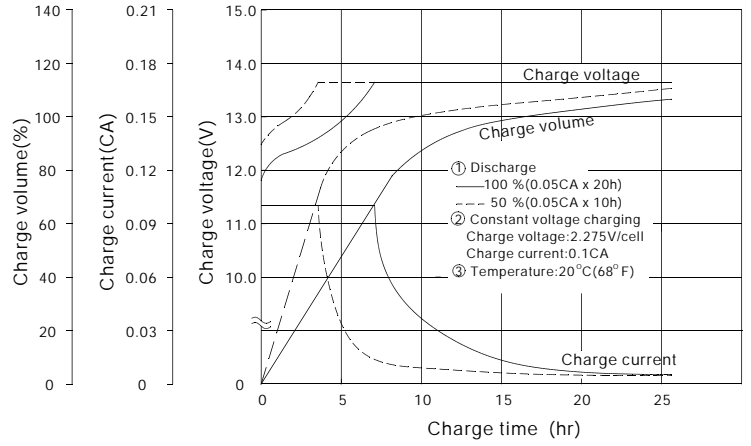

Charging Procedure

| Application | Charging method | Charging Voltage at 20°C (V/cell) | Temperature compensation coefficient of charging voltage (mV/°C/cell) | Max. charging current (CA) | Charging time 0.1CA, 20°C (h) | | Temp (°C) |
|--------------------------|---|-----------------------------------|---|----------------------------|-------------------------------|---------------|-----------------|
| | | | | | 100% discharge | 50% discharge | |
| For standby power Source | Constant voltage & Constant current charging (with current restriction) | 2.25-2.30 | -3 | 0.3 | 24 | 20 | 0-40 (32-104°F) |
| For cycle service | | | | | 16 | 10 | |

*Temperature compensation of charging voltage is not needed, when using the batteries within 5°C to 35°C range.

Effect of Temperature on Long Term Float Life

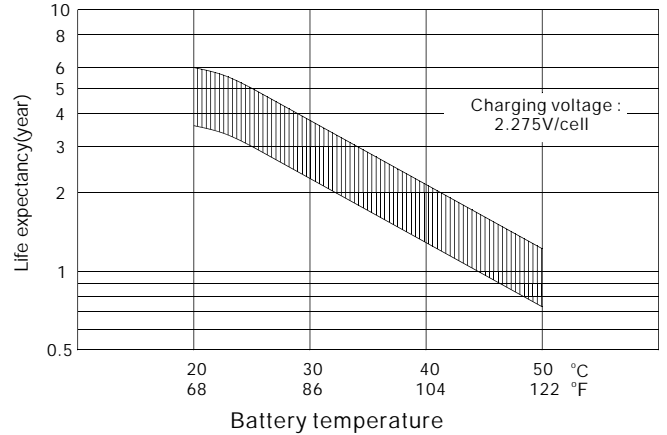

OUTER DIMENSIONS

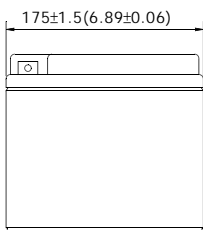
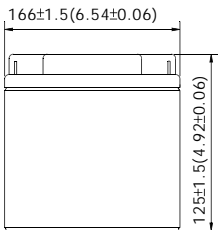
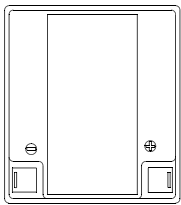

TERMINAL TYPE

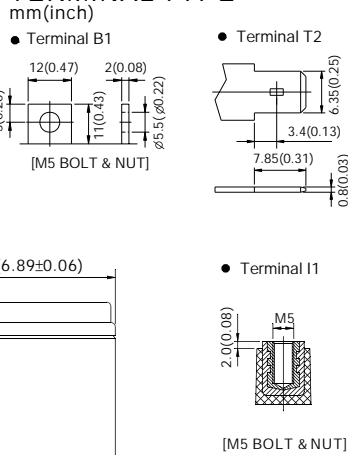

Constant power discharge characteristics at 25°C/77°F

| Final Voltage | Discharge time | | | | | | | | |
|---------------|-------------------------|-------|-------|-------|--------|-------|-------|-------|-------|
| | 5Min | 10Min | 15Min | 30Min | 1Hr | 3Hr | 5Hr | 10Hr | 20Hr |
| | Battery output power(W) | | | | | | | | |
| 10.80V | 1012.3 | 745.3 | 597.2 | 355.3 | 203.79 | 81.62 | 56.27 | 31.45 | 16.44 |
| 10.50V | 1171.7 | 807.4 | 624.7 | 368.8 | 209.90 | 83.25 | 57.12 | 31.92 | 16.80 |
| 10.20V | 1245.0 | 836.4 | 644.0 | 377.3 | 213.67 | 84.00 | 57.43 | 32.08 | 16.88 |
| 9.90V | 1300.9 | 856.5 | 658.8 | 382.6 | 216.24 | 84.58 | 57.63 | 32.18 | 16.92 |
| 9.60V | 1344.0 | 873.6 | 672.0 | 386.4 | 218.40 | 85.09 | 57.81 | 32.18 | 16.92 |

TERMINAL POSITION

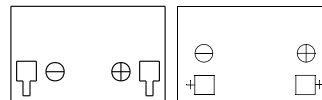

B.B. BATTERY CO., LTD. Web Site: <http://www.bb-battery.com>

USA :

B&B BATTERY (USA) INC.
 6415 RANDOLPH ST. COMMERCE,
 CA, 90040 U.S.A.
 TEL: 1-323-278-1900 1-800-278-8599
 FAX: 1-323-278-1268

CHINA FACTORY:

CHENG DONG TRIAL AREA, HUANG GANG,
 RAOPING GUANG DONG, CHINA, 515700
 TEL: 86-768-7601001-2
 FAX: 86-768-7601469

UK:

B & B BATTERY (UK) CO., LTD.
 TEL: 44-161-339-9458
 FAX: 44-161-343-7030

HONG KONG:

NATIONAL TRADING LTD.
 TEL: 852-2301-3800
 FAX: 852-2739-1182

JAPAN:

B & B BATTERY(JAPAN) CO., LTD.
 TEL: 81-426-256-537
 FAX: 81-426-256-537

TAIWAN:

B & B BATTERY CO., LTD.
 TEL: 886-6-5898081-3
 FAX: 886-6-5898087



MH19884

